



Project: \_\_\_\_\_

Fixture Type: \_\_\_\_\_

Location: \_\_\_\_\_

Contact/Phone: \_\_\_\_\_

# TRAC-LITES FLARED STEP SERIES

## R550, R551 and R552

### PRODUCT DESCRIPTION

**Construction** Drawn steel housing.

**Socket** Medium base porcelain socket with nickel plated copper screw shell.

**Aiming** 90° vertical aiming capability and 358° rotation.

**Adapter** Copper alloy contacts provide precise spring action • True, positive electrical ground • On/off switch included • Patented embossed polarity arrows on bottom of adapter • Spring-loaded locking latch with embossed polarity arrows secures trac light to trac • Compatible with both Trac-Lites and Trac-Master Trac • "Pull-up" contact to up position for use on Trac-Master two-circuit trac.

**Labels** UL/CUL listed.

Product specifications subject to change without notice.



### Line Voltage PAR20

Catalog Number	Finish	Lamp
R551WH	White	50W PAR20
R551BL	Black	50W PAR20
R551SC	Satin Chrome	50W PAR20

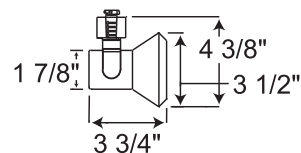

### Line Voltage PAR30

Catalog Number	Finish	Lamp
R552WH	White	75W PAR30
R552BL	Black	75W PAR30
R552SC	Satin Chrome	75W PAR30

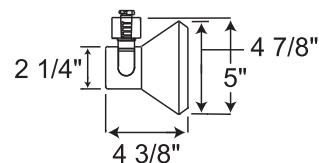

### Line Voltage PAR38

Catalog Number	Finish	Lamp
R550WH	White	120W PAR38
R550BL	Black	120W PAR38
R550BZ	Painted Bronze	120W PAR38
R550SC	Satin Chrome	120W PAR38

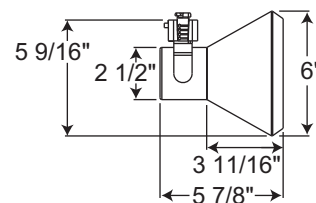

THIS SIDE INTENTIONALLY LEFT BLANK



1300 S. Wolf Road • Des Plaines, IL 60018 • Phone (847) 827-9880 • Fax (847) 827-2925  
220 Chrysler Drive • Brampton, Ontario • Canada L6S 6B6 • Phone (905) 792-7335 • Fax (905) 792-0064  
Visit us at [www.junolightinggroup.com](http://www.junolightinggroup.com)

Printed in U.S.A. ©2012 Juno Lighting, LLC.