

CAST IRON SCREW VALVE BOX EXTENSION

Product Features

All valve boxes and related parts shall be coated on all surfaces with an asphaltic varnish of 2mm in thickness.

Model Numbers

		Height Increase	A	B	C
IVBEXT58	Screw Cast Iron Valve Extension	14"	--	6"	18"
IVBEXT59	Screw Cast Iron Valve Extension	18"	--	6"	24"
IVBEXT60	Screw Cast Iron Valve Extension	24"	24"	--	30"

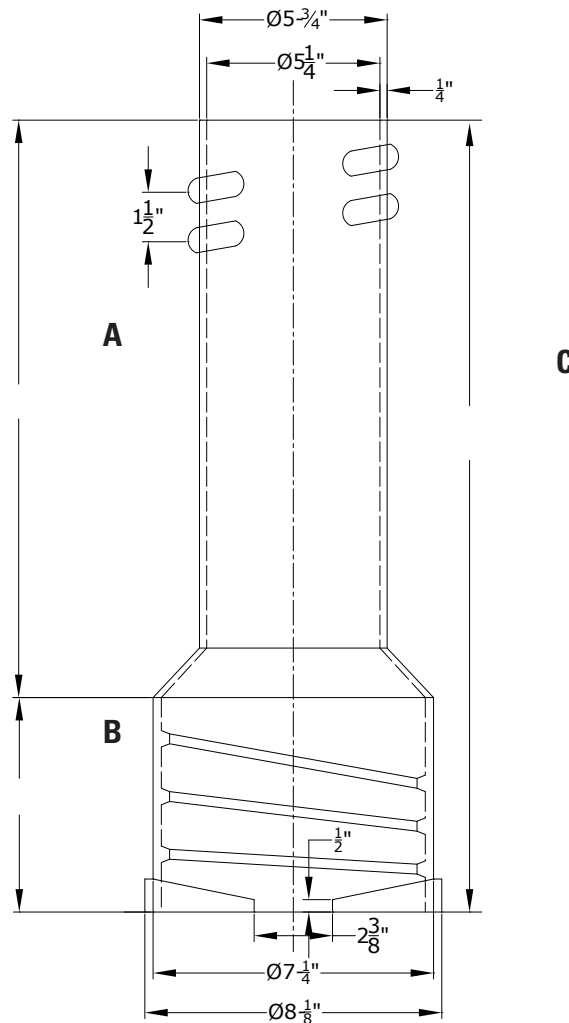

Codes & Approvals

Valve boxes conform to ASTM A-48, Grade 30B; Asphaltic varnish conforms to AWWA C-104.