

ZIP FLANGE ZF2/ZF4 SET SCREW ADAPTER FOR DUCTILE IRON OR STEEL PIPE TO FLANGE FITTING, PUMP, VALVE

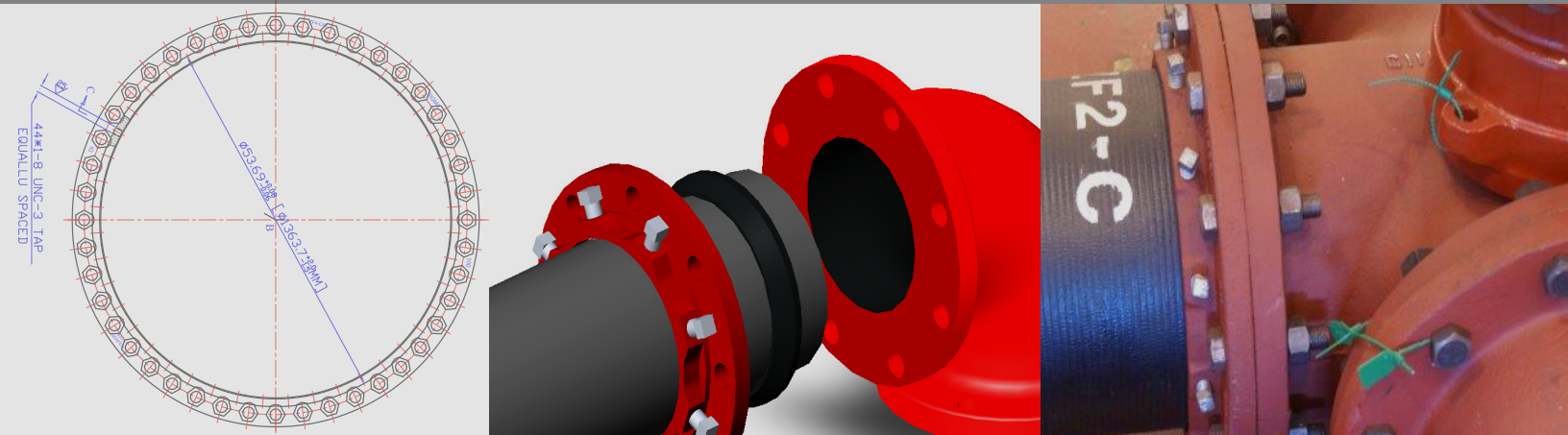

PRODUCT SPECIFICATIONS

- MATERIAL:**
- Adapter flange sleeve is manufactured of high strength ductile iron in accordance with ASTM A536, Grade 65-45-12.
 - Gasket is manufactured of SBR and alternative materials like EPDM, NBR, and CR are available upon request.
 - Set screws are manufactured from AISI 4140 steel, heat-treated and zinc-plated.
- SIZE RANGE:**
- 2" through 48"
- DIMENSION:**
- Manufactured in accordance with ANSI/AWWA C110/A21.10 and ASME B16.1 standards.
- PRESSURE RATINGS:**
- 200 psi on sizes 2"-8", 175 psi on 10"-12", 150 psi on 14"-24" and 100 psi on 30"-48".
- COATING:**
- Red Alkyd paint
- TRACEABILITY:**
- Adapter flange is individually cast with exact heat code information.
- INSTALLATION:**
- In accordance with manufacturer's recommendation and applicable AWWA/ANSI standards.

Note: This product is not designed to be used on plain end fittings.