

Product Certification



This is to certify that all Plastic Pipe and Fittings manufactured by Charlotte Pipe and Foundry Company are manufactured in the United States and conform to the following standards:

PVC SCH. 40 SOLID WALL PIPE

ASTM D 1784, ASTM D 1785, ASTM D 2665
FHA UM 79a
FEDERAL SPECIFICATION L-P-320a
NSF STANDARD 14 AND 61

PVC SCH. 40 DWV CELLULAR CORE PIPE

ASTM D 4396, ASTM F 891
NSF STANDARD NO. 14

PVC SCH. 40 DWV FITTINGS

ASTM D 1784, ASTM D 2665, ASTM D 3311,
ASTM F1866
FHA UM 79a
FEDERAL SPECIFICATION L-P-320a
NSF STANDARD NO. 14

ConnecTite® PUSH-FIT DWV FITTINGS

ASME A112.4.4, IAPMO IGC 334
NSF STANDARD NO. 14

PVC SDR-21 AND SDR-26 PRESSURE PIPE

ASTM D 1784, ASTM D 2241
NSF STANDARD NO. 14 AND 61

PVC SCH. 40 PRESSURE FITTINGS

ASTM D 1784, ASTM D 2466
NSF STANDARD 14 AND 61

PVC SCH. 40 WELL CASING PIPE

ASTM D 1784, ASTM F 480
NSF STANDARD NO. 14 AND 61

PVC SCH. 80 PIPE

ASTM D 1784, ASTM D 1785
NSF STANDARD NO. 14 AND 61

PVC SCH. 80 FITTINGS

ASTM D 1784, ASTM D 2467
ASTM D 2464 ASTM F 1970
NSF STANDARD NO. 14 AND 61

PVC SDR 35 SEWER MAIN PIPE

ASTM D 1784, ASTM D 3034, SDR 35
ASTM D 3212, ASTM F 477

PVC SEWER AND DRAIN PIPE

ASTM D 1784, ASTM D 2729

PVC THIN WALL PIPE & FITTINGS

ASTM D 1784, ASTM D 2949
NSF STANDARD NO. 14

CPVC FLOWGUARD GOLD® CTS PIPE & FITTINGS

ASTM D 1784, ASTM D 2846
FHA UM-61a
NSF STANDARD NO. 14 AND 61
CSA LISTED ON SPECIFIED ITEMS

CPVC CHEMDRAIN® SCH. 40 PIPE & FITTINGS

ASTM D 1784, ASTM F 2618
NSF STANDARD 14

ABS SCH. 40 DWV CELLULAR CORE PIPE

ASTM D 3965, ASTM F 628
NSF STANDARD NO. 14

ABS PLUS® SCH. 40 DWV CELLULAR CORE PIPE

ASTM D 3965, ASTM D 4396, ASTM F 1488

ABS SCH. 40 DWV FITTINGS

ASTM D 3965, ASTM D 2661, ASTM D 3311
FHA UM 79a
FEDERAL SPECIFICATION L-P-322b
NSF STANDARD NO. 14

CHARLOTTE PIPE AND FOUNDRY COMPANY

Physical Properties of Charlotte Pipe® ABS and PVC Materials*

PROPERTY	UNITS	ABS	ASTM NO.	PVC	ASTM NO.
Specific Gravity	g/cc	1.05	D 792	1.40	D 792
Tensile Strength (73°F) Minimum	Psi	4,500	D 638	7,000	D 638
Modulus of Elasticity in Tension (73°F) Minimum	Psi	240,000	D 638	400,000	D 638
Flexural Strength (73°F)	Psi	10,585	D 790	14,000	D 790
Izod Impact (notched at 73°F) Minimum	ft lb/ in. of notch	6.00	D 256	0.65	D 256
Hardness (Durometer D)		70	D 2240	80 ± 3	D 2240
Hardness (Rockwell R)		100	D 785	110 - 120	D 785
Compressive Strength (73°F)	Psi	7,000	D 695	9,600	D 695
Hydrostatic Design Stress	Psi	N/A		2,000	D 1598
Coefficient of Linear Expansion	in./ in./ °F	5.5 x 10 ⁻⁵	D 696	3.0 x 10 ⁻⁵	D 696
Heat Distortion Temperature at 264 psi Minimum	degrees F	180	D 648	158	D 648
Coefficient of Thermal Conductivity	BTU/ hr/sq ft/ °F/ in.	1.1	C 177	1.2	C 177
Specific Heat	BTU/ °F/lb	0.35	D 2766	0.25	D 2766
Water Absorption (24 hrs at 73°F)	% weight gain	0.40	D 570	.05	D 570
Cell Classification - Pipe		42222	D 3965	12454	D 1784
Cell Classification - Fittings		32222	D 3965	12454	D 1784
Burning Rate				Self Ext.	D 635

*Above data is based upon information provided by the raw material manufacturers. It should be used only as a recommendation and not as a guarantee of performance.

PART NO. 104W

Trap Adapter—Female, with Washer & PVC Nut

DWV HUB X TUBULAR SLIP WITH PVC NUT	
SIZE	A
1 1/4 (ABS)	3/16
1 1/2 x 1 1/4	5/16
1 1/2	3/16
2 (PVC)	9/64

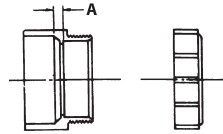

PART NO. 104X

Trap Adapter—Female, with Washer & Chrome Nut

DWV HUB X TUBULAR SLIP	
SIZE	A
1 1/4 (PVC)	3/16
1 1/2 x 1 1/4 (PVC)	5/16
1 1/2	3/16
2	9/64

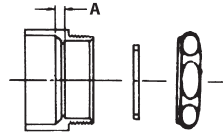

PART NO. 105

Fitting Cleanout Adapter

SPIGOT X FPT		
SIZE	A	B
1 1/4 (PVC)	3/16	3/4
1 1/2 (PVC)	5/32	5/8
1 1/2 (ABS)	3/16	23/32
2 (PVC)	5/32	5/8
2 (ABS)	1/16	27/32
3 (PVC)	7/32	3/4
3 (ABS)	7/32	19/32
4 (PVC)	1/4	7/8
4 (ABS)	7/32	19/32
6 (PVC)	5/16	1 1/16
8 (PVC)	3/8	1 1/2
10 ^(F) (PVC)	15/16	2 1/4
12 ^(F) (PVC)	1 1/8	2 7/16

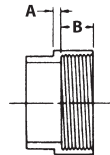

PART NO. 105X

Fitting Cleanout Adapter with Cleanout Plug

SPIGOT X FPT	
SIZE	A

For dimensions see part numbers 105 and 106.

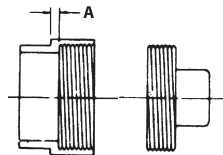

PART NO. 106

Cleanout Plug

MPT		
SIZE	A	B
1 1/2	1 3/8	5/8
2	1 3/8	5/8
2 1/2 (ABS)	1 1/2	3/4
3	1 3/4	3/4
4	1 7/8	7/8
6 (PVC)	2	1
6 (ABS)	1 7/8	31/32
8 (PVC)	2 3/8	1 3/8
10 (PVC)	2 7/16	1 7/16
12 (PVC)	2 17/32	1 17/32

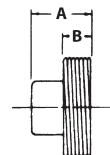

PART NO. 107

Flush Bushing

SPIGOT X HUB	
SIZE	C
1 1/2 x 1 1/4	3/16
2 x 1 1/4	5/16
2 x 1 1/2 (PVC)	5/16
2 x 1 1/2 (ABS)	1/8
3 x 1 1/2 (PVC)	1
3 x 1 1/2 (ABS)	25/32
3 x 2 (PVC)	7/8
3 x 2 (ABS)	23/32
4 x 2 (PVC)	1 1/8
4 x 2 (ABS)	1 3/16
4 x 3 (PVC)	1/2
4 x 3 (ABS)	1/4
6 x 4 (PVC)	1 3/4
6 x 4 (ABS)	1 21/32
8 x 4 (PVC)	2 7/8
8 x 6 (PVC)	1 5/8
10 x 4** (PVC)	4 7/16
10 x 6** (PVC)	3 5/32
10 x 8 (PVC)	1 1/2
12 x 4** (PVC)	5 5/32
12 x 6** (PVC)	4 5/32
12 x 8 (PVC)	2 1/2
12 x 10 (PVC)	1 1/2

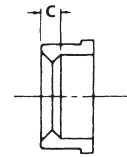

PART NO. PVC 107

Concentric Reducer Bushing

SPIGOT X HUB	
SIZE	C
14 x 4 ^(F) (PVC)	8
14 x 6 ^(F) (PVC)	8 ^{63/64}
14 x 8 ^(F) (PVC)	9 7/16
14 x 10 ^(F) (PVC)	9 5/8
14 x 12 ^(F) (PVC)	7 3/8
16 x 4 ^(F) (PVC)	8 3/4
16 x 6 ^(F) (PVC)	9 1/4
16 x 8 ^(F) (PVC)	10 1/4
16 x 10 ^(F) (PVC)	10 7/8
16 x 12 ^(F) (PVC)	10 5/8
16 x 14 ^(F) (PVC)	9 1/4

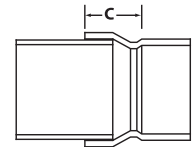

PART NO. 108

Flush Bushing (Cleanout Adapter)

SPIGOT X FPT	
SIZE	C
2 x 1 1/2	5/16
8 x 6 ^(CP) (PVC)	1 5/8
10 x 8 (PVC)	1 1/2
12 x 8 (PVC)	1 13/16

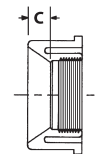

^(F) Fabricated

** Assembled from two molded components

^(CP) PVC 108, 8"x6" is available only as a component part of PVC 444X.

Note: If PVC or ABS is not listed for a specific size, that size fitting is available in PVC and ABS materials, and the dimensions listed are the same for both materials.