

## Fig. CT-121

### Copper Tubing Riser Clamp

**Size Range:** 1/2" through 4"

**Material:** Carbon steel

**Finish:**  Copper plated, also available in  yellow dichromate.

**Service:** Recommended for support and steadying of copper tube risers, either insulated or non-insulated. This product is not intended for use with hanger rods.

**Approvals:** Complies with Federal Specification A-A-1192A (Type 8) *WW-H-171-E (Type 8)*, ANSI/MSS SP-69 and MSS SP-58 (Type 8).

**Service:** For support and steadying of copper tubing risers.

**Installation:** Clamp is fitted and bolted preferably below a coupling or fitting on the tubing. Do not over tighten bolts.

**Features:** Rounded ears provide greater safety for personnel.

**Ordering:** Specify tube size, figure number, name.

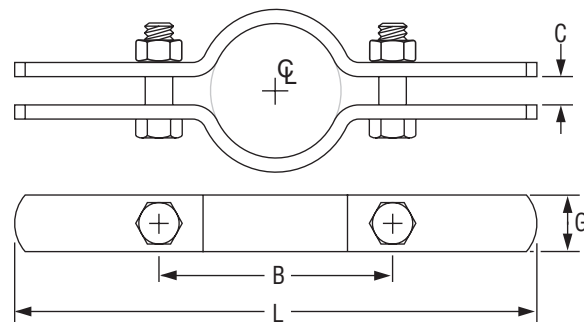

**FIG. CT-121: LOADS (LBS) • WEIGHT (LBS) • DIMENSIONS (IN) • TORQUE (FT-LBS)**

Tube Size	Max Load	Weight	L	Stock Width	Bolt Size	Torque Values
1/2	75	0.52	6 1/2	1	5/16	11
3/4		0.56	7			
1	120	0.94	9 3/8	1 1/4	3/8	21
1 1/4		0.98	9 5/8			
1 1/2		1.50	10			
2	150	1.50	10 3/8	1 1/2	1/2	46
2 1/2		1.70	11 13/16			
3		1.80	11 1/2			
3 1/2		1.90	12			
4	300	2.60	13			

Note: Minimum loads per MSS SP only applicable to 1 1/4" and up.

#### PROJECT INFORMATION

#### APPROVAL STAMP

<b>Project:</b>	<input type="checkbox"/> Approved
<b>Address:</b>	<input type="checkbox"/> Approved as noted
<b>Contractor:</b>	<input type="checkbox"/> Not approved
<b>Engineer:</b>	<b>Remarks:</b>
<b>Submittal Date:</b>	
<b>Notes 1:</b>	
<b>Notes 2:</b>	