



**Dearborn®
Brass**

4675 W. 160th St.
Cleveland, Ohio 44135
Ph: (800) 321-9532
Fax: (800) 321-9535
www.dearbornbrass.com

SUBMITTAL SPECIFICATION

**BRASS TUBULAR
1-½" WALL TUBES**

Engineering Specification: Dearborn Brass 1-½" Brass Tubular Wall Tubes are designed for use in tubular drain applications. Available in 17 or Budget Gauge Brass.

Job Reference

DESCRIPTION

- Chrome Plated
- Wall Tubes
 - Quarter Bend Tube

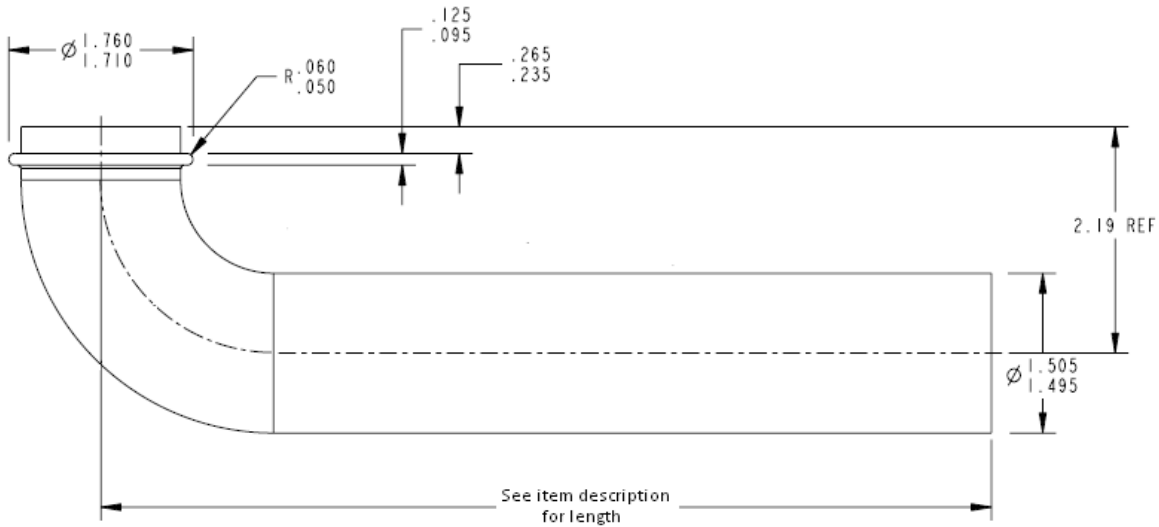
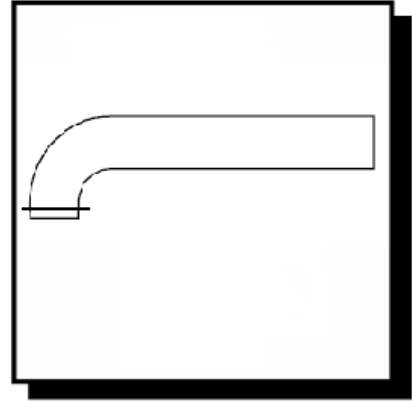

✓	Product No.	Description	Carton Quantity	Carton Weight (lbs)
	H2402-1	1-½" Wall Tube – 7-½" Length – Budget Gauge	10	3
	2402A-1	1-½" Wall Tube – 11-½" Length – Budget Gauge	10	4
	402-17-1	1-½" Wall Tube – 8-¼" Length – 17 Gauge	10	6
	402A-17-1	1-½" Wall Tube – 11-¼" Length – 17 Gauge	10	8
	402B-17-1	1-½" Wall Tube – 15" Length – 17 Gauge	10	11
	H402B-17-3	1-½" Wall Tube – 15" Length – 17 Gauge – Unfinished	6	5
	402C-17-1	1-½" Wall Tube – 21" Length – 17 Gauge	25	37
	402D-17-1	1-½" Wall Tube – 33" Length – 17 Gauge	25	54
	402E-17-1	1-½" Wall Tube – 45" Length – 17 Gauge	20	57
	402F-17-1	1-½" Wall Tube – 57" Length – 17 Gauge	20	71

Data is subject to manufacturing tolerances.