

## Adjustable Swivel Ring Fig. CT-69

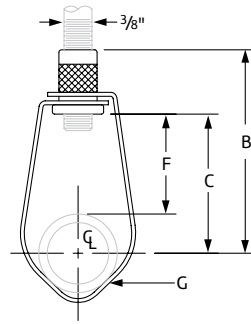

1/2" through 1 1/4" pipe

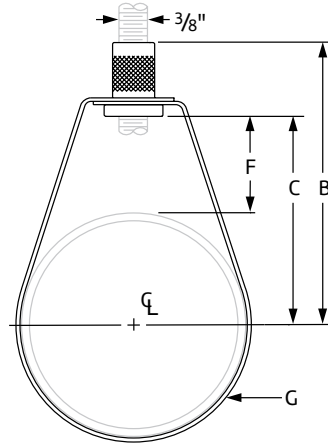

1 1/2" through 4" pipe

**Size Range:** 1/2" through 4"

**Material:** Carbon steel

**Finish:** Copper plated

**Service:** Recommended for suspension of non-insulated **stationary** copper tube.

**Approvals:** Complies with Federal Specification A-A-1192A (Type 10) WW-H-171-E (Type 10), ANSI/MSS SP-69 and MSS SP-58 (Type 10).

**Features:**

- Threads are countersunk so that they cannot become burred or damaged.
- Knurled swivel nut provides vertical adjustment after piping is in place.
- Captured swivel nut will not fall off.

**Ordering:** Specify nominal tube size, figure number, name and finish.

**Note:** Metric nut available upon request.



**Fig. CT-69: Dimensions (in) • Loads (lbs) • Weight (lbs)**

Tube Size	Max Load	Weight	B	C	F	G Width
1/2	300	0.10	3	2 <sup>3</sup> / <sub>16</sub>	1 <sup>7</sup> / <sub>8</sub>	5/8
3/4		0.10	2 <sup>13</sup> / <sub>16</sub>	2	1 <sup>9</sup> / <sub>16</sub>	
1		0.10	2 <sup>11</sup> / <sub>16</sub>	1 <sup>13</sup> / <sub>16</sub>	1 <sup>1</sup> / <sub>4</sub>	
1 1/4		0.10	2 <sup>1</sup> / <sub>2</sub>	1 <sup>5</sup> / <sub>8</sub>	1 <sup>15</sup> / <sub>16</sub>	
1 1/2		0.10	2 <sup>11</sup> / <sub>16</sub>	1 <sup>13</sup> / <sub>16</sub>	1	
2	525	0.11	3 <sup>7</sup> / <sub>16</sub>	2 <sup>1</sup> / <sub>2</sub>	1 <sup>1</sup> / <sub>2</sub>	3/4
2 1/2		0.25	3 <sup>13</sup> / <sub>16</sub>	2 <sup>15</sup> / <sub>16</sub>	1 <sup>11</sup> / <sub>16</sub>	
3		0.27	4 <sup>1</sup> / <sub>4</sub>	3 <sup>3</sup> / <sub>8</sub>	1 <sup>7</sup> / <sub>8</sub>	
4		0.48	4 <sup>3</sup> / <sub>8</sub>	3 <sup>1</sup> / <sub>2</sub>	1 <sup>1</sup> / <sub>2</sub>	

**Note:** Reflects changes in rod diameter from previously published data per recent revisions in MSS-SP-58 & 69.

PROJECT INFORMATION	APPROVAL STAMP
Project:	Approved
Address:	Approved as noted
Contractor:	Not approved
Engineer:	Remarks:
Submittal Date:	
Notes 1:	
Notes 2:	