

Class 125 (Standard)

FIG. 3360R

Reducing Cross

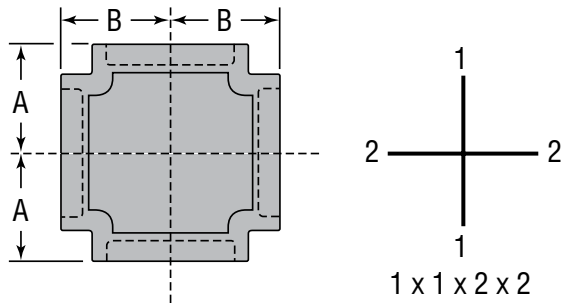

For Listings/Approval Details and Limitations, visit our website at www.anvilintl.com or contact an Anvil® Sales Representative.

FIGURE 3360R - REDUCING CROSS

Nominal Size 1 x 1 x 2 x 2	Max. Working Pressure▲ PSI (kPa)	Dimensions		Approx. Wt. Each Lbs. (kg)
		A In. (mm)	B In. (mm)	
1¼ x 1¼ x 1 x 1 32 x 32 x 25 x 25	300 2065	1.58 40.13	1.67 42.41	2.05 0.93
1½ x 1½ x 1 x 1 40 x 40 x 25 x 25	300 2065	1.65 41.91	1.80 45.72	2.40 1.09
2 x 2 x 1 x 1 50 x 50 x 25 x 25	300 2065	1.73 38.60	2.02 44.45	2.75 1.25

▲ – Working Pressure Ratings are for reference only and based on Sch. 40 pipe. For the latest UL/ULC, and FM pressure ratings versus pipe schedule, please visit anvilintl.com or contact your local Anvil Representative.

MATERIAL SPECIFICATIONS

Dimensions: ASME B16.4 Class 125

Material: ASTM A126

Finish: Black or Hot Dip Galvanized per ASTM A153 Class A

Threads: NPT per ASME B1.20.1

Agency Approvals: All cast iron threaded fittings are UL/ULC Listed and FM Approved.

PROJECT INFORMATION

APPROVAL STAMP

Project:	<input type="checkbox"/> Approved
Address:	<input type="checkbox"/> Approved as noted
Contractor:	<input type="checkbox"/> Not approved
Engineer:	Remarks:
Submittal Date:	
Notes 1:	
Notes 2:	