

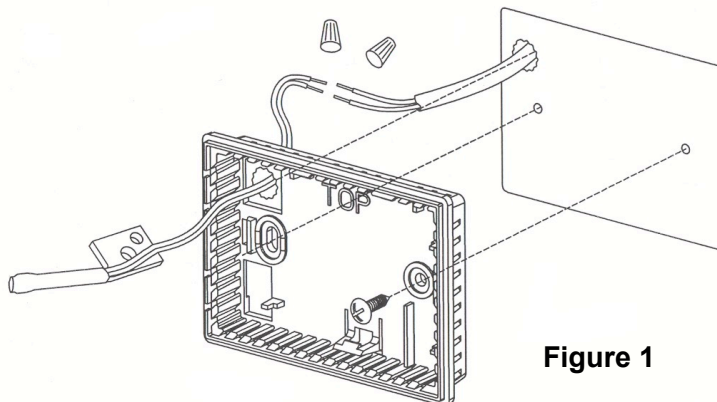

MODEL 8053 Surface Mount Sensor Installation Instructions

INSTALLATION PROCEDURE

1. Mark location for wire entry hole and enclosure mounting holes (See **Figure 1**)
2. Drill holes – minimize the size of the wire entry hold to prevent drafts.
3. Feed the sensor wire through square wire hole in sensor enclosure (See **Figure 1**)



4. Connect the sensor wires to the wire that is connected to the thermostat using the supplied wire nuts.
5. Push excess wire and wire nuts into the wall cavity.

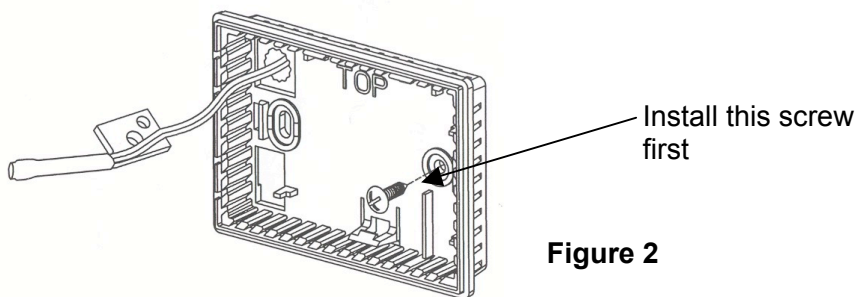

6. First, install one of the supplied screws in the round enclosure hole (See **Figure 2**).

7. Position the sensor bracket with the small hole located over the remaining mounting hole. Wire side of sensor should be facing up. (See **Figure 3**).

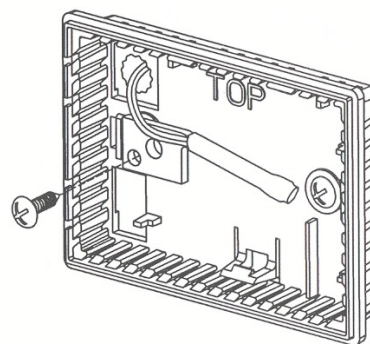

8. Install the supplied screw through bracket, enclosure, then into the wall. (See **Figure 3**)

Note: If the tip of the sensor is resting on the enclosure, bend up the sensor so it is 1/4" to 1/2" off the enclosure.

9. Install the enclosure cover to finish the installation.