

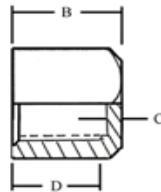

MANUFACTURERS OF PIPE FITTINGS

STEEL HEX & ROUND CAPS



NOMINAL PIPE SIZE	A - SIZE OF BAR STOCK	B - LENGTH OF CAP, MIN.	C - METAL THICKNESS, MIN.	D - THREAD LENGTH, MIN.
1/8	9/16	0.530	0.090	0.250
1/4	11/16	0.630	0.100	0.320
3/8	13/16	0.740	0.120	0.360
1/2	1	0.870	0.130	0.430
3/4	1 - 3/16	0.970	0.130	0.500
1"	1 - 1/2	1.160	0.140	0.580
1 - 1/4	2	1.280	0.150	0.670
1 - 1/2	2 - 1/4	1.350	0.190	0.700
2"	2 - 5/8	1.450	0.220	0.750
2 - 1/2 *	3 - 1/2	1.700	0.250	1.138
3" *	4"	1.800	0.290	1.200

Notes: 1/8 - 2" threads are Dry Seal (NPTF) 3/4 taper per foot.

* 2 - 1/2 & 3" threads 8 - NPT, 3/4 taper per foot.

Available in Black Steel, Zinc (galvanized) Plated, Lead Free Brass (Hex Only)

ROHS, REACH, and WEE Complaint

Manufactured in the U.S.A.

MADE IN U.S.A.

Billco Corporation

770 W. Belden Ave. Addison, IL 60101

Ph: (630) 543- 4777

www.billcocorp.com