

**Straight Coupling Dimensions**

P/N	A	B
U004LF	1/4"	1.59"
U006LF	3/8"	1.84"
U008LF	1/2"	2"
U016LF	3/4"	2.36"
U020LF	1"	2.72"

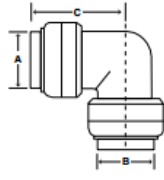

**Elbow Dimensions**

P/N	A	B	C
U244LF	1/4"	1/4"	1.160"
U276LF	1/4"	3/8" MIP	1.160"
U246LF	3/8"	3/8"	1.280"
U272LF	1/2"	3/8"	1.430"
U248LF	1/2"	1/2"	1.360"
U256LF	3/4"	3/4"	1.640"
U260LF	1"	1"	1.933"
U274LF	3/4"	1/2"	1.373"
U280LF	1/2"	1/2" MNPT	1.210"
U308LF	1/2"	1/2" FNPT	1.210"

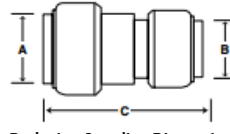

**Reducing Coupling Dimensions**

P/N	A	B	C
U009LF	3/8"	1/2"	2.00"
U058LF	3/4"	1/2"	2.20"
U060LF	1"	3/4"	2.51"

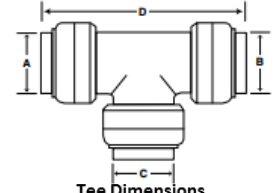

**Tee Dimensions**

P/N	A	B	C	D
U358LF	1/4"	1/4"	1/4"	2.30"
U360LF	3/8"	3/8"	3/8"	2.77"
U362LF	1/2"	1/2"	1/2"	2.72"
U363LF	1/2"	1/2"	3/8"	2.85"
U364LF	3/8"	3/8"	1/2"	2.77"
U370LF	3/4"	3/4"	3/4"	3.24"
U374LF	1"	1"	1"	3.84"
U412LF	3/4"	3/4"	1/2"	3.04"
U416LF	1"	1"	3/4"	3.63"
U444LF	3/4"	1/2"	3/4"	3.08"
U454LF	3/4"	1/2"	1/2"	2.92"

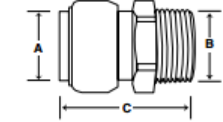
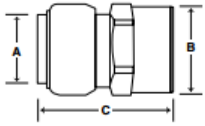

**Connector Dimensions**

P/N	A	B	C
U066LF	1/4"	1/2" FNPT	1.61"
U068LF	1/2"	3/4" FNPT	1.75"
U070LF	3/8"	1/2" FNPT	1.73"
U072LF	1/2"	1/2" FNPT	1.64"
U092LF	3/4"	1/2" FNPT	1.83"
U088LF	3/4"	3/4" FNPT	1.88"
U094LF	1"	1" FNPT	2.17"
U110LF	1/4"	1/2" MNPT	1.64"
U118LF	3/8"	1/2" MNPT	1.77"
U120LF	1/2"	1/2" MNPT	1.64"
U116LF	1/2"	3/4" MNPT	1.75"
U134LF	3/4"	3/4" MNPT	1.89"
U138LF	3/4"	1/2" MNPT	1.90"
U140LF	1"	1" MNPT	2.48"
U142LF	1"	3/4" MNPT	2.11"

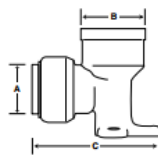

**Drop Ear Elbow Dimensions**

P/N	A	B	C
U249LF	1/2"	1/2"	2.20"
U332LF	3/8"	1/2" FNPT	1.83"
U334LF	1/2"	1/2" FNPT	1.77"
U335LF*	1/2"	1/2" FNPT	2.00"
U340LF	3/4"	3/4" FNPT	2.50"

\*Hy-Ear Elbow

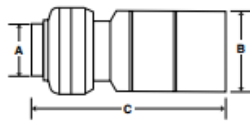

**Fitting Reducer Dimensions**

P/N	A	B	C
U719LF	3/8"	1/2"	2.08"
U721LF	3/8"	3/4"	2.27"
U722LF	1/2"	1"	3"
U724LF	3/4"	1"	2.25"

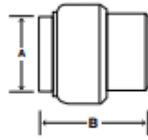

**End Stops Dimensions**

P/N	A	B
U512LF	3/8"	1.11"
U514LF	1/2"	1.08"
U518LF	3/4"	1.32"
U520LF	1"	1.52"

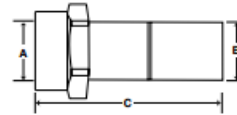

**Fitting Adapter Dimensions**

P/N	A	B	C
U766LF	3/4" FNPT	3/4"	2.83"
U772LF	1" FNPT	1"	2.83"

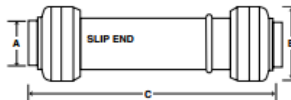

**Slip Coupling\* Dimensions**

P/N	A	B	C
U3008LF	1/2"	1.075"	4.46"
U3016LF	3/4"	1.355"	4.42"
U3020LF	1"	1.640"	4.5"

\*For use with copper & CPVC only

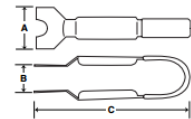

**Disconnect Clips Dimensions**

P/N	Fits SharkBite	A	B	C
U711	1/2"	1.7"	2"	6.5"
U713	3/4"	1.7"	2"	6.5"
U715	1"	1.7"	2"	6.5"

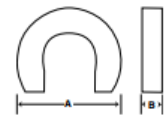

**Disconnect Clip Dimensions**

P/N	Size	A	B
U706	1/4"	1.19"	0.3"
U708	3/8"	1.22"	0.3"
U710	1/2"	1.22"	0.3"
U712	3/4"	1.72"	0.4"
U714	1"	2"	0.4"

Note: Disconnect Clips sold separately

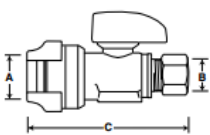

**Straight Stop (Chrome Plated) Dimensions**

P/N	A	B	C
23037-0000LF	1/2"	3/8" Compression	2.68"

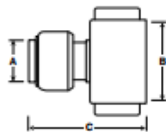

**Ballcock Connector Dimensions (Chrome Plated)**

P/N	A	B	C
U3531LF	1/4"	7/8" Ballcock	1.58"

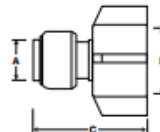

**Faucet Connector Dimensions (Chrome Plated)**

P/N	A	B	C
U3525LF	1/4"	1/2" NPS	1.58"

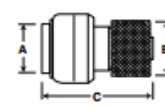

**Stop Connector Dimensions (Chrome Plated)**

P/N	A	B	C
U3523LF	1/4"	1/2" NPS	1.58"

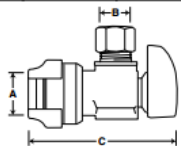

**Angle Stop (Chrome Plated) Dimensions**

P/N	A	B	C
23036-0000LF	1/2"	3/8" Compression	2.58"

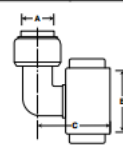

**Ballcock Elbow (Chrome Plated) Dimensions**

P/N	A	B	C
U3537LF	1/4"	7/8" Ballcock	1.05"

