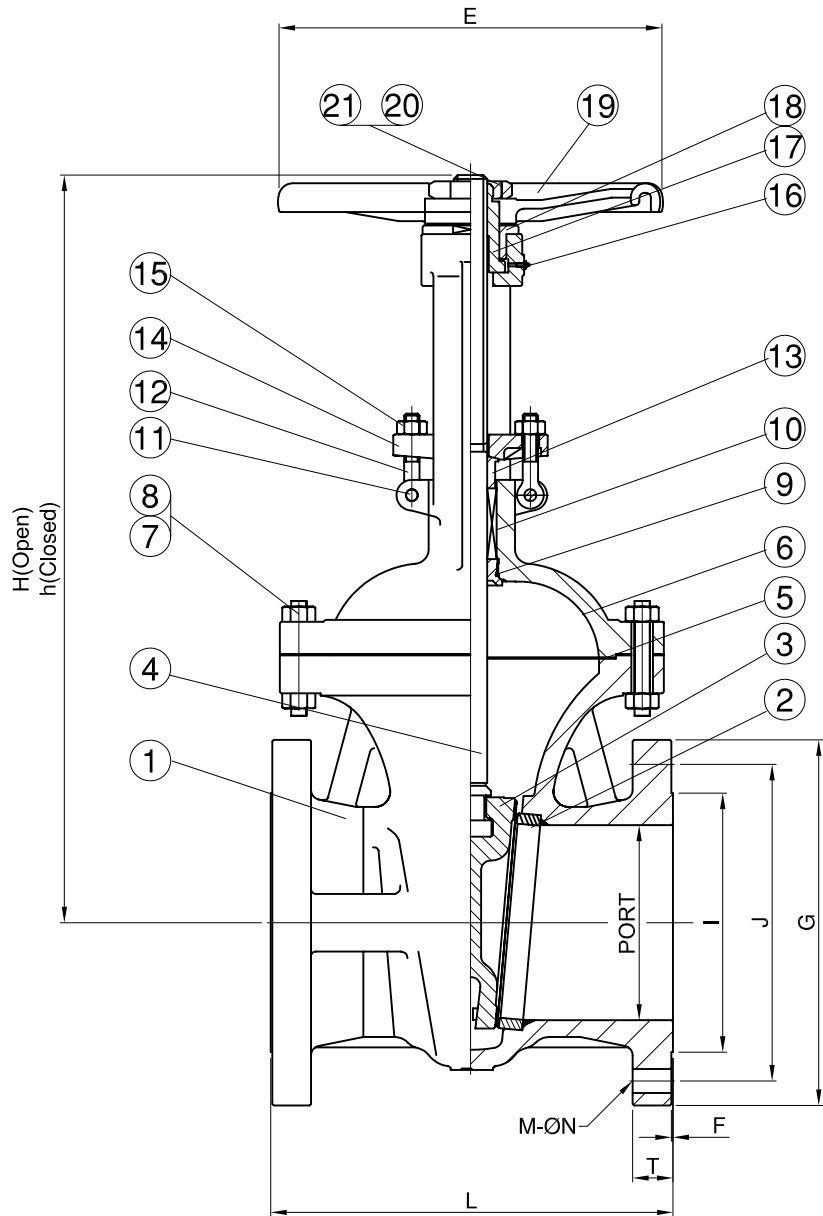

Fig No:

#552



MATERIAL LIST

ITEM	PART NAME	MATERIAL
1	Body	ASTM A216 GR.WCB
2	Seat Ring	ASTM A105+ HF Faced
3	Disc	ASTM A216 GR.WCB+13%Cr Faced
4	Stem	ASTM A182 F6
5	Gasket	Soft Iron+Graphite
6	Bonnet	ASTM A216 GR.WCB
7	Stud Bolt Nuts	ASTM A194 GR.2H
8	Bonnet Stud Bolts	ASTM A193 GR.B7
9	Bonnet Bushing	ASTM A276 Type 410
10	Packing	Braided Graphite & Die formed Graphite Ring
11	Eye Bolt Pins	Carbon Steel
12	Gland Eye Bolts	ASTM A193 GR.B7
13	Gland	ASTM A276 Type 410
14	Gland Flange	ASTM A216 GR.WCB
15	Eye Bolt Nuts	ASTM A194 GR.2H
16	Grease Nipple	Carbon Steel
17	Yoke Sleeve	ASTM A439 GR.D-2
18	Retaining Nut	Carbon Steel
19	Handwheel	Malleable Iron
20	Screw	Carbon Steel
21	Handwheel Nut	Carbon Steel

DIMENSIONS

unit: inch

SIZE	PORT	L	E	H	G	J	I	T	F	M	ØN
2"	1.969	8.504	7.874	16.614	6.500	5.000	3.620	0.880	0.060	8	0.750
2-1/2"	2.559	9.488	7.874	20.157	7.500	5.880	4.120	1.000	0.060	8	0.880
3"	3.150	11.142	9.843	20.551	8.250	6.620	5.000	1.120	0.060	8	0.880
4"	3.937	12.008	11.811	24.213	10.000	7.880	6.190	1.250	0.060	8	0.880
5"	5.906	15.866	13.780	29.882	11.000	9.250	7.310	1.380	0.060	8	0.880
6"	5.906	15.866	13.780	31.654	12.500	10.620	8.500	1.440	0.060	12	0.880
8"	7.874	16.496	15.748	39.449	15.000	13.000	10.620	1.620	0.060	12	1.000
10"	9.843	17.992	17.717	48.386	17.500	15.250	12.750	1.880	0.060	16	1.120
12"	11.811	19.764	19.685	59.528	20.500	17.750	15.000	2.000	0.060	16	1.250

	APPROVED BY.	CHECK BY.	DRAWN BY.	DRAWINGNO.	MATERIAL	UNIT	DESCRIPTION
SIGN				#552-D		INCH	2"~12" CARBON STEEL FLANGED GATE VALVES ANSI CLASS 300
	DATE			REVISION	02 10/29/2004	SCALE	

