

## MJ FIELD LOK Gasket®

Mechanical Joint Fitting Restraint

Forget those heavy lug-type restraints and switch to the MJ FIELD LOK® Gasket. It not only seals, but also provides the joint restraint that typically requires concrete thrust blocks or lug-type restraints outside the joint. That means you'll have fewer installation steps, and faster and easier installations.

Two primary components make up the MJ FIELD LOK Gasket. The first, an elastomeric material, does the sealing. The second, stainless steel locking segments, are the teeth that give MJ FIELD LOK its bite. Embedded in the elastomeric material, they lock in to the pipe and provide joint restraint when the

pipe system is internally pressurized.

There's no learning curve either. Install it just like a standard mechanical joint gasket. The joint is automatically restrained when the MJ FIELD LOK Gland bolts are tightened to the recommended torque.

### FEATURES & BENEFITS

- Proven joint restraint technology
- No Learning Curve - installs just like a standard mechanical joint gasket and gland
- No more need for time-consuming thrust blocks or heavy lug-type restraints
- No loose wedges or torque-off control nuts to get lost or broken
- Can be disassembled just like a standard mechanical joint
- Suitable for potable water and wastewater applications
- The state-of-the-art MJ FIELD LOK Gland is designed for maximum strength and easy product identification
- MJ FIELD LOK Gaskets are provided as part of a kit that also includes the MJ FIELD LOK Gland, nuts and bolts



**PIPE**  
FABRICATION  
RESTRAINED JOINTS <  
FITTINGS  
GASKETS  
COATINGS & LININGS



## MJ FIELD LOK® GASKET

INCH	INCHES		DEGREE	PSI		LBS
SIZE	PIPE OD	ORDER NUMBER	DEFLECTION	PRESSURE RATING	NUMBER OF SEGMENTS	APPROX. KIT WEIGHT
4	4.80	DI 04	5°	350	3	7.3
6	6.90	DI 06	5°	350	4	10.9
8	9.05	DI 08	5°	350	6	13.5
10	11.10	DI 10	3°	350	9	18.5
12	13.20	DI 12	3°	350	13	19.7
16	17.40	DI 16	2°	350	24	31.8

MJ FIELD LOK Gasket - Series DI (4" - 12", 16")

Can be used on any pressure class or Special Thickness Class Ductile Iron pipe up to 350 PSI

Stainless steel locking segments provide proven joint restraint technology

Only available in SBR rubber

## MJ FIELD LOK® GLAND

INCH	LBS	INCH	INCH	INCH	INCH	INCH
SIZE	WEIGHT	A OUTSIDE DIA.	B BOLT HOLE	DIMENSIONS C INSIDE DIA.	D OD LIP	E GLAND HEIGHT
4	3.3	8.88	7.50	4.90	5.92	7.3
6	5.0	10.87	9.50	7.00	8.02	10.9
8	7.2	13.13	11.75	9.15	10.17	13.5
10	10.2	15.38	14.00	11.20	12.22	18.5
12	11.0	17.63	16.25	13.30	14.32	19.7
16	25.0	22.38	21.00	17.54	18.50	31.8

MJ FIELD LOK Gland (4" - 12", 16")

Highly engineered to provide the strength and rigidity necessary for restrained joint applications.

Installs just like a standard mechanical joint gland.

All ductile iron components are manufactured to ASTM A536 Grade 70-50-05.

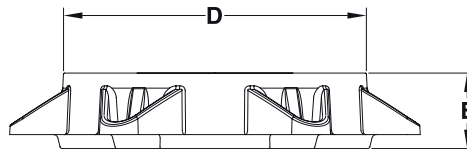
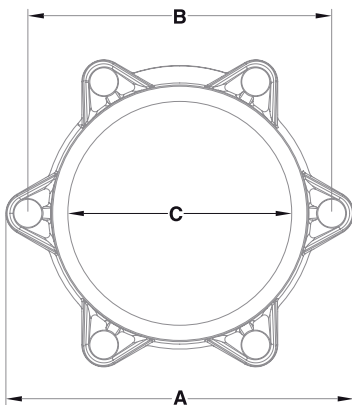

MF FIELD LOK KIT INCLUDES: MF FIELD LOK GASKET, STATE-OF-THE-ART MJ FIELD LOK GLAND, NUTS AND BOLTS.

© 2018 U.S. Pipe. All rights reserved. USP-SS-MJ FIELD LOK Rev. 0418

U.S. Pipe has a policy of continuous product and product data improvement and reserves the right to change design and specifications without notice.

Headquarters

U.S. Pipe  
Two Chase Corporate Dr.,  
Suite 200  
Birmingham, AL 35244

866-347-7473

info@uspipe.com  
www.uspipe.com

A Forterra Company



A Forterra Company