

## Schedule 80 PVC Technical Schedule 80 Tank Adapters



### Tank Adapters (Bulkhead Fittings)

Designed to facilitate connections through tank or bulkhead walls. Available in PVC or CPVC with socket x socket, socket x thread or SR thread, thread x thread or thread x SR thread, and spigot end connections. Plus, special Self-Aligning style.

New Style Tank Adapters are designed with Spears® patented Special Reinforced (SR) Female Plastic threads for improved adapter connection strength, even when transitioned to metal pipe (Patent No. 5,582,439). In addition, these Tank Adapters in sizes through 4" are designed for use with Nut & Body Spanner Wrench Sets (purchased separately) on the outside connection to aid both installation and in make-up of external threaded connections. Pressure rated to 150 psi @ 73°F (23°C).

### Easy Assembly to Tank:

1. Locate and cut designated hole size in tank (see Minimum Hole Size in appropriate chart below).
2. Remove the nut and insert Tank Adapter through hole from inside; leave gasket in place. **Note: Body and Gasket must be installed on the inside of the tank. (except spigot style in which gasket goes on outside of tank).**
3. Tighten Nut clockwise while holding body from inside tank or on outside with use of spanner wrench.

**NOTE:** A sound, leak-tight seal can be made on curved surfaces providing the curve on the surface will allow for full and equal 360° pressure contact of the sealing gasket against the tank wall surface. (Refer to Minimum Tank Radius below).

### Tank Adapters, PVC New Style Standard with Neoprene Gaskets

Socket x Socket

150 psi Maximum Internal Pressure Rating @ 73°F (23°C)

Dimensions Also Applicable to  
8170E-XXX & 8170V-XXX

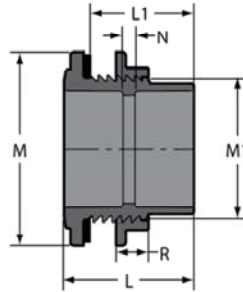

Part Number	Size	L	L1	M	M1	N	R	Min Hole Size	Approx. Wt. (Lbs.)
8170-002	1/4	2-15/32	1-13/16	1-17/32	1-1/32	1- 3/16	1/2	1-1/16	.11
8170-003	3/8	2- 1/2	1-27/32	1-21/32	1-5/32	1	1/2	1-3/16	.12
8170-005	1/2	2-29/32	2- 3/16	2- 1/16	1-7/16	1- 1/8	5/8	1-1/2	.20
8170-007	3/4	2-15/16	2- 3/16	2- 1/4	1- 5/8	29/32	5/8	1-3/4	.23
8170-010	1	3-9/32	2- 9/16	2-21/32	1-31/32	1	5/8	2	.36
8170-012	1-1/4	3-13/32	2- 5/8	3- 1/8	2- 5/16	29/32	5/8	2-3/8	.45
8170-015	1-1/2	3- 5/8	2-13/16	3- 5/8	2-11/16	7/8	5/8	2-3/4	.64
8170-020	2	4- 1/8	3- 1/4	4- 7/8	3- 1/4	1- 1/16	3/4	3-3/8	1.22
8170-025	2-1/2	4-27/32	3-29/32	5- 1/4	3-13/16	1-5/16	1	3-7/8	2.13
8170-030	3	5- 1/2	4- 1/2	6	4-17/32	1-23/32	1	4-5/8	2.50
8170-040	4	4-31/32	3-15/16	7-7/16	5-7/16	7/16	1- 1/4	5-1/2	3.12
8170-060	6	5	4	10-3/32	8	1/8	1-1/4	8	5.59
8170-080	8	8-19/32	6-7/8	12-15/16	10-7/32	1/2	1- 1/2	10-3/8	16.24