



IRON BODY GAS VALVES - PLUG STYLE

10685B FLAT HEAD TAMPERPROOF

Cast iron body, bronze plug manually operated 175 PSIG natural, manufactured, or propane gas valve for use in above ground gas piping systems in ambient temperatures between -20°F to 150°F. Iron body valves considered full port of flow.

- Inlet: FNPT Thread
- Outlet: FNPT Thread
- Sizes: 1/2", 3/4", 1", 1 1/4", 1 1/2", 2"



175 PSIG



~ DIMENSIONS ~					
SIZE	A	B	C	D	E
1/2	2.80	1.40	1.49	2.78	.87
3/4	3.14	1.57	1.66	3.16	1.00
1	3.38	1.69	1.85	3.53	1.12
1 1/4	3.88	1.94	2.28	4.37	1.37
1 1/2	4.62	2.31	2.67	4.99	1.62
2	5.62	2.81	2.96	5.57	1.87

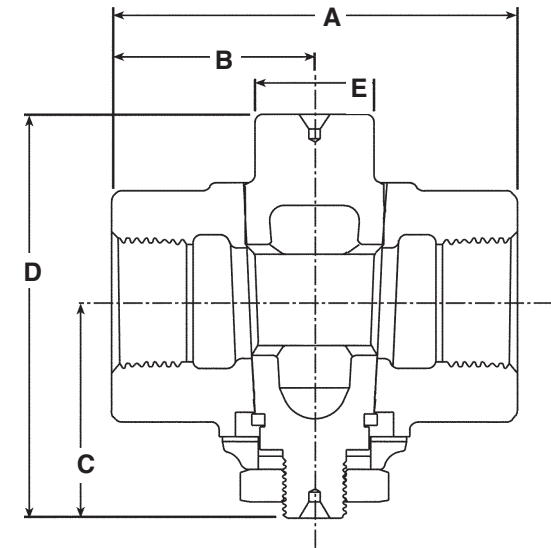

- Iron Body - Less Check
- Bronze Plug
- Relubable Plug

Threads per ANSI/ASME B1.20.1

Manufactured to the guidelines set forth in ASME B16.33.

NOTE: All A.Y. McDonald plug style gas valves are factory set. DO NOT TAMPER WITH BOTTOM NUT.