

SPECIFICATIONS

Product Model Numbers Ironing Centers: A-46

Dimensions (Actual Size)

Overall height: 60 5/8"
Overall width: 15"
Overall depth including door: 6 7/8"
Dimension from wall to outer
Edge of door (when recessed): 3"
Penetration into opening: 3 7/8"
Wall opening height: 59 7/8"
Wall opening width: 14 1/4"
Wall opening depth: 3 7/8"

Overlap distances when using wall Opening dimensions listed above

Top overlap: 3/8"
Bottom overlap: 3/8"
Right side overlap: 3/8"
Left side overlap: 3/8"

Additional Information

- Unit may be surface mounted (unit extends approximately 6 7/8" into room) or recessed (unit extends approximately 3" into room) into any wall with standard 16" center studs.
- See table to the right to determine desired ironing board height above the floor. The user can adjust height of board after installation with a 4" differential between a maximum and minimum height.
- Unit can be provided with a left hinged door upon request. Right hinge is standard.
- Comes standard with birch veneer door.
- Electrical requirements: 115/120v, 15 amp. Pigtales are provided in bottom of wire raceway for hookup to supply line. Make entrance into knockout provided in top of wire way through left-hand vent hole.
- Recommended to attach 2" x 4" cleats to studs, level with the bottom of opening (for support when recessing unit.)
- Door opens approximately 180°. Allow at least 16" to the side of the unit for door to swing open (door hinges on full length piano hinge.)
- Options include: Surface mount trim (necessary for surface mounting), oak, maple, pine, or white raised panel door, flat white door, glass mirrored door, or no door, sleeveboard, swivel, rough-in kit, and iron.

See Page 2 for additional information

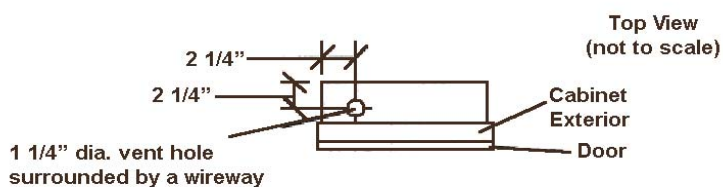
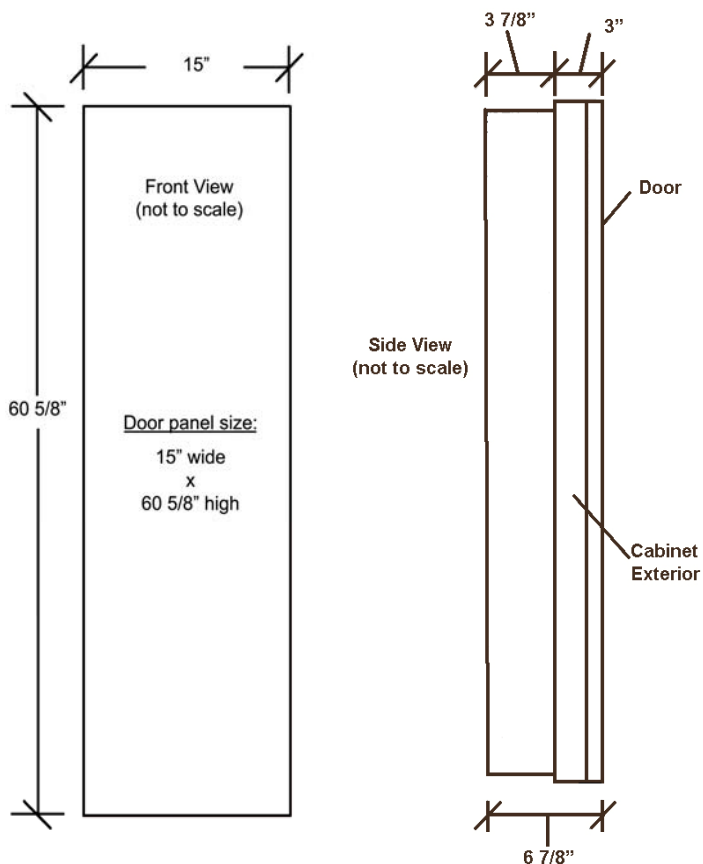

Height Adjustments		
Cut Opening Above floor	Regular Position	(Adjusted) Position
24"	38"	34"
23"	37"	33"
22"	36"	32"
21"	35"	31"
20"	34"	30"
19"	33"	29"
18"	32"	28"
17"	31"	27"
16"	30"	26"
15"	29"	25"

Board lowers to high position for normal usage. Low position requires adjustment.

Page 2

Additional Information

Measurements when board is lowered
(not to scale)

Unit can be provided with a left hinged door upon request. Right hinge is standard.

