

14004932-001 VP Valve Adapter

FOR USE WITH VP525, VP527, VP531 VALVES

INSTALLATION INSTRUCTIONS

DESCRIPTION

The VP Valve Adapter allows you to retrofit an electric actuator (M6410 or M7410) on Honeywell pneumatic unitary valves. (See Table 1 for compatibility). The adapter consists of an M6410/7410 linkage (the valve head cover) and a green main spring.

NOTE: The 316027-00042 Green Main Spring can be ordered separately.

Table 1. Close-off Pressure Ratings with Adapter.

Valve	Size (in.)	Cv	Spring Range (psi)	Close-off (psi)
VP525A	1/2	0.63	3-10	350
		2	2-5	125
			3-10	
	3/4	3	2-5	68
			3-10	
		5	2-5	54
VP525C	1/2	0.63	3-10	325
		2	3-10	110
	3/4	3	3-10	57
		5	3-10	42
VP527A	1/2	0.63	2-5	265
			3-10	
		1.0	2-5	160
	3/4		3-10	
		1.6	2-5	
			3-10	
VP531A	1/2 to 7/8	1.6 to 3.3	2-5 or 3-10	72.4
VP531C	1/2 to 7/8	1.6 to 3.3	2-5	22.6

THREE-WAY VALVE APPLICATIONS

Use of the green main spring limits three-way valve upper seat close-off force to a maximum of 5 psid. To achieve proper close-off, Honeywell recommends replacing the valve with a V5853 or V5863 Threaded Linear Valve. The M6410 and M7410 actuators can provide sufficient close-off force and are compatible with the V5853 and V5863 valves.

INSTALLATION

When Installing this Product...

1. Read these instructions carefully. Failure to follow them could damage the product or cause a hazardous condition.
2. Check the ratings given in the instructions and on the product to make sure the product is suitable for your application.
3. Installer must be a trained, experienced service technician.
4. After installation is complete, check out product operation as provided in these instructions.

Mounting

NOTE: Mounting the adapter and an M6410/M7410 actuator requires approximately 3 in. (76 mm) of space above the existing pneumatic actuator cover.

1. Cut tubes near air head and, if necessary, plug to conserve air.

IMPORTANT

Handle actuator cover peg carefully. Any damage to the peg will destroy it.

2. Remove and set aside peg from actuator cover (see Fig. 1):
 - a. Using a small flathead screwdriver, gently pry peg head away from the cover around the entire circumference of the head.
 - b. Grasp peg with your fingers and carefully remove it from the cover.



3. Rotate cover counterclockwise, remove and discard.
NOTE: Rotating the cover can require that you press while turning.
4. If the main spring is green, skip to step 6.
5. Replace existing spring with the green spring, included in kit.
6. Attach the adapter cover to the actuator.
7. Ensure that the cover and actuator peg are aligned.
8. Insert the peg into the cover.
9. Only the tapered portion of the metal adapter stem should protrude above the rest of the adapter. If this is not the case, rotate the hexagonal portion of the adapter:
 - a. clockwise: to lower the stem.
 - b. counterclockwise: to raise the stem.
10. Pull the hexagonal portion of the adapter straight off of the adapter and discard it.

11. Attach and wire the actuator according to the instructions included with the device.

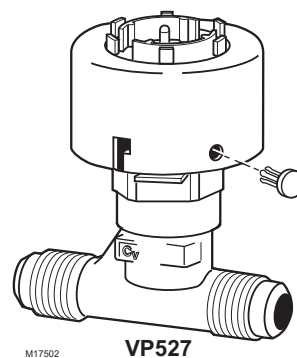

Fig. 1. Cover peg removal.

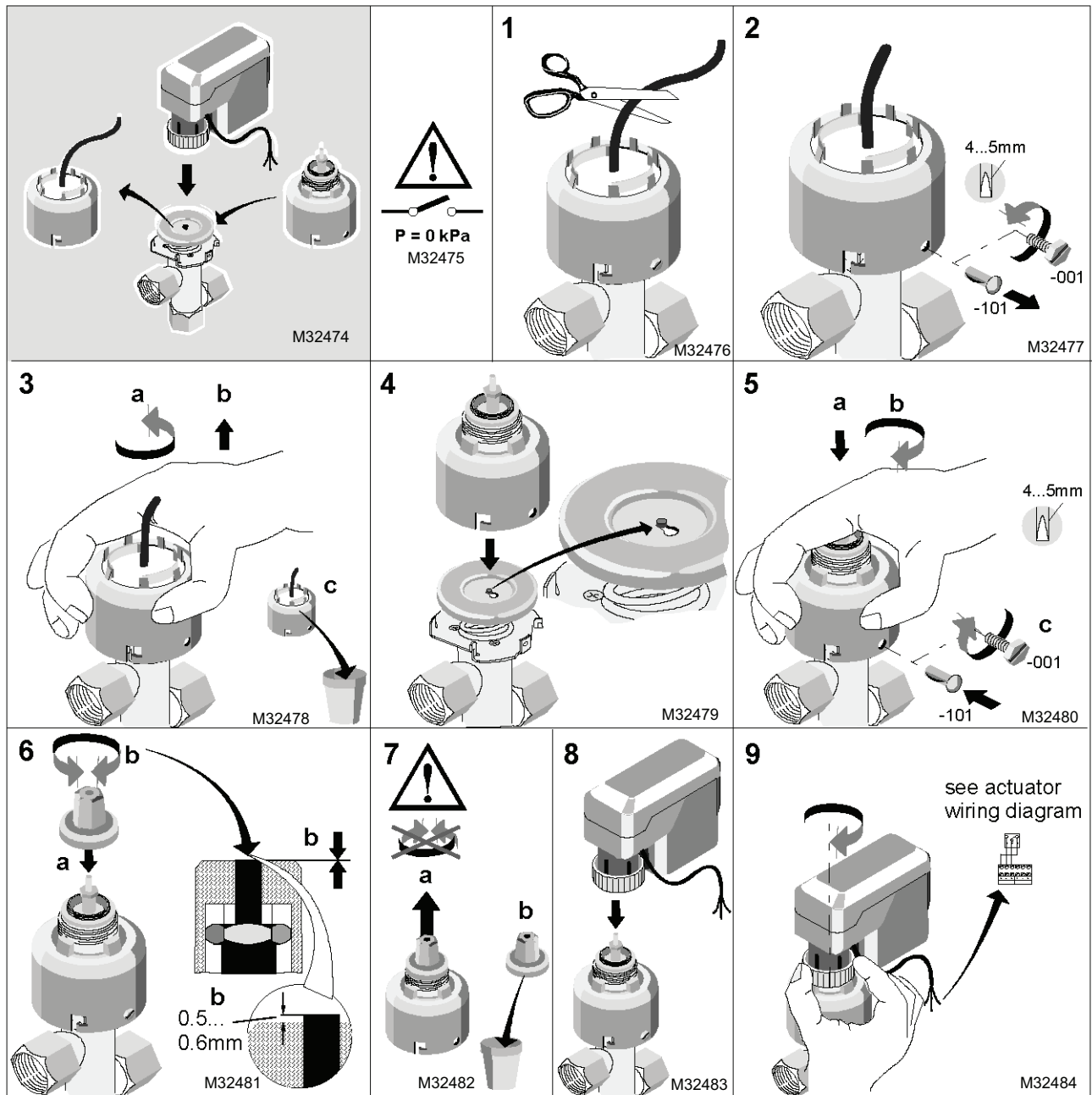

Fig. 2. Installation Diagram

Automation and Control Solutions

Honeywell International Inc.
1985 Douglas Drive North
Golden Valley, MN 55422

Honeywell Limited-Honeywell Limitée
35 Dynamic Drive
Toronto, Ontario M1V 4Z9
customer.honeywell.com

By using this Honeywell literature, you agree that Honeywell will have no liability for any damages arising out of your use or modification to, the literature. You will defend and indemnify Honeywell, its affiliates and subsidiaries, from and against any liability, cost, or damages, including attorneys' fees, arising out of, or resulting from, any modification to the literature by you.

Honeywell

© U.S. Registered Trademark
© 2011 Honeywell International Inc.
62-0163-01 T.W. Rev. 01-11
Printed in U.S.A.