



Undertone®
Under-mount Kitchen Sink
K-3166-L

Features

- 45-inch minimum base cabinet width.
- 18-gauge stainless steel.
- Under-mount.
- Rounded bowls.
- Triple compartment.
- 7-1/2" (191 mm) deep left bowl, 9-1/2" (241 mm) deep right bowl and 5-1/2" (140 mm) deep center bowl.
- With SilentShield® sound-absorption technology.
- 41-5/8" (1057 mm) x 20-1/8" (511 mm)

Optional Accessories

- K- 3278 Cutting Board
- K- 3291 Colander
- K- 6139 Sponge Caddy
- K- 8801 Sink Strainer

Components

- Product includes:
- 91915 Hardware Kit



Codes/Standards

ASME A112.19.3/CSA B45.4

**Lifetime Limited Warranty for
KOHLER® Stainless Steel Sinks**

See website for detailed warranty information.

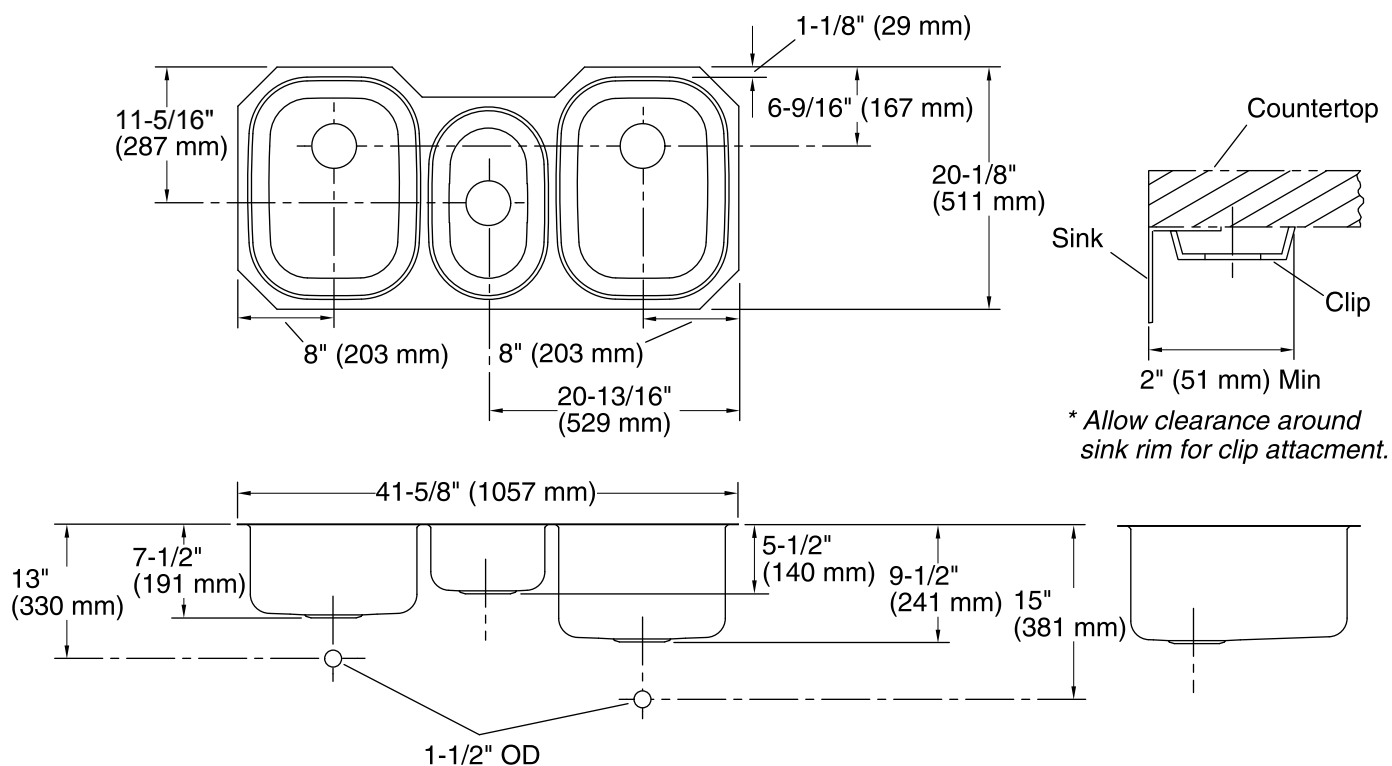

Technical Information

All product dimensions are nominal.

Bowl configuration: Two equal bowls and center bowl

Installation: Under-mount

Bowl area (Left) Length: 14" (356 mm)
Width: 18" (457 mm)
Bowl depth: 7-1/2" (191 mm)

Bowl area (Center) Length: 9" (229 mm)
Width: 15" (381 mm)
Bowl depth: 5-1/2" (140 mm)

Bowl area (Right) Length: 14" (356 mm)
Width: 18" (457 mm)
Bowl depth: 9-1/2" (241 mm)

Drain hole: 3-5/8" (92 mm)

Template: Under-mount, 1047579-7, required,
included

Notes

Install this product according to the installation guide.

Allow a minimum of 2" (51 mm) clearance around the sink rim for clip attachment.