



Conbraco Industries, Inc.
Matthews, NC 28105
704-841-6000

Laboratory Faucet Vacuum Breaker

Installation, Operation, and Maintenance Manual

Applications: This Conbraco Model 38-502 series vacuum breaker is recommended for laboratory faucet connections to protect the potable water system from contamination caused by back-siphonage. This vacuum breaker is not designed for continuous pressure.

NOTE: these valves may discharge water to prevent backflow - DO NOT install where spillage may cause water damage.

Installation Instructions:

1. For optimum performance, install a strainer upstream of the vacuum breaker to eliminate possible fouling.
2. Remove hose connectors or other equipment from the laboratory faucet.
3. Flush out the faucet with water to remove any accumulated scale or sediment which may possibly foul the vacuum breaker.
4. Screw the vacuum breaker into the outlet and tighten with a 7/8" open-end wrench.
5. Install hose connectors or other equipment into the outlet end of the vacuum breaker and tighten to obtain an effective seal.

Maintenance: Annual inspection is recommended to ensure water system safety and proper product function. See the repair instructions for proper disassembly.

Repair Instructions:

Disassembly-

1. Remove the device from the outlet of the faucet.
2. Place in a vice with the inlet retainer up and free from the clamping force of the vice. NOTE: use jaws or other means to protect the surface from clamp marks.
3. Remove the inlet retainer end; for Model 38-502-01, use a 3/8" Allen wrench; for Model 38-502-02 use a 7/8" open-end wrench.
4. Noting the presentation of the inlet check assembly (see diagram), remove and inspect for lodged debris or rubber degradation. Also inspect the sealing area for damage.
5. Place in a vice with the inlet retainer up and free from the clamping force of the vice.
6. Remove the outlet retainer using a 7/8" open-end wrench.
7. Noting the orientation of the outlet check assembly (see diagram), remove and inspect for lodged debris or rubber degradation. Remove the seal for the outlet retainer from the body and inspect for damage. Also inspect the sealing area in the body for damage.

Assembly- Reverse the order of disassembly, being sure to orient the check assemblies as shown.

Approvals:

CSA B64.7, ASSE 1035

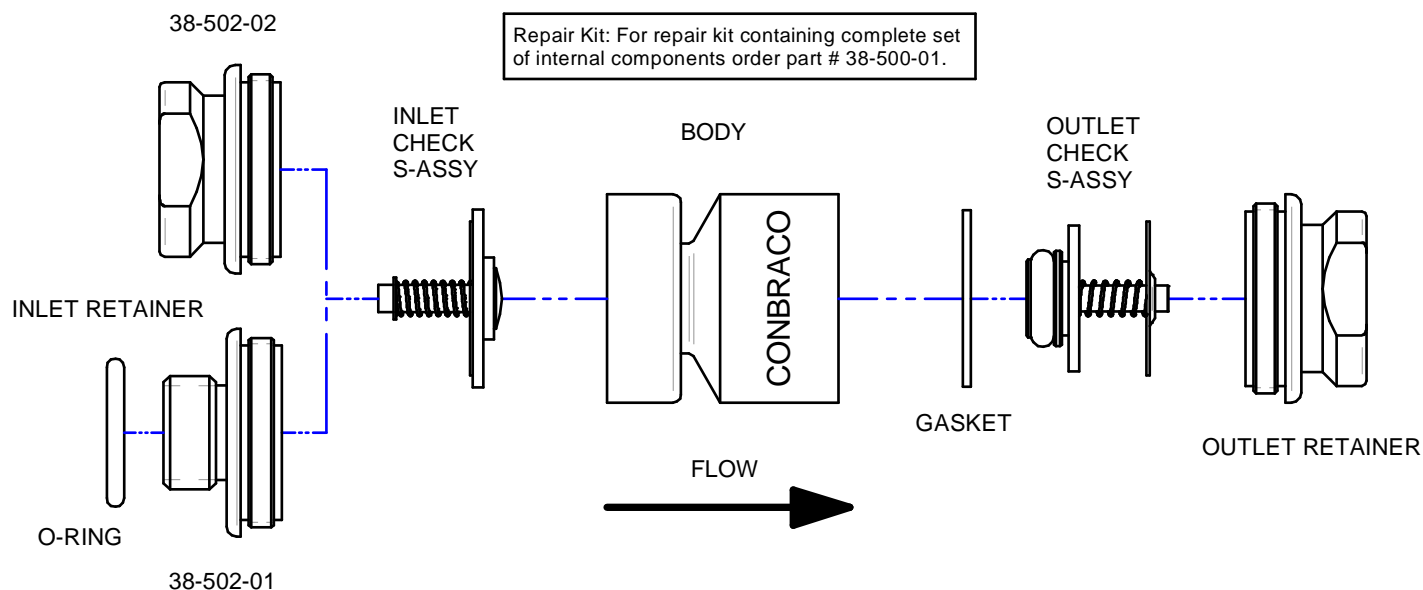

PROPOSITION 65 WARNING: This product contains a chemical known to the state of California to cause birth defects or other reproductive harm.

INSTALLER: California law requires that this warning be given to the consumer.