



SharkBite® Push-To-Connect Fittings

For Copper, CPVC or PEX Pipe

DESCRIPTION

The SharkBite® Push-To-Connect (PTC) Fittings allow the user to connect pipe in seconds with relative ease.

FEATURES AND BENEFITS

Instant push-fit connection for increased ease-of-use:

No soldering, clamps, unions, or glue required.

Fittings certified to 200 PSI and 200°F (93°C):

Proven durability and quality.

Fits copper tubing, and CTS CPVC and PEX:

Connects all three types in any combination.

Integral pipe liner for PEX installations:

Integrated design means no loose components, ensures secure, reliable connection.

Design certified and agency listed:

Inspector friendly, peace of mind!

Compact, robust Lead Free DZR brass body:

Foundation of a strong, corrosion resistant, durable fitting.

Design certified to NSF/ANSI 61, NSF/ASNI 14 and ASSE 1061 product standard for use in potable water and hydronic heating water distribution:

Quality engineered and manufactured.

Approved to be used underground and behind walls without access panels.

Designed for hydronic heating as well as potable water distribution.

SPECIFICATION

The tube shall be inserted into the SharkBite PTC Fitting in the first stage through a release collar and then through a stainless steel grab ring. The grab ring has teeth that open out and grip onto the tube. At the second stage the tube shall be pushed through an O-ring protector which aligns the pipe. A specially formulated EPDM O-ring shall be compressed between the wall of the fitting and the tube before the end of the tube reaches the tube stop. Only when the pipe has passed through the O-ring and reached the pipe stop shall a secure joint be created. The fitting shall be a SharkBite PTC Fitting.



U008LF



U248LF



U362LF

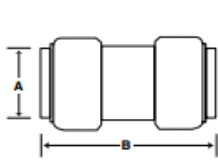

Straight Coupling Dimensions

P/N	A	B
U004LF	1/4"	1.59"
U006LF	3/8"	1.84"
U008LF	1/2"	2"
U016LF	3/4"	2.36"
U020LF	1"	2.72"

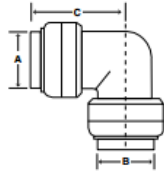

Elbow Dimensions

P/N	A	B	C
U244LF	1/4"	1/4"	1.160"
U276LF	1/4"	3/8" MIP	1.160"
U246LF	3/8"	3/8"	1.280"
U272LF	1/2"	3/8"	1.430"
U248LF	1/2"	1/2"	1.360"
U256LF	3/4"	3/4"	1.640"
U250LF	1"	1"	1.933"
U274LF	3/4"	1/2"	1.373"
U280LF	1/2"	1/2" MNPT	1.210"
U308LF	1/2"	1/2" FNPT	1.210"

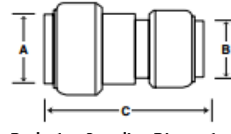

Reducing Coupling Dimensions

P/N	A	B	C
U009LF	3/8"	1/2"	2.00"
U058LF	3/4"	1/2"	2.20"
U060LF	1"	3/4"	2.51"

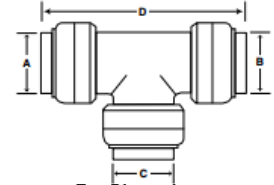

Tee Dimensions

P/N	A	B	C	D
U358LF	1/4"	1/4"	1/4"	2.30"
U360LF	3/8"	3/8"	3/8"	2.77"
U362LF	1/2"	1/2"	1/2"	2.72"
U363LF	1/2"	1/2"	3/8"	2.85"
U364LF	3/8"	3/8"	1/2"	2.77"
U370LF	3/4"	3/4"	3/4"	3.24"
U374LF	1"	1"	1"	3.84"
U412LF	3/4"	3/4"	1/2"	3.04"
U416LF	1"	1"	3/4"	3.63"
U444LF	3/4"	1/2"	3/4"	3.08"
U454LF	3/4"	1/2"	1/2"	2.92"

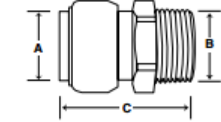
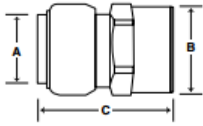

Connector Dimensions

P/N	A	B	C
U066LF	1/4"	1/2" FNPT	1.61"
U068LF	1/2"	3/4" FNPT	1.75"
U070LF	3/8"	1/2" FNPT	1.73"
U072LF	1/2"	1/2" FNPT	1.64"
U092LF	3/4"	1/2" FNPT	1.83"
U088LF	3/4"	3/4" FNPT	1.88"
U094LF	1"	1" FNPT	2.17"
U110LF	1/4"	1/2" MNPT	1.64"
U118LF	3/8"	1/2" MNPT	1.77"
U120LF	1/2"	1/2" MNPT	1.64"
U116LF	1/2"	3/4" MNPT	1.75"
U134LF	3/4"	3/4" MNPT	1.89"
U138LF	3/4"	1/2" MNPT	1.90"
U140LF	1"	1" MNPT	2.48"
U142LF	1"	3/4" MNPT	2.11"

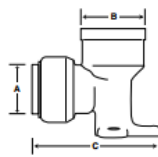

Drop Ear Elbow Dimensions

P/N	A	B	C
U249LF	1/2"	1/2"	2.20"
U332LF	3/8"	1/2" FNPT	1.83"
U334LF	1/2"	1/2" FNPT	1.77"
U335LF*	1/2"	1/2" FNPT	2.00"
U340LF	3/4"	3/4" FNPT	2.50"

*Hy-Ear Elbow

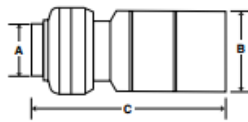

Fitting Reducer Dimensions

P/N	A	B	C
U719LF	3/8"	1/2"	2.08"
U721LF	3/8"	3/4"	2.27"
U722LF	1/2"	1"	3"
U724LF	3/4"	1"	2.25"

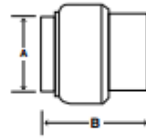

End Stops Dimensions

P/N	A	B
U512LF	3/8"	1.11"
U514LF	1/2"	1.08"
U518LF	3/4"	1.32"
U520LF	1"	1.52"

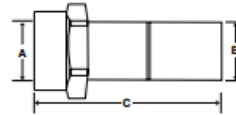

Fitting Adapter Dimensions

P/N	A	B	C
U766LF	3/4" FNPT	3/4"	2.83"
U772LF	1" FNPT	1"	2.83"

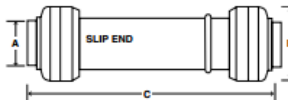

Slip Coupling* Dimensions

P/N	A	B	C
U3008LF	1/2"	1.075"	4.46"
U3016LF	3/4"	1.355"	4.42"
U3020LF	1"	1.640"	4.5"

*For use with copper & CPVC only

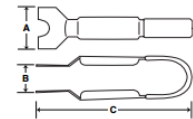

Disconnect Clips Dimensions

P/N	Fits SharkBite	A	B	C
U711	1/2"	1.7"	2"	6.5"
U713	3/4"	1.7"	2"	6.5"
U715	1"	1.7"	2"	6.5"

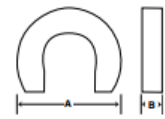

Disconnect Clip Dimensions

P/N	Size	A	B
U706	1/4"	1.19"	0.3"
U708	3/8"	1.22"	0.3"
U710	1/2"	1.22"	0.3"
U712	3/4"	1.72"	0.4"
U714	1"	2"	0.4"

Note: Disconnect Clips sold separately

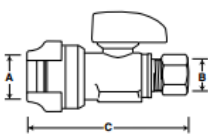

Straight Stop (Chrome Plated) Dimensions

P/N	A	B	C
23037-0000LF	1/2"	3/8" Compression	2.68"

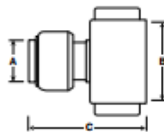

Ballcock Connector Dimensions (Chrome Plated)

P/N	A	B	C
U3531LF	1/4"	7/8" Ballcock	1.58"

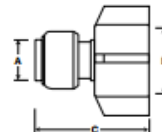

Faucet Connector Dimensions (Chrome Plated)

P/N	A	B	C
U3525LF	1/4"	1/2" NPS	1.58"

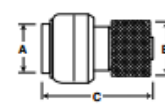

Stop Connector Dimensions (Chrome Plated)

P/N	A	B	C
U3523LF	1/4"	1/2" NPS	1.58"

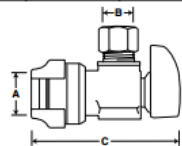

Angle Stop (Chrome Plated) Dimensions

P/N	A	B	C
23036-0000LF	1/2"	3/8" Compression	2.58"

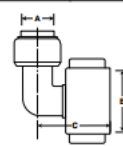

Ballcock Elbow (Chrome Plated) Dimensions

P/N	A	B	C
U3537LF	1/4"	7/8" Ballcock	1.05"

