

# SST STAINLESS STEEL TAPPING SLEEVE WITH STAINLESS STEEL FLANGE

## SUBMITTAL INFORMATION



**NOTE:** Sleeve meets the requirements of MSS SP-60 and AWWA C223.

## MATERIALS

### FLANGE

304 Stainless Steel Flange per AWWA C228-08. ANSI class 125 and 150 drillings and recessed to accept tapping valve. GMAW welded to neck.

### STAINLESS STEEL

Meets or exceeds ASTM A 240 type 304 UNS designated S30400.

### OUTLET

Heavy gauge 304L Stainless Steel. Fused to shell by GMAW weld on the outside and GTAW weld on the inside.

### SHELL

Heavy gauge Stainless Steel top half 304L back half 304.

### SIDEBARS

Heavy gauge 304 Stainless Steel, GTAW welded to form permanent fusion with shell.

### LUGS

304 Stainless Steel, fused to sidebars by GMAW welding.

### BOLTS

304 Stainless Steel, 4 inch sleeves use 1/2" UNC rolled thread, 6 - 12 inch sleeves use 5/8" UNC rolled thread. Bolts are GMAW welded to sidebar.

### NUTS

Heavy hex, 304 Stainless Steel, 4 inch nominal size sleeves uses 1/2" UNC threads, 6 inch nominal size and larger sleeves uses 5/8" UNC thread. Nuts coated to prevent galling.

### WASHERS

1/2" or 5/8" 304 Stainless Steel flat washers. 1/2" or 5/8" Plastic washer prevents galling between nut or stainless steel washer and lifter bar on all sizes.

### ARMORS

Heavy gauge 304 Stainless Steel.

### LIFTER BARS

304 Stainless Steel, lip curved to hold position while tightening. Heavy gauge serves as bearing surface for nuts.

### GASKETS

NSF 61 certified virgin SBR rubber compounded for water and sewer service in accordance with ASTM D 2000. Specially designed grid pattern and tapered ends to assure seal around full circumference of pipe. Reinforced ring at outlet provides hydrodynamic seal. Other compounds available for petroleum or high temperature service, or other special applications.

## WELDS

GMAW and GTAW weld processes. 308L Stainless Steel filler wire used as appropriate. Tapping Sleeve is fully passivated for enhanced corrosion resistance.

## PRESSURE

When properly installed, the Romac Style SST Tapping Sleeves can work at these pressures ratings:

PIPE SIZE	WORKING PRESSURE	TEST PRESSURE
4" - 8"	250 psi	312 psi
10" - 24"	200 psi	300 psi

## SIZES & RANGES

SEE CATALOG.

*This information is based on the best data available at the date printed above. Please check with Romac for any updates or changes.*



www.romac.com  
21919 20th Avenue SE • Suite 100 • Bothell, WA 98021  
Phone (425) 951-6200 • 1-800-426-9341 • Fax (425) 951-6201

# SST & SSTIII DIMENSIONS



## A ROMAC ORIGINAL

### 1980 - Stainless Steel Tapping Sleeve

Corrosion resistant, provides full circumferential seal.

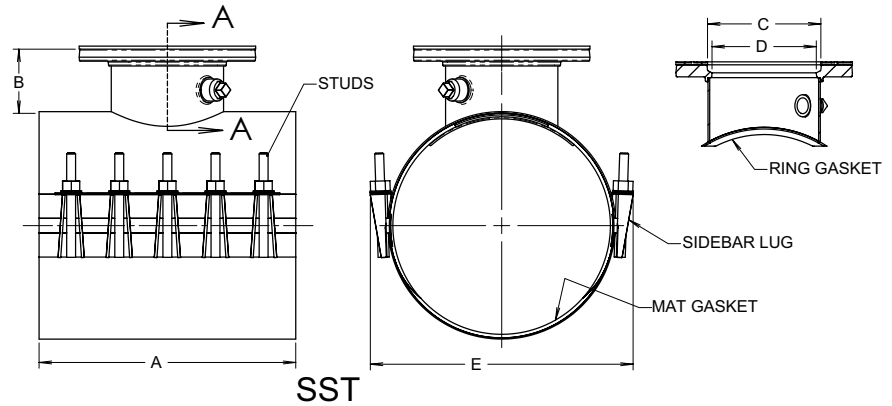

SST

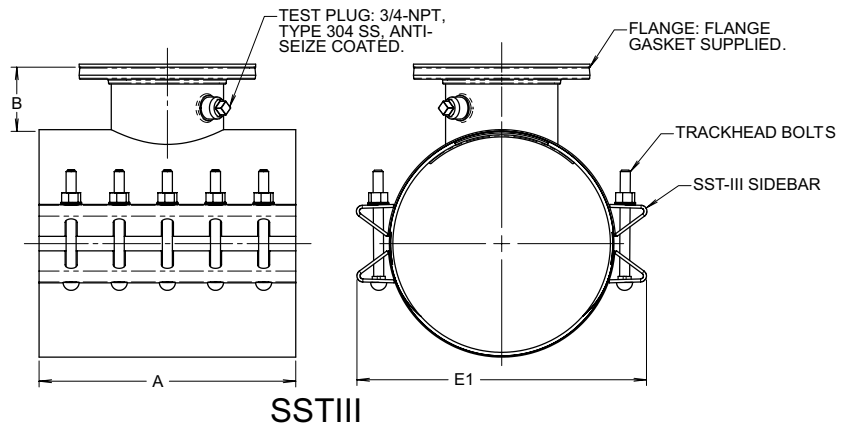

SSTIII

DIMENSIONS								
FLANGE SIZE	CATALOG NUMBER	# OF BOLTS	A	B	C	D	E	E1
3"	4.60 - 5.30	8	12.0	4.00	4.03	3 1/2	PIPE OD + 3.0	PIPE OD + 4.6
	5.60 - 19.30	10	16.0					
	19.70 - 26.50	14	20.0					
	27.80 - 32.00 <sup>1</sup>	21	20.0					
4"	4.60 - 5.30	8	12.0	4.00	5.03	4 1/2	PIPE OD + 3.0	PIPE OD + 4.6
	5.60 - 19.30	10	16.0					
	19.70 - 26.50	14	20.0					
	27.80 - 32.00 <sup>1</sup>	21	20.0					
6"	6.25 - 17.95	10	16.0	4.5	7.03	6 1/2	PIPE OD + 3.0	PIPE OD + 4.6
	18.25 - 26.50	14	20.0					
	27.80 - 32.00 <sup>1</sup>	21	20.0					
8"	8.30 - 26.50	14	20.0	5	9.03	8 1/2	PIPE OD + 3.0	PIPE OD + 4.6
	27.80 - 32.00 <sup>1</sup>	21	20.0					
10"	10.73 - 26.50	16	24.0	5.5	11.03	10 1/2	PIPE OD + 3.0	PIPE OD + 4.6
	27.80 - 32.00 <sup>1</sup>	24	24.0					
12"	12.75 - 16.78	20	30.0	5.75	13.03	12 1/2	PIPE OD + 3.0	PIPE OD + 4.6
	17.55 - 26.50	20	30.0					
	27.80 - 32.00 <sup>1</sup>	30	30.0					

<sup>1</sup> SSTIII Only

- 6.25 & 6.60 sizes not available with 6" branch.
- 8.30 size not available with 8" branch.

- 10.73 size not available with 10" branch
- 12.75 - 12.90 sizes: 1/2" undersize cutter recommended.