

DIMENSIONAL SPECIFICATIONS

STAINLESS STEEL ISO PATTERN FITTINGS 150 LB.

CROSS (304)

Part #	Size (IN.)	Approx. Net WT. (LB.)	A	L
K410-02	1/8	0.09	0.60	0.75
K410-04	1/4	0.16	0.78	0.83
K410-06	3/8	0.24	0.92	0.98
K410-08	1/2	0.33	1.10	1.10
K410-12	3/4	0.58	1.37	1.30
K410-16	1	0.98	1.72	1.50
K410-20	1-1/4	1.56	2.09	1.77
K410-24	1-1/2	1.66	2.28	1.97
K410-32	2	2.63	2.80	2.28
K410-40	2-1/2	4.53	3.43	2.72
K410-48	3	4.96	3.90	3.07
K410-64	4	7.93	4.92	3.78

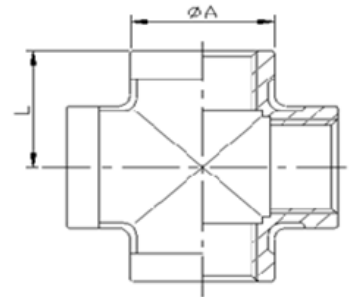

CROSS (316)

Part #	Size (IN.)	Approx. Net WT. (LB.)	A	L
K610-02	1/8	0.09	0.60	0.75
K610-04	1/4	0.16	0.78	0.83
K610-06	3/8	0.24	0.92	0.98
K610-08	1/2	0.33	1.10	1.10
K610-12	3/4	0.58	1.37	1.30
K610-16	1	0.98	1.72	1.50
K610-20	1-1/4	1.56	2.09	1.77
K610-24	1-1/2	1.66	2.28	1.97
K610-32	2	2.63	2.80	2.28
K610-40	2-1/2	4.53	3.43	2.72
K610-48	3	4.96	3.90	3.07
K610-64	4	7.93	4.92	3.78

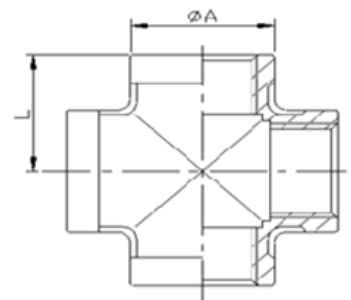

MERIT BRASS

DIRECTING THE FLOW OF *Quality*