

680 / 681

TANK LEVERS

Fits front, side and angle-mount tanks

Broken tank lever? Replace with Fluidmaster's durable universal tank lever.

The arm can be bent or trimmed to fit just about any tank. Available in both white and chrome finishes to match any bathroom.

Special Features:

- Chrome and white finish
- Trim or bend arm to fit most front, side and angle-mount tanks
- Easy to install
- Self-tightening locknut won't loosen over time
- Stylish design



TANK LEVERS

Update the look of your toilet



The Toilet Repair
Experts



680 / 681 TANK LEVERS

The Toilet Repair Experts

Fits Most Toilets

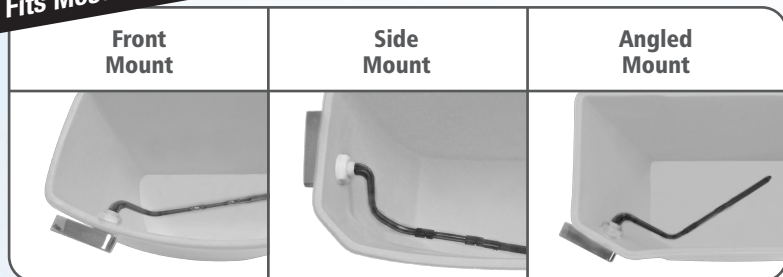

- Chrome and white finish
- Trim or bend arm to fit most front, side and angle-mount tanks
- Easy to install
- Self-tightening locknut won't loosen over time

STEP 1

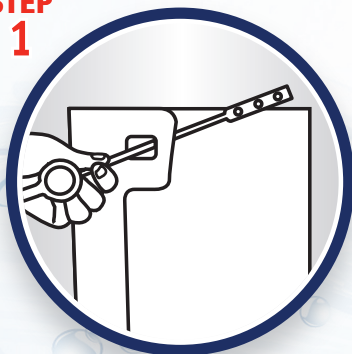

Remove old lever

STEP 2



Adjust arm to fit tank

STEP 3



Install. Tighten locknut

MODEL NUMBER	DESCRIPTION	CASE QTY	PRODUCT DIMENSIONS W/D/H (INCHES)	CASE DIMENSIONS W/D/H (INCHES)	CASE WEIGHT (LBS)	UPC	SCCI 2 of 5
680	Standard White Tank Lever	10	12.5" x 3.75" x 1.5"	7.38" x 13.13" x 4.31"	2	0 39961 006806	100 39961 006803
681	Standard Chrome Tank Lever	10	12.5" x 3.75" x 1.5"	7.38" x 13.13" x 4.31"	2	0 39961 006813	100 39961 006810