



Overture®

5' Bath

K-1227



Features

- Drop-in
- Center drain.
- Integral lumbar support.
- Textured bottom surface.
- 60" (1524 mm) x 42" (1067 mm) x 20" (508 mm)

Material

- Vikrell®

Required Accessories

K- 7161-AF Bath Drain

Recommended Accessories

K- 1278 Removable Apron

K- 9694 4-Jet Trim Kit



Codes/Standards

CSA B45.5/IAPMO Z124

ASTM E162

ASTM E662



Greenguard UL 2818 - Gold

KOHLER® One-Year Limited Warranty

See website for detailed warranty information.

Available Color/Finishes

Color tiles intended for reference only.

Color	Code	Description
	0	White
	96	Biscuit
	47	Almond

USA/Canada: 1-800-4KOHLER (1-800-456-4537)

Kohler Co. reserves the right to make revisions without notice to product specifications.

For the most current Specification Sheet, go to www.kohler.com.

3-27-2016 05:51

THE BOLD LOOK
OF **KOHLER®**

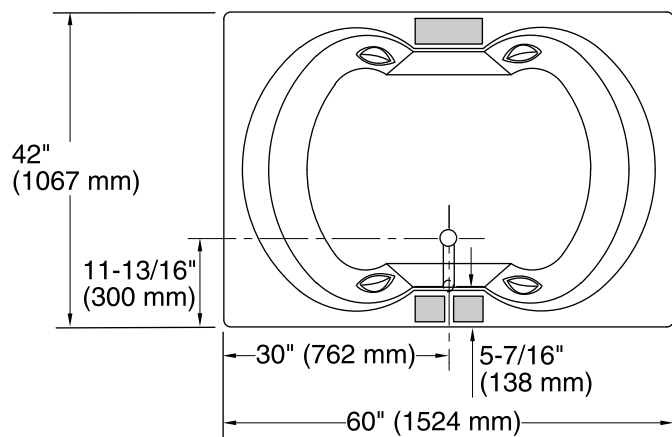

No change in measurements if connected with drain illustrated. (K-7161-AF)

 Recommended faucet area

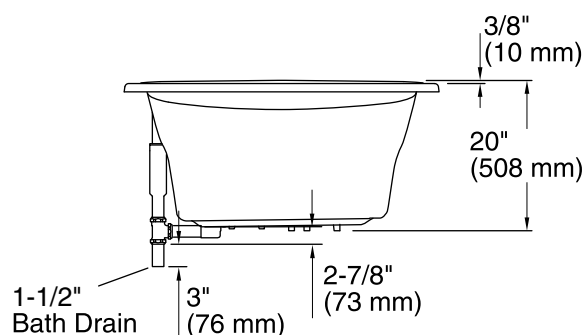
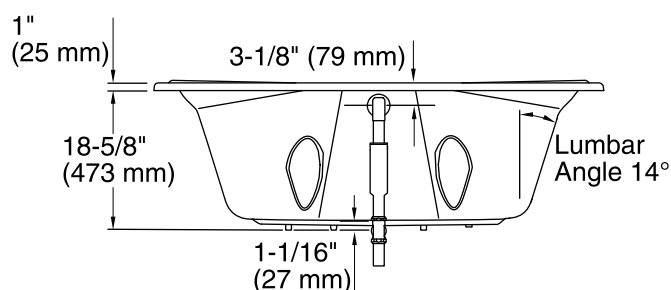

Technical Information

All product dimensions are nominal.

Installation:	Drop-in
Drain location:	Center
Basin area, bottom:	37" x 26" (940 mm x 660 mm)
Basin area, top:	54" x 37" (1372 mm x 940 mm)
Weight:	57 lbs (25.9 kg)
Minimum floor load:	37 lbs/ft² (180.6 kg/m²)
Water depth:	14-1/4" (362 mm)
Water capacity:	69 gal (261.2 L)
Cutout:	Drop-in, 58-1/2" x 40-1/2" (1486 mm x 1029 mm)

Notes

Measure your actual product for rough-in details.

Install this product according to the installation instructions.

The hot water supply should be 70% of the capacity of the bath or greater. Installations will vary.

If installing a rim-mount faucet, make sure there is no interference with drain overflow before drilling any holes. Consult local and national codes for minimum air gap requirements if installing a spout on the faucet deck.