



Stainless



Black



White



Overlay

CLR2160

2000 SERIES

FEATURES

PERFORMANCE

- Daily ice rate of up to 60 lbs and storage of up to 30 lbs of restaurant quality clear ice (7/8" W x 7/8" H x 7/8" L)
- Drain required and drain line kit is included to ensure proper installation
- Touch glass digital control featuring easy view command center manages key functions such as adjusting desired cube density with a single touch
- Easiest clear ice machine to clean and the clean indicator alert lets you know when it's time to clean the unit, the 45 minute cleaning cycle ensures high quality ice production and helps maintain proper operation
- Silence mode temporarily suspends ice making for three hours
- Sabbath / Blackout mode turns off all lighting, controls display and automatically resets after 36 hours
- No defrosting required
- UL residential and commercial listings

INTERIOR / EXTERIOR

- May be ordered with or without factory installed P60 drain pump
- Lighted white interior optimizes easy viewing of high quality clear ice cubes
- Heavy duty ice scoop is included and may be positioned according to user preference
- Standard commercial stainless steel handle is interchangeable with professional handle option for stainless steel model
- Self-closing door ensures a positive door seal and prevents door bounce back
- Full wrap stainless door on stainless model and unit must be ordered right or left hand hinged
- Black, white and overlay model door is field reversible
- Black vinyl clad textured cabinet is more resistant to scratching, peeling and flaking

INTEGRATION

- Unit can be built-in or freestanding providing a custom aesthetic
- Black and white models will accept a 1/4" insert panel to match with surrounding decor
- Optional full 3/4" overlay panel on black and white models requires purchase of overlay kit PN: U-OL2115
- Allow a 2-1/2" clearance on hinged side for 90° door opening when installed adjacent to a wall (for stainless steel model)
- Allow 1/4" width overall for proper installation (see backside for details)
- No additional clearance around sides, top or rear of unit is needed for ventilation
- Durable, factory installed level legs provide a more precise undercounter fit
- Do not obstruct front grille air flow



Customize clear ice cube density with a single touch for varying user preferences



Produces 32 clear ice cubes per cycle (7/8" W x 7/8" H x 7/8" L)

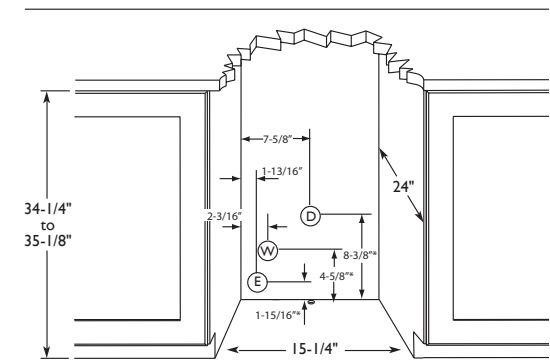
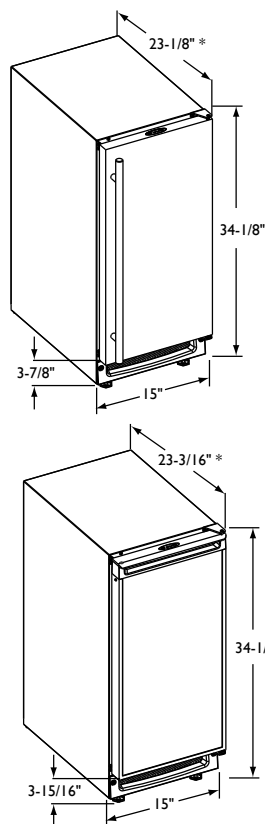

Legend: E - Electrical W - Water

*Can Vary Up To +1" Depending on Leg Leveler Height

CLR2I60 Black Model and CLR2I60 Black, White and Overlay Models

* Add 3/4" to depth for drain line clearance

DIMENSIONS AND SPECIFICATIONS

OVERALL DIMENSIONS

Height	34-1/8" (86.6)
Width	15" (38.1)
Depth	23-3/16" (58.9)
Shipping weight:	
Black and white models	100 lbs (45kg)
Stainless model	100 lbs (45kg)
Running amps	4.0
Maximum start-up amps	26.5
Amps pertain to voltage rating	110/115 volt, 60 Hz
Approximate daily ice production	Up to 60 lbs
Ice storage	Up to 30 lbs
Optional in 220/230 voltage, 50/60 Hz	
On the 220/230 volt models, amps are decreased by approximately 50 percent.	

CLR2I60

Stainless Right-hand, no pump	U-CLR2I60S-00
Stainless Right-hand, with pump	U-CLR2I60S-40
Stainless Left-hand, no pump	U-CLR2I60S-00
Stainless Left-hand, with pump	U-CLR2I60S-40
Black, no pump	U-CLR2I60B-00
Black, with pump	U-CLR2I60B-40
White, no pump	U-CLR2I60W-00
White, with pump	U-CLR2I60W-40
Overlay	U-CLR2I60B-00 with Overlay kit U-OL2I15B

Please visit www.u-line.com for installation guide.

All specifications are subject to change without notice.