

Aktiva™ Showerhead

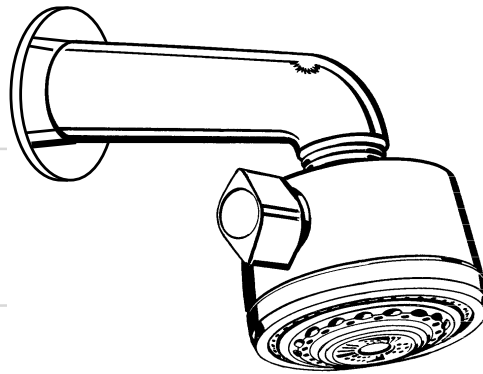

27470

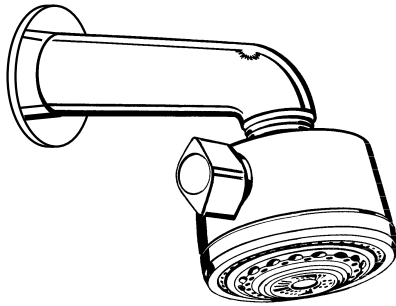

Aktiva Showerhead with Arm  
27470  
Aktiva Showerhead  
28490

Installer Notes:

This is a specialty showerhead. For best results, Hansgrohe recommends that this be used only with a 3/4" thermostatic mixer and a 3/4" volume control valve. Do not use this showerhead with a pressure balancing mixer.

Due to the weight of this showerhead, Hansgrohe recommends that it be used only with the shower arm included with the 27470, or with the 27431 Large Cast Shower Arm, available separately.

The 28490 can be used in a ceiling installation provided that the supply pipe is properly secured.

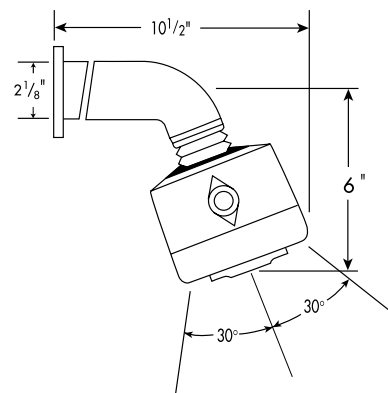

27470

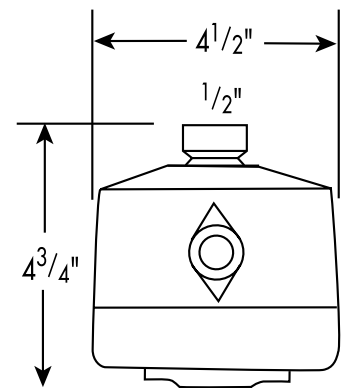

28490

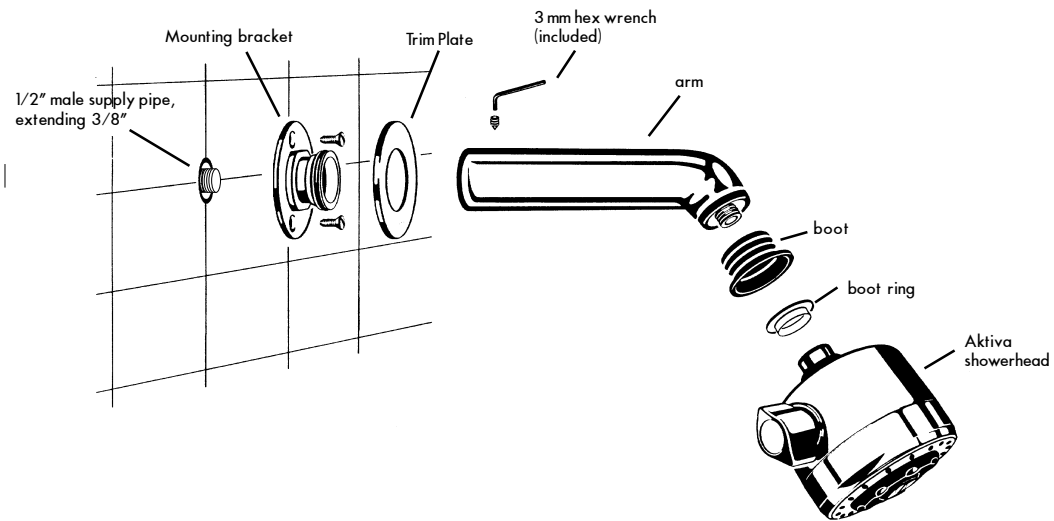

## Installation Instructions-27470

1. Install 1/2" male supply pipe, extending 3/8" from the surface of the finished wall.
2. Seal the wall around the pipe using a good quality bathroom sealer.
3. Install the mounting bracket to the supply pipe.
4. Secure the mounting bracket to the wall using the screws provided.
5. Slide shower arm through the trim plate and over the mounting bracket. Secure the arm to the mounting bracket with the set screw.
6. Mount the showerhead on the shower arm.

## User Instructions

The selector knob on the side allows the user to select regular spray, pulsating massage spray, and soft aerated spray.

When the modes are changed, green Quick-Clean pins automatically clear the spray channels of any mineral deposits.

## Care Instructions

All finishes: Clean with a mild soap and water solution. Rinse thoroughly with clear water and polish dry with a soft cloth.

Do not use cleaners containing acids, solvents, or abrasives.

Damage caused by improper care is not covered under the Hansgrohe USA warranty.

Polished Brass: after each use, wipe gently with a damp cloth and blot dry with a soft cloth.

## Lifetime Limited Consumer Warranty

Hansgrohe products are manufactured and tested to the highest quality standards. Hansgrohe, Inc. warrants to the original consumer that its products will be free from defects of workmanship and materials for as long as the original consumer owns the home in which the products are installed. Accessories or parts of products manufactured by others are warranted only for the period and to the extent of the original manufacturer's warranty.

This warranty applies only to products purchased for consumer use. Products purchased for commercial, industrial or business use are covered under a separate five-year warranty.

This warranty does not cover installation or any other labor charges associated with the repair or reinstallation of Hansgrohe products.

This express warranty does not apply to products that have been damaged due to misuse, abuse, negligence, accident, faulty installation, use of abrasive or caustic cleaners, poor maintenance practices or use in any manner contrary to the written instructions provided.

Hansgrohe, Inc. will repair or replace, at its option, free of charge during the warranty period, any part which proves to be defective in material and/or workmanship under normal installation, use, service and maintenance. If Hansgrohe, Inc. is unable to provide a replacement and repair is not practical or cannot be made in a timely manner, Hansgrohe, Inc. will refund the purchase price in exchange for return of the product. THIS REMEDY IS THE SOLE AND EXCLUSIVE REMEDY TO THE PURCHASER FOR THE BREACH OF ANY WARRANTIES OR NEGLIGENCE BY HANSGROHE, INC.

For assistance, simply notify your Hansgrohe dealer or write to: Customer Service, Hansgrohe, Inc., 1490 Bluegrass Lakes Pkwy, Alpharetta, GA 30004. Include the original receipt with a description of problem, model number and your name and address. Hansgrohe may, at its option, require you to send the defective part of the product prepaid for inspection prior to replacement.

This warranty is limited to the above; and this warranty and any warranties implied by state law, including the implied warranty of merchantability, apply only to products purchased after March 1, 1996. This warranty gives you specific legal rights; you may also have other rights which vary from state to state. Unless otherwise contrary to state law governing the purchase, Hansgrohe, Inc. liability will not exceed the contract price for the product claimed to be defective or unsuitable and is applicable only to products purchased through Hansgrohe, Inc. and installed in the United States or Canada.