

FEATURES

- Solid brass construction for durability and reliability
- Allows bather to set precise temperature
- Patented K-joint installation ensures consistent trim appearance, regardless of variability in valve rough-in
- Complements the Tuxedo collection

CODES/STANDARDS APPLICABLE

Specified model meets or exceeds the following:

- ASME A112.18.1/CSA B125.1

P24022

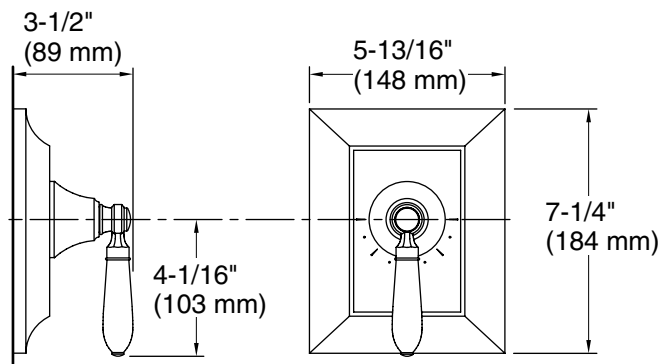

P24022-CL

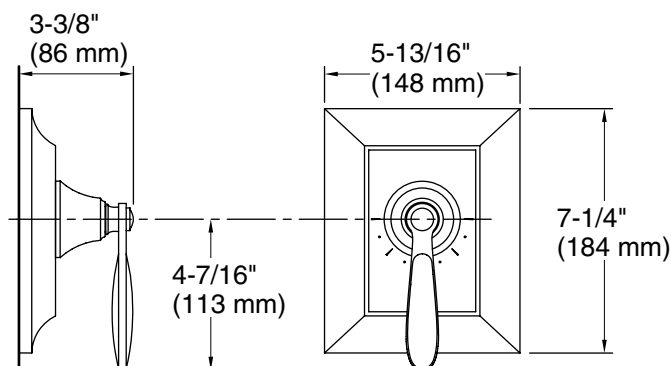

P24022-KL

SPECIFIED MODEL				
Model	Description	Finishes		
P24022-CL	Tuxedo Thermostatic Valve Trim, Classic Handle	<input type="checkbox"/> CP Polished Chrome	<input type="checkbox"/> AD Nickel Silver	<input type="checkbox"/> AG Brushed Nickel
P24022-KL	Tuxedo Thermostatic Valve Trim, Streamline Handle	<input type="checkbox"/> CP Polished Chrome	<input type="checkbox"/> AD Nickel Silver	<input type="checkbox"/> AG Brushed Nickel
Required Rough-in				
P29511-WS	1/2" Thermostatic Mixing Valve	<input type="checkbox"/> NA		
P29512-WS	3/4" Thermostatic Mixing Valve	<input type="checkbox"/> NA		
Required Accessories (Choose one Trim and Valve)				
P29504-XY	3/4" Volume Control Valve	<input type="checkbox"/> NA		
Note: For trim options, refer to P24023 Volume Control Valve Trim Specification.				

We reserve the right to make revisions without notice in the design of products or in packaging unless this right has specifically been waived at the time the order is accepted.