

REVISIONS		
REV	DESCRIPTION	DATE
B	ROTATE REBAR 90°- 1 PC, ADDED RIBBING	03/26/08
C	REMOVED (1) PIPE SLOT, ADDED ARROW IN TOP OF PIT SHOWING FLOW	07/08/08
D	REDESIGN ENDS & PIPE SLOTS, ADDED PAT #	08/13/08

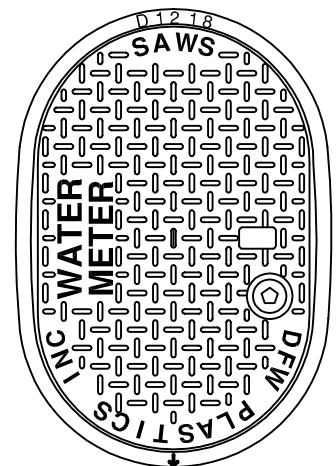

DFW1218-1EWA SAWS-LID

DFW1218-11-1EWA SAWS

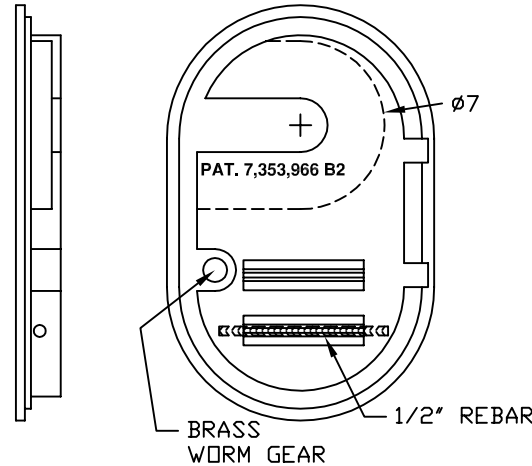
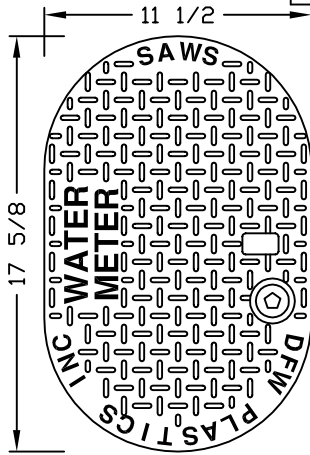
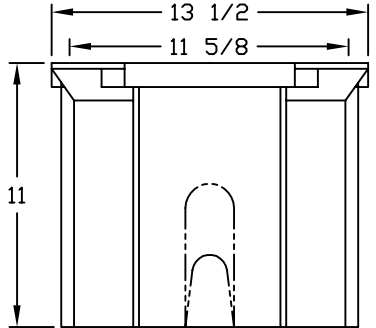
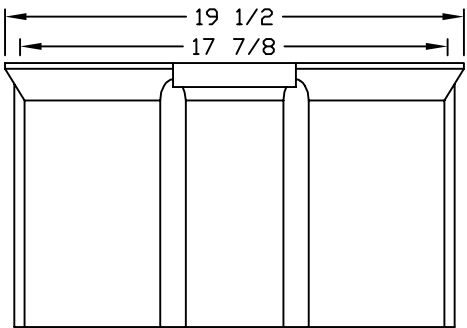
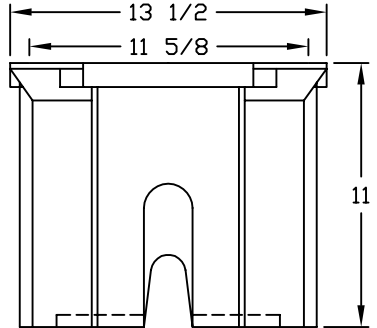
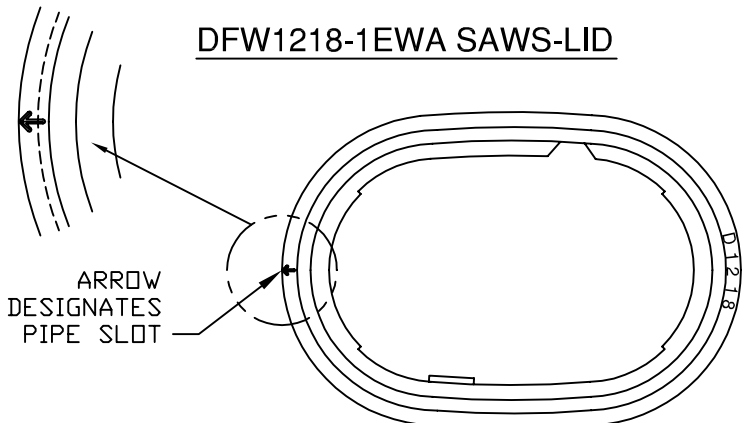

PIPE SLOT AS DESIGNATED BY ARROW

DFW1218-11-BODY

OPTIONAL PIPE SLOT

- 1) DIM'S ± 1/8 U.N.D
- 2) SNAP LOCK POCKET WILL RECEIVE I-TRON ERT. SNAP LOCK SLOT IS 1.80" ± .015" TO ALLOW FOR A FINGER FORCE INSTALL. POCKET HEIGHT IS 15/16 FOR MIN 1/8" AIR GAP.



DFW PLASTICS, INC.
1001 JARVIS RD
FORT WORTH, TX. 76179
(817) 439-3600
(817) 439-3700 (f)
www.dfwplasticsinc.com

SAWS

DFW1218-11-1EWA SAWS

FILE NAME: DFW1218-11-1EWA SAWS.DWG
UPDATED: 02/25/2010
DRAWN BY: J.C.A.
PLOT SCALE: 1:8