

61" Cast Iron Slipper Tub

Cat. No.
CTSH60



Cast Iron Tub



L: 61 1/4"
W: 30 1/4"
H: 21 1/2" & 31" (from floor to top of tub)
15 1/2" & 23 3/4" (from bottom of tub to top of tub)

The following is recommended for CTSH60 tubs with deck holes:

- Rim-mounted faucet: part #4601
- Straight bath supplies: part #5577
- Leg tub drain: part #5599

Do Not use with rigid, freestanding supplies.

Dimensions:

Gallon Capacity: 45 1/2

Shipping Weight: 380 lbs.

Empty Weight: 300 lbs.

Filled Weight: 679 lbs.

All CTSH60 tubs have 7" centers in tub deck.

Features

- Inside finish: White Enamel
- Ball and Claw Feet Available in 6 Finishes
- Tub Exterior Available as Unfinished (gray primer) or White (epoxy) at NO Extra Charge
- Non-skid Strips
- With Deck Holes

Foot Finishes:

BP Polished Brass
CP Polished Chrome
PN Polished Nickel
SN Brushed Nickel
WH White
ORB Oil-rubbed Bronze

Compliance Certification

Meets or exceeds the following specifications: A112-19-1M 1994.

Extra Paint Charge (inside of tub is always white enamel):

Bisque Paint - \$150

Black Paint - \$150

Bathtubs painted in bisque or black are considered "special order" and are not returnable.

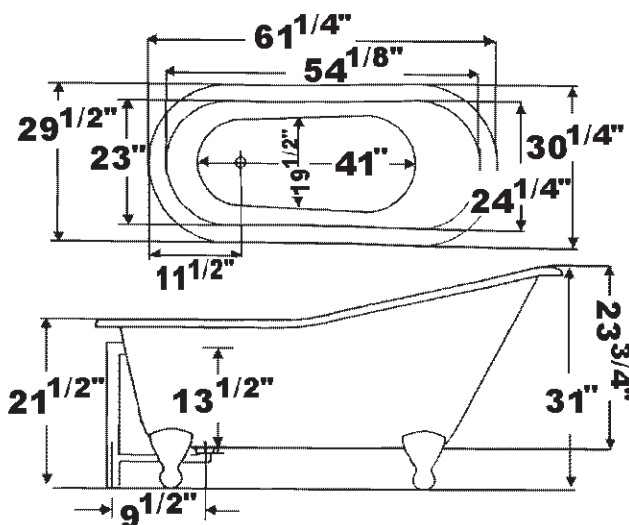

Dimensions of fixture are nominal and may vary within the range of tolerances established by ANSI Standard A112.19.1M. Dimensions and specifications subject to change without notice.