

**CLEAR ICE MODELS**  
**CLEAR ICE COMBO MODELS**  
**ICE COMBO MODELS**



**CO2I75**



**CLRCO2I75**



**COI175**



**CO29**



**CLR2I60**

## Models Covered

- |                   |                   |                 |                 |
|-------------------|-------------------|-----------------|-----------------|
| • U-CLR2I60B-00   | • U-CLR2I60W-40   | • U-COI175S-00  | • U-CO29B-20    |
| • U-CLR2I60B-40   | • U-CLR2I60W-40   | • U-COI175S-01  | • U-CO29BTP-20  |
| • U-CLR2I60S-00   | • U-CLRCO2I75B-00 | • U-COI175S-20  | • U-CO29FB-00   |
| • U-CLR2I60S-01   | • U-CLRCO2I75B-40 | • U-COI175S-22  | • U-CO29FB-98   |
| • U-CLR2I60S-40   | • U-CLRCO2I75S-00 | • U-CO2I75FB-00 | • U-CO29FB-99   |
| • U-CLR2I60S-4I   | • U-CLRCO2I75S-01 | • U-CO2I75FS-00 | • U-CO29FWH-00  |
| • U-CLR2I60SOD-00 | • U-CLRCO2I75S-40 | • U-CO2I75FS-01 | • U-CO29WH-03   |
| • U-CLR2I60SOD-01 | • U-CLRCO2I75S-4I | • U-CO2I75FW-00 | • U-CO29WHTP-20 |
| • U-CLR2I60SOD-40 | • U-COI175B-00    | • U-CO29B-00    |                 |
| • U-CLR2I60SOD-4I | • U-COI175B-20    | • U-CO29B-03    |                 |

## I Table of Contents

<b>Safety Precautions</b>	
Safety Alert Definitions.....	1
General Precautions .....	1
<b>Inspect &amp; Plan</b>	
Product Registration .....	2
Product Description .....	2
Tools / Material Required .....	2
Exterior Cleaning .....	2
Black and White Models:.....	2
Stainless Models:.....	2
<b>Prepare Site</b>	
Cut-Out Dimensions.....	3
(CLR)CO21 & CO11 Series.....	3
CLR2160 Series.....	3
CO29 Series.....	3
<b>Product Dimensions</b>	
All Models .....	4
<b>Door Swing Dimensions</b>	
Other Site Requirements .....	5
Side-By-Side Installation.....	5
Power Supply .....	5
Water Supply .....	5
Drain .....	5
Environmental Requirements .....	5
<b>Standard Doors</b>	
Door Alignment and Adjustment.....	6
Door Reversability.....	6
Reversing the Door.....	6
<b>Doors (Self Closing)</b>	
Door Alignment and Adjustment.....	8
Door Reversability.....	8
Reversing Black or White Doors.....	9
Reversing Stainless Steel Glass Doors 10	
<b>Door Panel Installation</b>	
Custom 1/4" Thick Door Panel Insert.....	13
Door Panel Preparation.....	13
Panel Dimensions.....	13
Door Panel Installation .....	13
<b>Wood Grille Overlay</b>	
Grille Overlay (Excludes CO1175).....	14
Preparation .....	14
Installation.....	14
<b>Prepare Power Supply</b>	
Electrical Specifications.....	17
Receptacle Location .....	17
<b>Prepare Plumbing</b>	
Copper Water Supply Connection:.....	18
U-Line Water Hookup Kit Connection:.....	19
Gravity Drain: .....	19
Factory Installed Drain Pump.....	20
Drain Connection: .....	21
Final Installation 21	
<b>Level The Unit</b>	
Leveling Information .....	22
<b>Install the Unit</b>	
Installation.....	22
Relocating the Shelves.....	22
Installation Troubleshooting.....	23

## 2 Safety Precautions

### IMPORTANT

- **PLEASE READ** all instructions before installing, operating, or servicing the appliance.
- Proper installation procedures must be followed when completing an installation or relocation of a unit. Consult the installation guide before any installation begins. U-Line contact information appears on the rear cover of this guide.
- This unit requires connection to a dedicated 15 Amp grounded (three-prong), polarized receptacle, installed by a qualified electrician, compliant with applicable electrical codes.

### Safety Alert Definitions

Throughout this guide are safety items labeled with a Danger, Warning or Caution based on the risk type:

#### DANGER

*Danger means that failure to follow this safety statement will result in severe personal injury or death.*

#### WARNING

Warning means that failure to follow this safety statement could result in serious personal injury, property or equipment damage.

#### CAUTION

Caution means that failure to follow this safety statement may result in minor or moderate personal injury, property or equipment damage.

## General Precautions

Use this appliance for its intended purpose only. Follow these general precautions with those listed throughout this guide:

#### DANGER

**RISK OF CHILD ENTRAPMENT.** Before you throw away your old refrigerator or freezer, take off the doors and leave shelves in place so children may not easily climb inside.

#### WARNING

**SHOCK HAZARD - Electrical Grounding Required.**

- Never attempt to repair or perform maintenance on the unit until the electricity has been disconnected.
- Never remove the round grounding prong from the plug and never use a two-prong grounding adapter.
- Altering, cutting of power cord, removal of power cord, removal of power plug, or direct wiring can cause serious injury, fire and or loss of property and or life, and will void the warranty.
- Never use an extension cord to connect power to the unit.
- Always keep your working area dry.

#### WARNING

Install provided Anti-Tip kit. Serious personal injury could occur.

#### CAUTION

- Use care when moving and handling the unit. Use gloves to prevent personal injury from sharp edges.
- If your model requires defrosting, **DO NOT** use an ice pick or other sharp instrument to help speed up defrosting. These instruments can puncture the inner lining or damage the cooling unit. **DO NOT** use any type of heater to defrost. Using a heater to speed up defrosting can cause personal injury and damage to the inner lining.

### IMPORTANT

- Do not lift unit by door handle.
- Never install or operate the unit behind closed doors. Be sure front grille is free of obstruction. Obstructing free airflow can cause the unit to malfunction and will void the warranty.
- Failure to clean the condenser every six months can cause the unit to malfunction. This could void the warranty.
- Allow unit temperature to stabilize for 24 hours before use.
- Do not Block any internal Fans

Use only genuine U-Line replacement parts. Imitation parts can damage the unit, affect its operation or performance and may void the warranty.



## Product Registration

You have received a carton containing your U-Line Clear Ice, Ice or Ice Combo unit with a package inside containing a Use and Care Guide, a Product Registration Card, and a water line kit. Please complete and mail the Product Registration Card or register online at [www.U-LineService.com](http://www.U-LineService.com). Once your unit is installed, keep the Use and Care Guide and this Installation Guide in a safe place for future reference.

## Product Description

This installation guide covers the following models.

<b>U-CLR2160B-00</b>	<b>U-CLRCO2175S-00</b>
<b>U-CLR2160B-40</b>	<b>U-CLRCO2175S-01</b>
<b>U-CLR2160S-00</b>	<b>U-CLRCO2175S-40</b>
<b>U-CLR2160S-01</b>	<b>U-CLRCO2175S-41</b>
<b>U-CLR2160S-40</b>	<b>U-CO1175B-00</b>
<b>U-CLR2160S-41</b>	<b>U-CO1175S-00</b>
<b>U-CLR2160SOD-00</b>	<b>U-CO1175S-01</b>
<b>U-CLR2160SOD-01</b>	<b>U-CO2175FB-00</b>
<b>U-CLR2160SOD-40</b>	<b>U-CO2175FS-00</b>
<b>U-CLR2160SOD-41</b>	<b>U-CO2175FS-01</b>
<b>U-CLR2160W-00</b>	<b>U-CO2175FW-00</b>
<b>U-CLR2160W-40</b>	<b>U-CO29B-00</b>
<b>U-CLRCO2175B-00</b>	<b>U-CO29FB-00</b>
<b>U-CLRCO2175B-40</b>	<b>U-CO29FWH-00</b>

## Inspection

Unwrap and inspect the unit on a flat, level surface capable of supporting its entire weight. If necessary remove protective film from Stainless Steel models.

## Tools / Material Required

- Screwdrivers — slotted, Phillips head
- 1/4-inch thick door panel material and cutting tools (If installing a 1/4" Panel)
- 1/4" Nut Driver
- 5/16" Nut Driver
- Side Cutter
- Copper tubing cutter
- 12" Level
- 9/16" Open end wrench
- 7/16" Open end wrench
- Pliers
- Copper tubing

### CO2175 Models Only

- Full Overlay Door Panel Kit. Part number U-OL2175B (black units) U-OL2175W (white units)

A complete water hook up kit is also available for purchase from your dealer. Order U-Line Part No. WATERHOOKUP.

## Exterior Cleaning

### Black and White Models:

- Black and White surfaces may be cleaned with a mild detergent and warm water solution. Do not use solvent-based or abrasive cleaners. Use a soft sponge and rinse with clean water. Wipe with a soft, clean towel to prevent water spotting.

### Stainless Models:

- Stainless door panels, handles and frames can discolor when exposed to chlorine gas, pool chemicals, salt water or cleaners with bleach.
- Keep your Stainless unit looking new by cleaning with a good quality all-in-one stainless steel cleaner/polish on a monthly basis. For best results use Claire Stainless Steel Polish and Cleaner, which can be purchased from U-Line Corporation (Part numbers 173348). Frequent cleaning will remove surface contamination that could lead to rust. Some installations may require cleaning on a weekly basis.
- **Do not clean with steel wool or abrasive pads.**
- **Do not use cleaners that are not specifically intended for stainless steel on stainless surfaces (this includes glass, tile and counter cleaners).**
- If any surface discolors or rust appears, clean it quickly with Bon-Ami or Barkeepers Friend Cleanser and a non-abrasive cloth. Always clean in the direction of the grain. Always finish this process with Claire Stainless Steel Polish and Cleaner or comparable product to prevent further problems.



### WARNING

**Rust that is allowed to linger can penetrate into the surface of the stainless steel and complete removal of the rust may not be possible.**

## 4 Prepare Site

Your U-Line product has been designed for either free-standing or built-in installation. When built-in, your unit does not require additional air space for top, sides, or rear. However, the front grille must NOT be obstructed and clearance is required for an electrical connection in the rear.

### IMPORTANT

- Unit can NOT be installed behind a closed cabinet door.
- If you would like to align the face of the unit with other adjacent cabinet doors, you may need to alter the wall just behind the drain connection on the unit to accommodate the drain.

## Cut-Out Dimensions

### (CLR)CO21 & CO11 Series

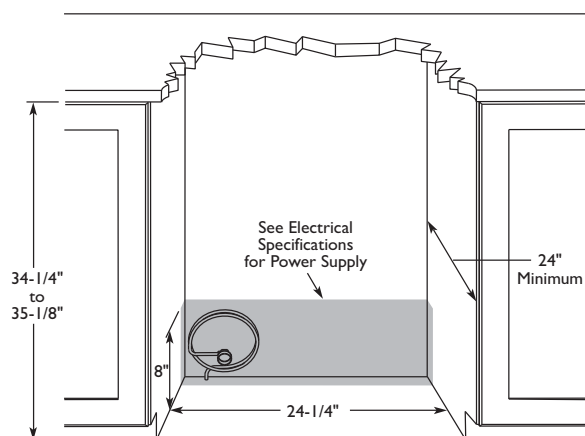

Follow the cut-out drawing. The 24-1/4" width allows 1/4" for ease in installation and removal of the unit. 24" is the cabinet depth in most installations.

### CLR2160 Series

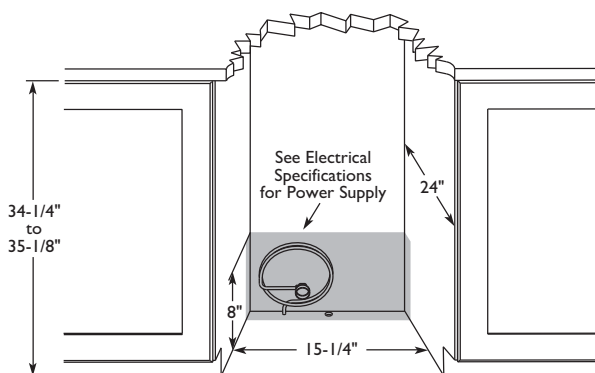

Follow the cut-out drawing. The 15-1/4" width allows 1/4" for ease in installation and removal of the unit. 24" is the cabinet depth in most installations.

## CO29 Series

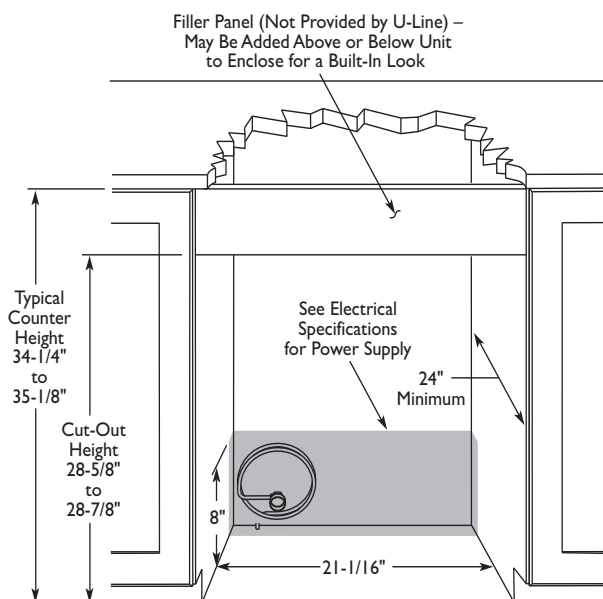

Follow the cut-out drawing. The 21-1/16" width allows 1/4" for ease in installation and removal of the unit. 24" is the counter depth in most installations. The unit is 24" deep including the door and handle.

### IMPORTANT

It is extremely important that this unit sits on a level surface, as it does not have feet levelers. If it is not level, the ice mold will not fill evenly.

## 5 Product Dimensions

### CLR2160 Series

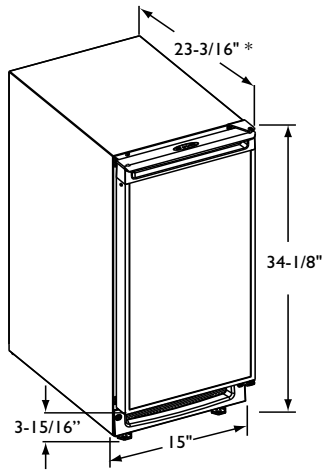

Black and White

\*Add 3/4" To Depth For Drain Line Clearance

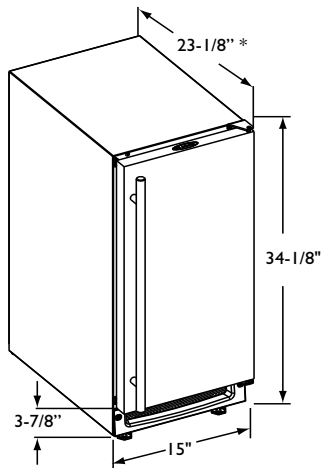

Stainless Steel

\*Add 3/4" To Depth For Drain Line Clearance

### CO1175 Series

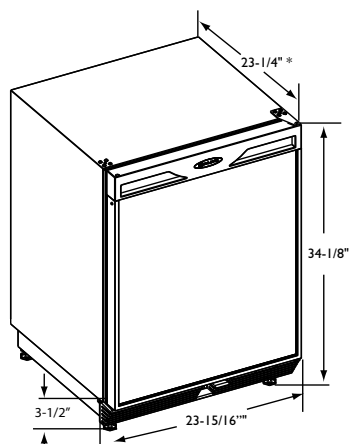

BLACK CO1175

\*Add 3/16" To Depth For Water Line Clearance

### CO1175 Series

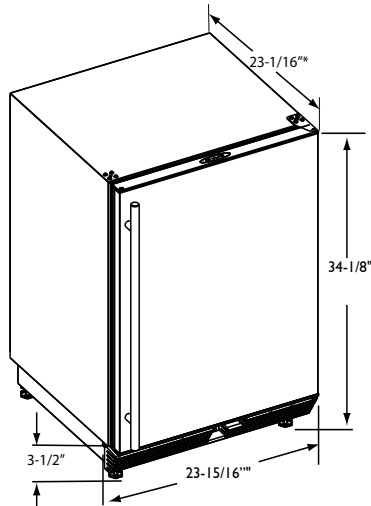

STAINLESS CO1175

\*Add 3/16" To Depth For Water Line Clearance

### CO2175 Series

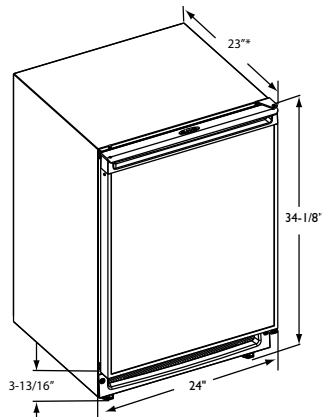

Black and White

\*Add 3/16" To Depth For Water Line Clearance

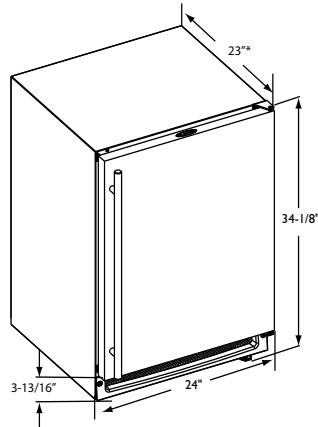

Stainless Steel

\*Add 3/16" To Depth For Water Line Clearance

### CO29 Series

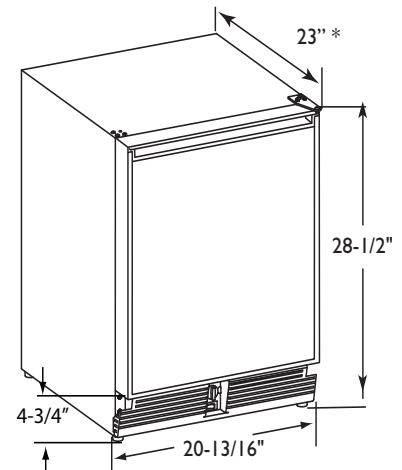

\*Add 15/16" To Depth For Water Line Clearance

### CLRCO2175 Series

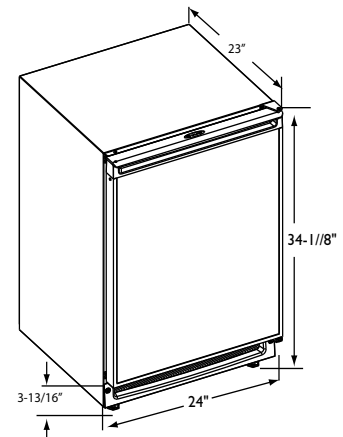

Black and White

\*Add 3/4" To Depth For Water Line Clearance

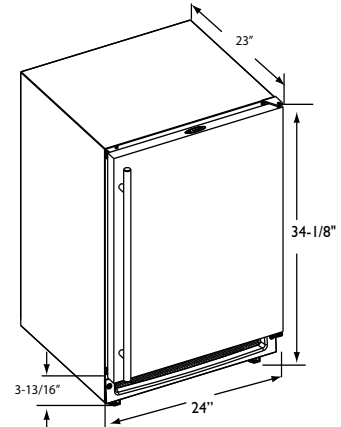

Stainless Steel

\*Add 3/4" To Depth For Water Line Clearance

## 6 Door Swing Dimensions

All units have a zero clearance for the door to open 90°. U-Line recommends a minimum door clearance of 2" to accommodate the handle if the unit is installed next to a wall.

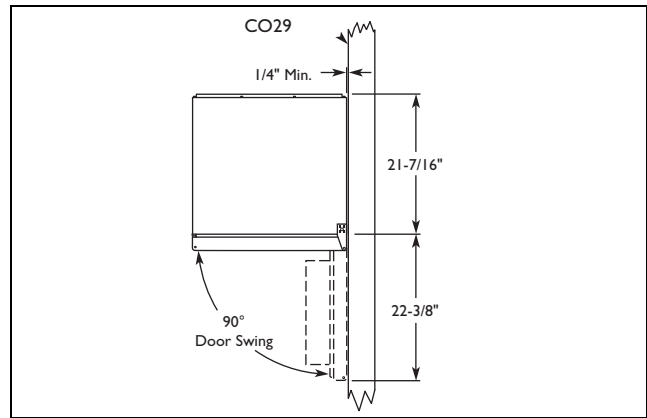
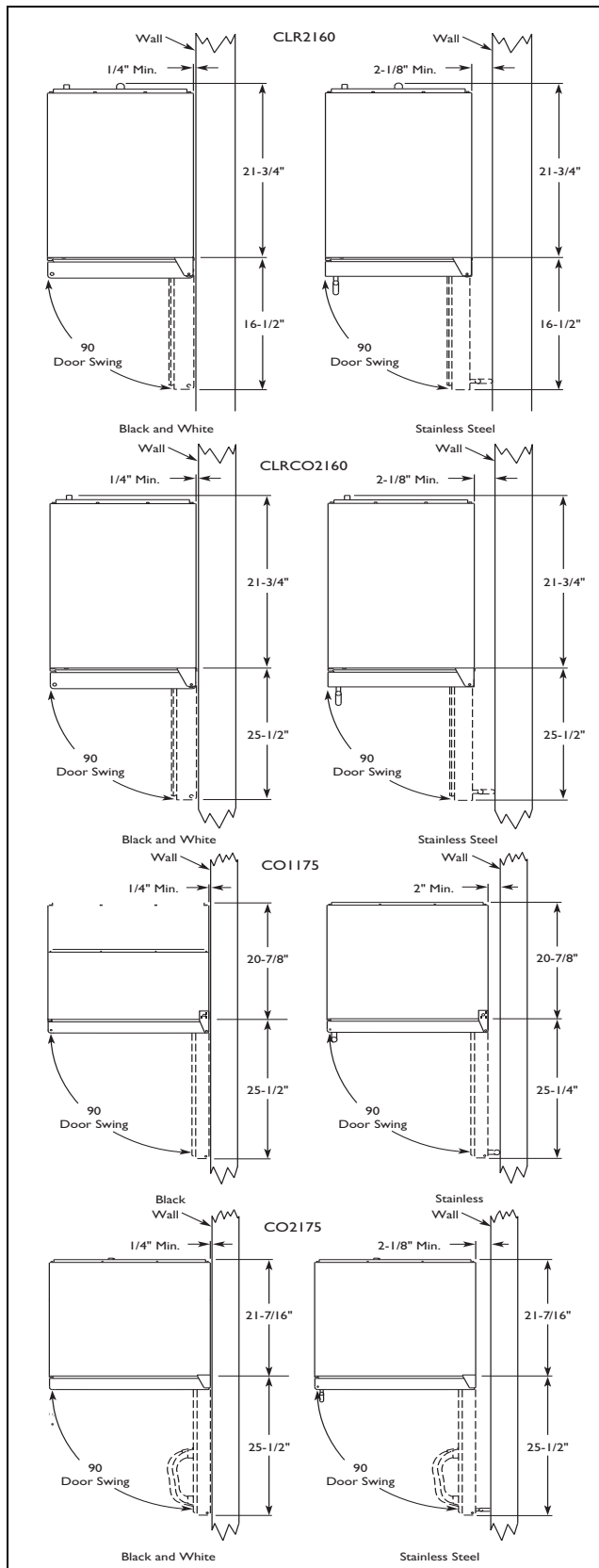

## Other Site Requirements

### Side-By-Side Installation

For a complete refreshment center, install two units side by side:

Cut-out width for a side-by-side installation is the total of the widths listed under Cut-Out Dimensions in each unit's Installation Guide.

No trim kit is required. However, 1/4-inch space needs to be maintained between the units to ensure unobstructed door swing.

Units must operate from separate, properly grounded electrical receptacles placed according to each unit's Electrical Specifications Requirements

### Power Supply

The unit requires a grounded and polarized 115 VAC, 60 Hz, 15A circuit (normal household current). See Electrical Specifications.

### Water Supply

The unit requires a 1/4" O.D. soft copper supply line, or flexible water supply kit from U-Line (Part No. WATERHOOKUP).

### Drain

The CLR2160 & CLR2160S require access to either a gravity or pump fed drain.

### Environmental Requirements

The units are designed to operate between 50°F (10°C) and 100°F (37°C). High ambient temperatures (100°F [37°C] or higher) may reduce the unit's ability to reach low temperatures and may also reduce the ice production rate for those models with ice makers.

If the ambient temperature is expected to drop below 45°F (7°C), drain all water from the unit to prevent freezing damage, which is not covered by the warranty.

For best performance, keep the unit out of direct sunlight and away from heat generating equipment.

In climates where high humidity and dew points are present, condensation may appear on outside surfaces. This is considered normal. The condensation will evaporate when the humidity drops.

CLR2160SOD Models: For best performance and life outdoors, place under a counter or provide shelter of some kind.

## 7 Standard Doors

### Door Alignment and Adjustment

Align and adjust the door if it is not level, or is not sealing properly. If the door is not sealed the unit may not cool properly, or excessive frost may form in the interior.

#### NOTICE

Properly aligned, the door's gasket should be firmly in contact with the cabinet all the way around the door (no gaps). Carefully examine the door's gasket to assure that it is firmly in contact with the cabinet. Also make sure the door gasket is not pinched on the hinge side of the door.

To align and adjust the door.

1. Loosen (do not remove) top and bottom hinge screws.
2. Align door squarely with cabinet.
3. Make sure gasket is firmly in contact with cabinet all the way around the door (no gaps).
4. Tighten bottom hinge screws.
5. Tighten top hinge screws.

### Door Reversability

(Does not apply to ADA or lock units)

Location of the unit may make it desirable to mount the door on the opposite side of the cabinet.

Models with black and white doors are field-reversible.

Stainless steel models with glass doors without locks are field-reversible. See the table at the front of this book for a summary of units that are reversible.

Stainless steel models without glass doors must be ordered right- or left-hand hinged.

### Reversing the Door

(Does not apply to ADA or lock units)

The hinge hardware will be removed and reinstalled on the opposite side of the cabinet.

The hinge plate is flipped over when it is reinstalled on the opposite side of the cabinet.

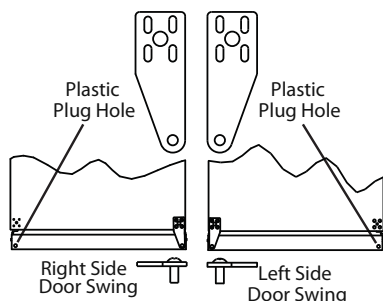

#### Remove grille.

Remove the grille, see MAINTENANCE section of this guide.

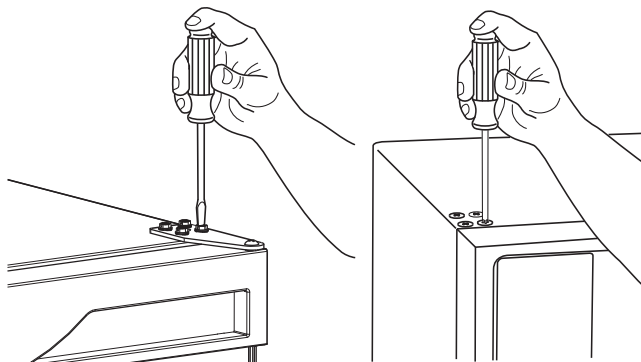

#### Remove top hinge, and door.

1. Hold door to keep it from falling.
2. Remove top hinge from cabinet by removing three or four screws, depending on model.
3. Remove door by tilting forward and lifting door off bottom hinge.
4. Remove three or four plastic screw plugs from hinge holes on the opposite side. Reinstall into holes where the hinge was removed. Ensure not to scratch cabinet.

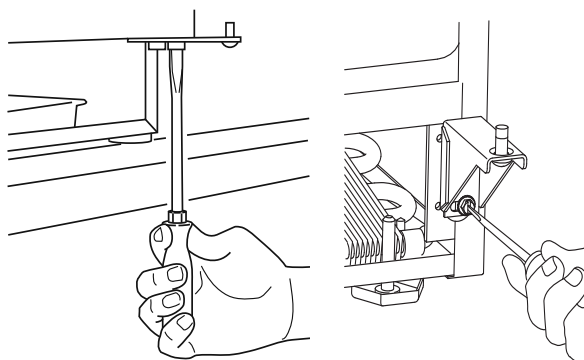

#### Remove bottom hinge.

1. Remove bottom hinge from cabinet. Some models will have a gusset with two screws. Other models will have a plate with three screws.
2. Remove corresponding screws on opposite side of cabinet. On some models there may be a nut behind one or both screws on either side.



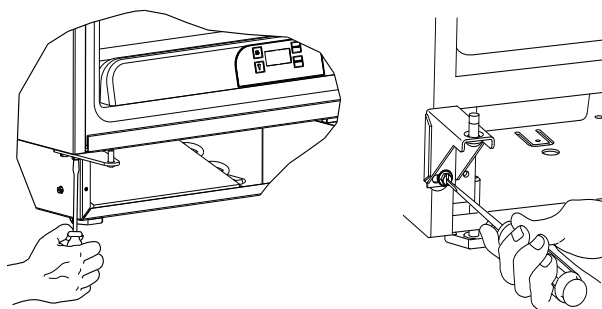

**Install bottom hinge.**

1. If you have a plate hinge, reorient the pivot screw so it protrudes the opposite direction from the hinge. Remove the pivot screw from the hinge. Turn the plate over and reinstall the screw.
2. Align hinge outer edge with cabinet. For models with a plate hinge, the flat edge of the hinge aligns with the outer edge of the cabinet.

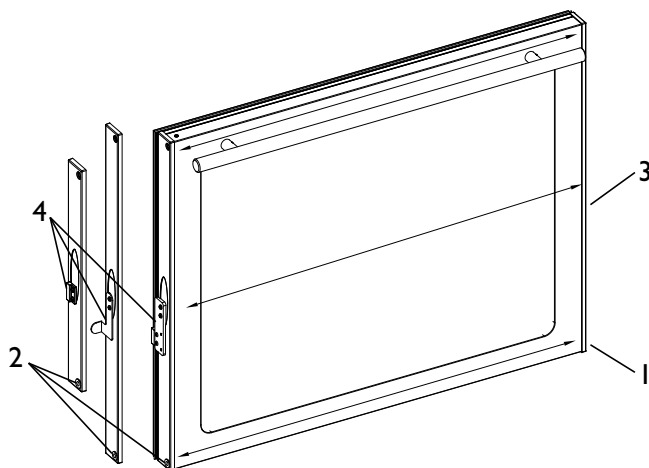
Install two or three screws, depending on model. Replace nuts if used.

**Prepare door for reinstallation.**
**For stainless steel models with glass doors:**

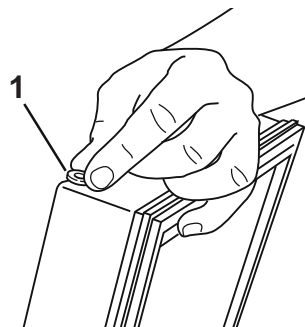
1. Stainless glass doors are flipped upside down to be reversed.
2. Lay the door on its side. Remove the plastic hole plug (1) and install in the corner opposite of where it was removed.
3. Remove the plastic hinge bushing (2) and install in the corner opposite of where it was removed.
4. Remove the U-Line nameplate (3) from door. This will reveal mounting holes for the door actuator bracket.
5. Remove door actuator (4) from door. Be sure to only remove the two screws holding the actuator to the door. Reinstall the actuator (4) on the opposite end of the door where the nameplate was removed.
6. Install new nameplate where the actuator assembly was removed.
7. Install screws into holes on opposite side, where the hinge was removed. Replace nuts if used.

**Prepare door for reinstallation.**
**For black or white doors:**

1. Remove plastic hinge bushing on bottom of door and reinstall on opposite side. Clean out bushing hole in door bottom with a screwdriver if necessary.

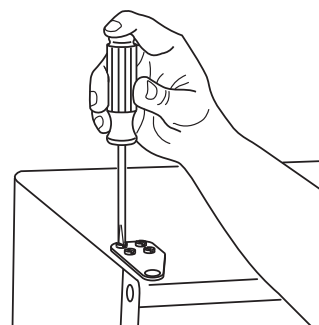
**Install top hinge and door.**

1. Reorient the pivot screw so it protrudes the opposite direction from the hinge. Remove the pivot screw from the hinge. Turn the plate over and reinstall the screw.
2. Hold door to keep it from falling.
3. Lift the door onto the bottom hinge.
4. Align flat edge of the top hinge with the outer edge of the unit.
5. Install three or four screws, depending on model.

**Align and adjust the door.**

1. Align and adjust the door, see DOOR ALIGNMENT AND ADJUSTMENT.

**Install grille.**

Install the grille, see MAINTENANCE section of this guide.

## 8 Doors (Self Closing)

### Door Alignment and Adjustment

Align and adjust the door if it is not level, or is not sealing properly. If the door is not sealed the unit may not cool properly, or excessive frost may form in the interior.

#### IMPORTANT

- Properly aligned, the door's gasket should be firmly in contact with the cabinet all the way around the door (no gaps). Carefully examine the door's gasket to ensure that it is firmly in contact with the cabinet. Also make sure the door gasket is not pinched on the hinge side of the door.
- The door will not be flush with the top of the cabinet. The top edge of the door will be 1/8 in. (3.175 mm) below the cabinet top.

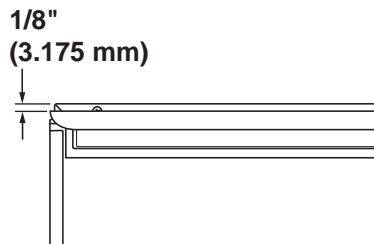

#### To align and adjust the door:

1. Compare the top edge of the door (opposite the hinges) to the top edge of the cabinet and note the type (up or down) of adjustment needed.

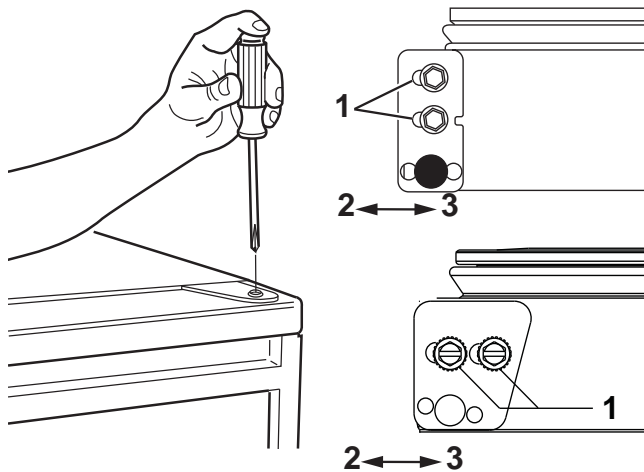

2. Remove the top hinge pivot pin with a Phillips screwdriver and lift door off bottom hinge pin. Be careful not to lose the door closer insert sets.
3. Turn the door upside down and inspect the hinge plate mounting holes. The plate has slotted mounting holes. Loosen but do not remove the two hinge plate screws(1).
4. If door edge opposite the hinges needs to move up, move plate toward outside of door(2). If door edge needs to move down, move plate toward inside of door(3). Repeat until top edge of

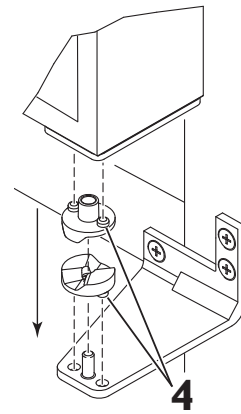

door is parallel with top of cabinet and tighten screws (1) securely.

5. After adjustment is complete, remove the door closers from the bottom hinge, clean thoroughly and apply petroleum jelly to the mating surfaces of the closers. Be sure that pins on closers align with holes in the door and bottom cabinet hinge plates. Mount door and install top hinge pivot pin.

### Door Reversability

Location of the unit may make it desirable to mount the door on the opposite side of the cabinet. Many doors are reversible. See table below.

Model	Reverse	Model	Reverse
U-2115RB-00	YES	U-2175WCCOL-02	YES
U-2115RS-00	NO	U-2175WCCOL-60	YES
U-2115RS-01	NO	U-2175WCCS-00	YES
U-2115RS-02	NO	U-2175WCCS-02	YES
U-2115RSOD-00	NO	U-2175WCCS-13	YES
U-2115RSOD-01	NO	U-2175WCCS-22	YES
U-2115RW-00	YES	U-CLR2160B-00	YES
U-2115WCOL-00	YES	U-CLR2160B-40	YES
U-2115WCS-00	YES	U-CLR2160S-00	NO
U-2175BEVCOL-00	YES	U-CLR2160S-01	NO
U-2175BEVCOL-02	YES	U-CLR21060S-40	NO
U-2175BEVCOL-60	YES	U-CLR2160S-41	NO
U-2175BEVCS-00	YES	U-CLR2160SOD-00	NO
U-2175BEVCS-02	YES	U-CLR2160SOD-01	NO
U-2175RCB-00	YES	U-CLR2160SOD-40	NO
U-2175RCB-02	YES	U-CLR2160SOD-41	NO
U-2175RCGOL-00	YES	U-CLR2160W-00	YES
U-2175RCGS-00	YES	U-CLR2160W-40	YES
U-2175RCS-00	NO	U-CLR2175B-00	YES
U-2175RCS-01	NO	U-CLR2175B-40	YES
U-2175RCS-22	NO	U-CLR2175S-00	NO
U-2175RCW-00	YES	U-CLR2175S-01	NO
U-2175RSOD-00	NO	U-CO2175FS-01	NO
U-2175RSOD-01	NO	U-CO2175FW-00	YES
U-2175WCCOL-00	YES		

## Reversing Black or White Doors

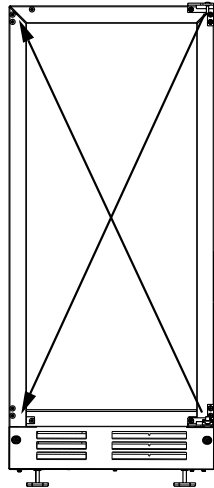

- The Hinge hardware will be removed and reinstalled on the opposite side of the cabinet.
- The top hinge hardware will be reinstalled on the bottom of the opposite side of the cabinet.
- The bottom hinge hardware will be reinstalled on the top of the opposite side of the cabinet.

### Remove Door

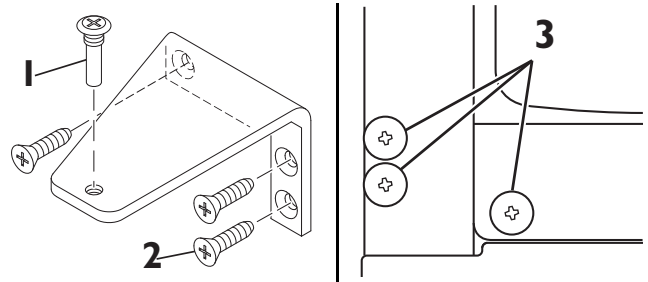

1. Hold door to keep it from falling.
2. Remove hinge screw pin (1) from top hinge using a Phillips screwdriver.
3. Remove door by tilting forward and lifting door off bottom hinge closer inserts.
4. Reinstall hinge screw pin (1) into top hinge using a Phillips screwdriver.

### Remove hole plugs.

Remove plastic screw plugs (three each, top and bottom) (3) from new hinge location. Save for reinstallation later.

### Remove existing top hinge.

Remove existing top hinge (three screws) (2).

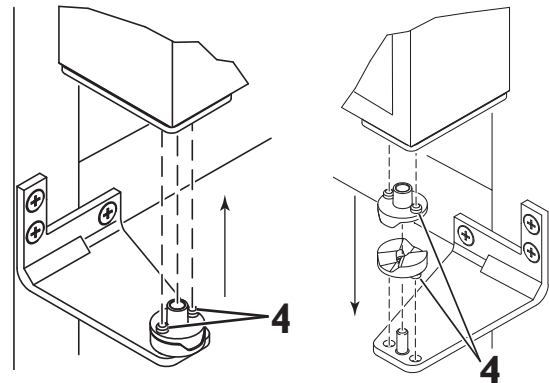

### Reinstall hinge to bottom opposite.

1. Install the hinge just removed from the top to the BOTTOM opposite side of the cabinet (three screws) (2).
2. Remove the two door closer inserts (4) from the existing bottom hinge.
3. Install door closer inserts as shown on the new bottom hinge (4).

### Remove preexisting bottom hinge.

1. Remove the preexisting bottom hinge (three screws) (2).

### Reinstall hinge to top opposite.

1. Install the hinge just removed from the bottom to the TOP opposite side of the cabinet (three screws) (2).

### Reinstall Hole Plugs.

1. Install plastic screw plugs (three each, top and bottom) (3) into holes where hinge hardware was removed.

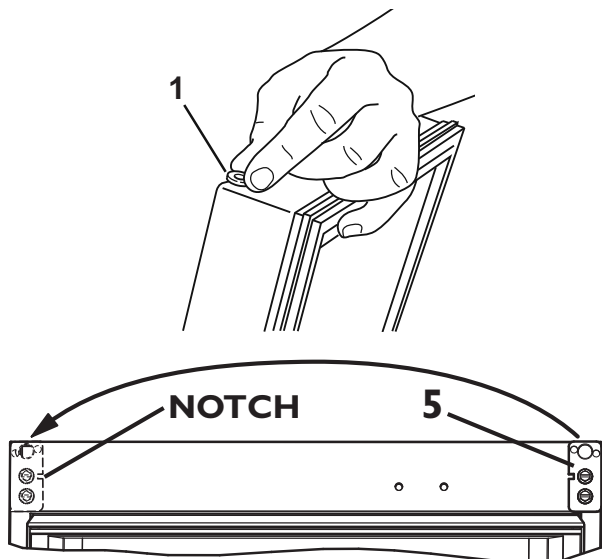

### Prepare door for reinstallation.

1. Remove plastic hole plug from top of door handle and reinstall on opposite side.
2. With bottom of door facing up, remove pivot plate (5) (two screws).
3. Flip over and install pivot plate on opposite side of door. Ensure notch in plate faces center.

### Install Door.

1. Hold door upright and tilted forward.
2. Lift door on to bottom hinge closer inserts.
3. Tilt door forward into position.
4. Hold door to keep it from falling.
5. Reinstall hinge screw pin (1) into top hinge using a Phillips screwdriver.

### Align and adjust the door:

Align and adjust the door, see DOOR ALIGNMENT AND ADJUSTMENT on page 8.

## Reversing Stainless Steel Glass Doors

### Remove Door

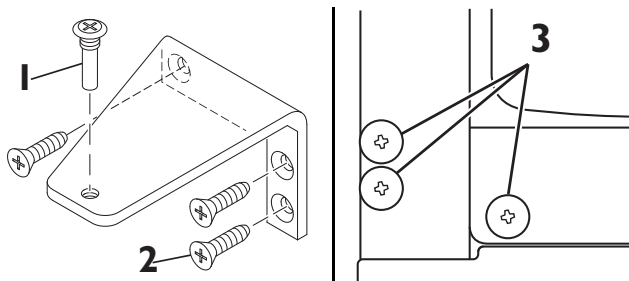

1. Hold door to keep it from falling.
2. Remove hinge screw pin (1) from top hinge using a Phillips screwdriver.
3. Remove door by tilting forward and lifting door off bottom hinge closer inserts.
4. Reinstall hinge screw pin (1) into top hinge using a Phillips screwdriver.

### Remove hole plugs.

1. Remove plastic screw plugs from (three each, top and bottom) (3) from new hinge location. Save for reinstallation later.

### Remove Stainless Frame

1. Remove two screws from top of door. Save screws for later installation.

Top Of Door

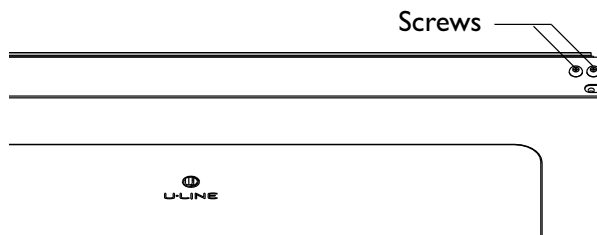

2. Remove pivot plate from bottom of door by removing 2 screws. Set pivot plate and screws aside for later installation.

Bottom Of Door

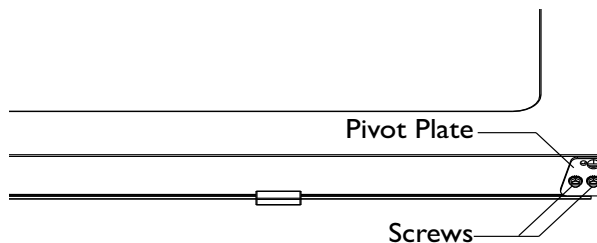

3. Grasp outer edge of stainless frame and firmly press inside edge of glass in while pulling stainless frame in opposite direction.

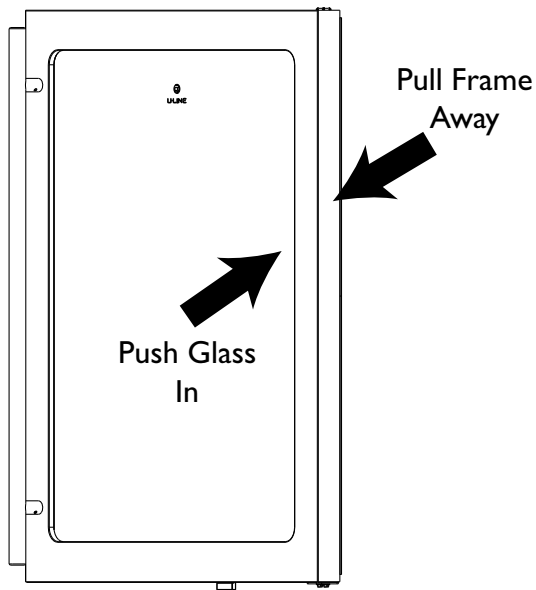

4. Unhinge frame from door.

#### Assemble Stainless Frame

1. Prop frame against solid surface, handle side down and away
2. Insert door, logo forward, into frame at a 30° angle. For a right hand hinge the logo should be to your right. For a left hand hinge the logo should be to your left.

Door Orientation Right Hand Hinge

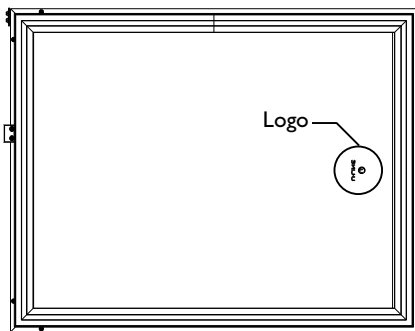

Door Orientation Left Hand Hinge

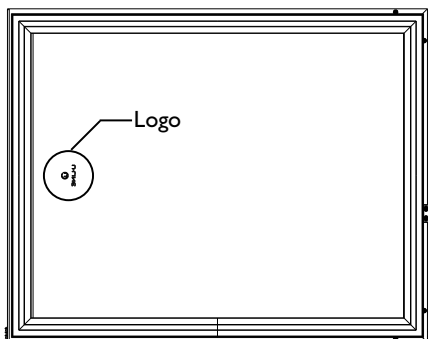

3. Swing door into frame.
4. Install screws removed in "Remove Stainless Frame" step 1 to top of door, opposite handle.
5. Install pivot plate to bottom of door, opposite of handle, using hardware removed in "Remove Stainless Frame" step 2. Arrange pivot plate so the flat edge is against the edge of the door.

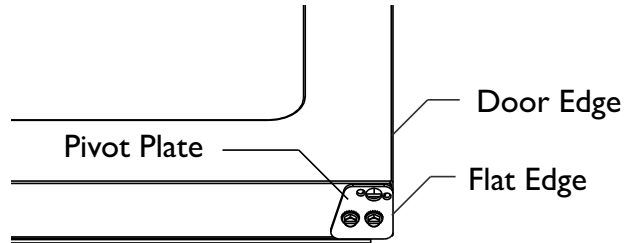

#### Orient Hinge

1. Remove existing top hinge (three screws) (2).

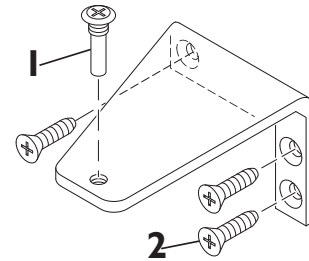

#### Reinstall hinge to bottom opposite.

1. Install the hinge just removed from the top to the BOTTOM opposite side of the cabinet (three screws) (2).
2. Remove the two door closer inserts (4) from the preexisting bottom hinge.

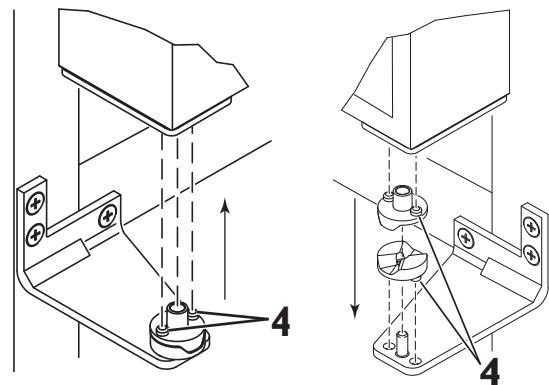

3. Install door closer inserts as shown on the new bottom hinge (4).

**Remove existing bottom hinge.**

1. Remove the existing bottom hinge (three screws) (2).

**Reinstall hinge to top opposite.**

1. Install the hinge just removed from the bottom to the TOP opposite side of the cabinet (three screws) (2).

**Reinstall Hole Plugs.**

1. Install plastic screw plugs (three each, top and bottom) (3) into holes where hinge hardware was removed.

**Install Door.**

1. Hold door upright and tilted forward.
2. Lift door on to bottom hinge closer inserts.
3. Tilt door forward into position.
4. Hold door to keep it from falling.
5. Reinstall hinge screw pin (1) into top hinge using a Phillips screwdriver.

**Align and adjust the door:**

Align and adjust the door, see DOOR ALIGNMENT AND ADJUSTMENT on page 8.

## 9 Door Panel Installation

### Custom 1/4" Thick Door Panel Insert

#### Door Panel Preparation

A custom door panel may be inserted into the doorframe. Custom door panels can be flat or raised, as long as the maximum panel thickness, where inserted into the door reveal (channel), is no more than 1/4" thick. For raised panels, the depth of the reveal is 1/4" on all four sides.

#### IMPORTANT

**Raised panels will reduce the door's 90° swing/zero clearance if the unit is installed next to a wall or similar type of structure.**

#### Panel Dimensions.

The door panel must not weigh more than 20 lbs.

Model	Width	Height
CLRCO2175	23 1/32"	27 11/16"
CLR2160	14 1/32"	27 11/16"
CO1175	22 15/16"	26 15/16"
CO29	19 13/16"	21 13/32"
CO2175	23 1/32"	27 11/16"

#### Door Panel Installation

Install the insert as follows:

#### CAUTION

**Use care when handling the insert. Insert edges may be sharp.**

1. Remove top hinge screw pin with Phillips head screwdriver. Remove door by tilting forward and lifting off bottom hinge pin.

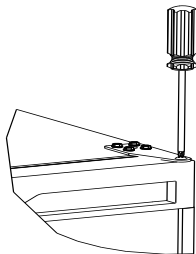

2. Pull door gasket out of groove (top edge of door only). Start in the middle and pull outward, moving toward the edge. This may take some force.

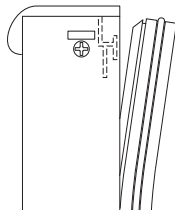

3. Remove the two outside screws holding door handle. Slightly separate door handle from door.
4. Pull handle up and off.
5. Slide custom door panel insert into 1/4-inch channel in door front.

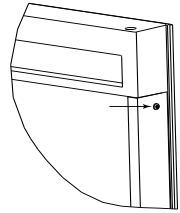

#### IMPORTANT

**Use care not to damage magnet, located on door bottom, when installing door insert. Do not set door on bottom edge when pushing insert into place.**

6. Holding door gasket out of the way, replace handle on door, making sure it is seated properly on insert and that screw holes line up.
7. Install two small screws removed in **Step 3**.
8. Starting at the corners and working inward, push door gasket into place on door.
9. Place door on bottom hinge pin and install upper hinge screw.

## 10 Wood Grille Overlay

### Grille Overlay (Excludes COI175)

Your models grille is designed to accept a wood grille overlay. An overlay may be used to compliment a door overlay and provides a seamless look for your surrounding decor. Follow the instructions below to prepare and install your grille overlay. Be sure to read over this chapter completely before beginning.

#### Preparation

#### WARNING

The grille overlay **MUST** have venting as shown in the drawing below. Failure to have proper venting can result in damage to your model.

#### WARNING

The grille overlay may only be installed on indoor units.

1. Prepare your overlay using the dimensions provided in the figure on page 15 for 24 inch models and page 16 for 15 inch models. If using a hook and loop style mount, drill hole A will not be used.
2. If desired, stain and finish your grille to match your surrounding decor. Follow the stain manufacturers instructions to apply stain to your overlay.

#### Installation

#### IMPORTANT

The wood overlay grille must be installed in such a manner that the grille assembly can still be removed from the unit.

##### Screw Mount (Recommended)

1. Remove the grille from your unit by removing the two mounting screws. See below.

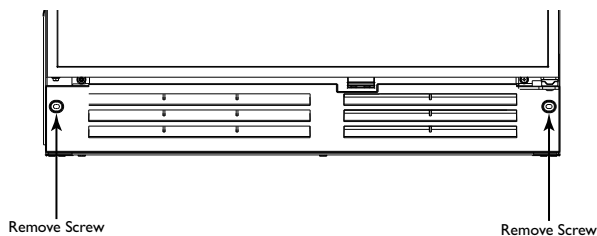

2. Lay the back of your grille overlay onto the front of the grille. Make certain the screw holes and vents are aligned.
3. Slide each of the screws removed in step 1 through the grille overlay and grille.
4. Mount your new overlay onto your unit by screwing the overlay back onto the base of your unit.

##### Hook and Loop Fastener Mount

You may also mount your overlay to your grille using hook and loop type fasteners. U-Line recommends using 3M® Dual lock® fasteners. To mount your overlay using a hook and loop fastener follow the instructions below.

1. Read the instructions provided with your hook and loop fastener carefully.
2. Apply hook and loop fastener system to the back of the overlay and front of the grille. Use the shaded areas in the diagram below for application location.

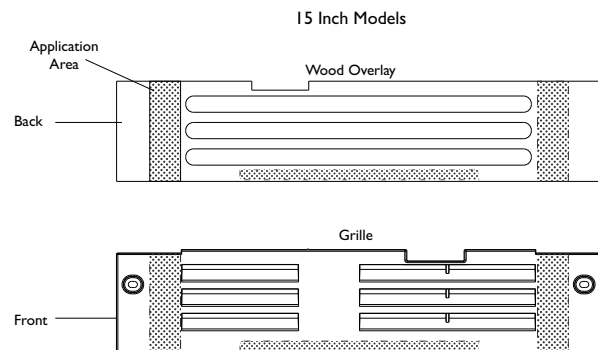
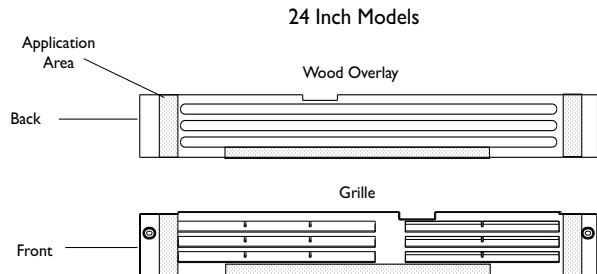

3. Carefully align the wood overlay with the grille and press into position.



# Grille Overlay Dimensions 24 Inch Models

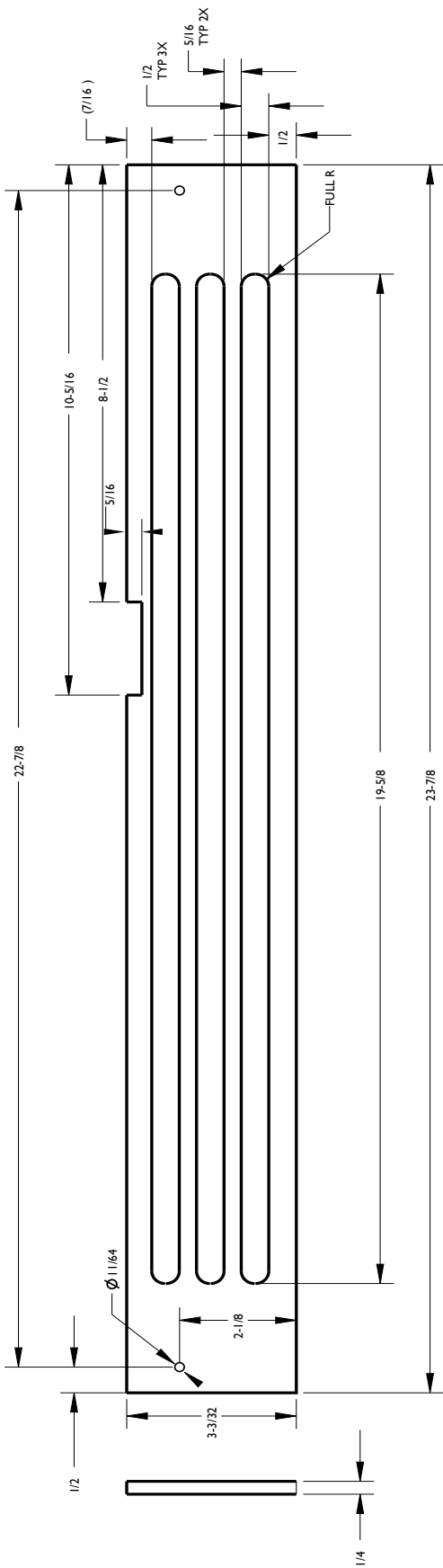

# Grille Overlay Dimensions 15 Inch Models

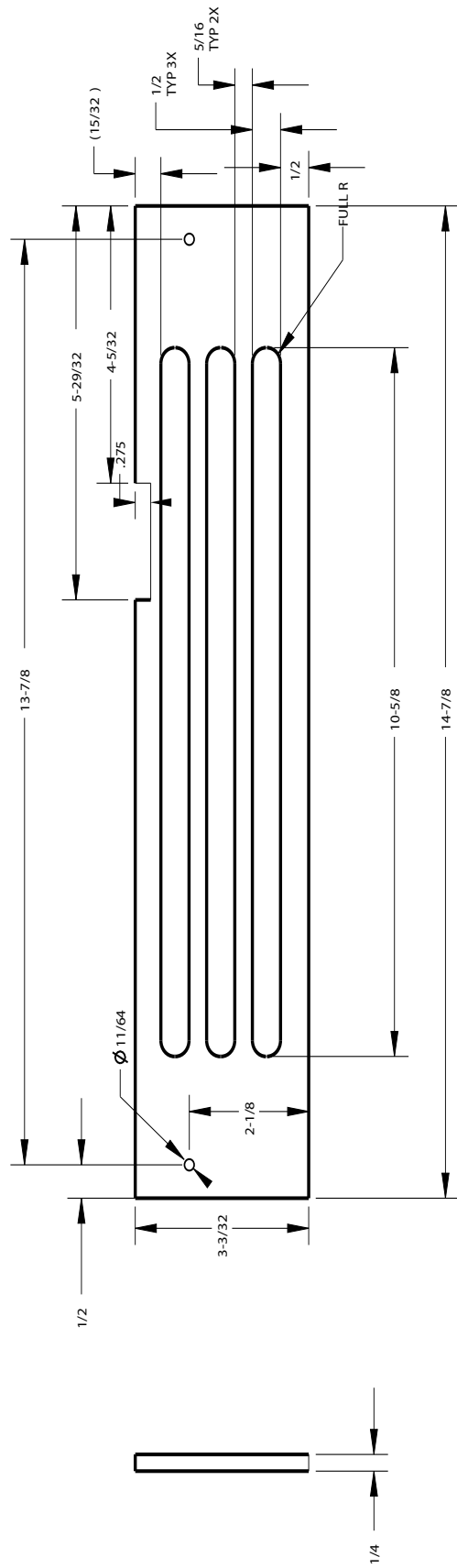

## II Prepare Power Supply

### Electrical Specifications

#### WARNING

##### **SHOCK HAZARD — Electrical Grounding Required.**

- Never remove the round grounding prong from the plug and never use a two-prong grounding adapter.
- Never use an extension cord to connect power to the unit.

#### **IMPORTANT**

Electrical installation must observe all state and local codes. This unit requires connection to a grounded (three-prong), polarized receptacle that has been placed by a qualified electrician.

The unit requires a grounded and polarized 115 VAC, 60 Hz, 15A power supply (normal household current). An individual, properly grounded branch circuit or circuit breaker is recommended. GFCI (ground fault circuit interrupter) is usually not required for fixed location appliances and is not recommended for your unit because a GFCI could be prone to nuisance tripping. However, be sure to consult your local codes.

See below for recommended receptacle location

#### **CLR2160 & CLR2175**

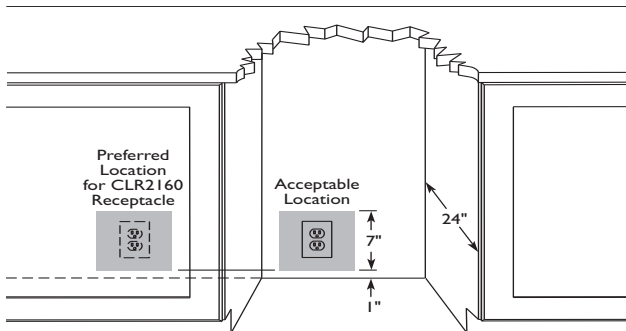

#### **CO29**

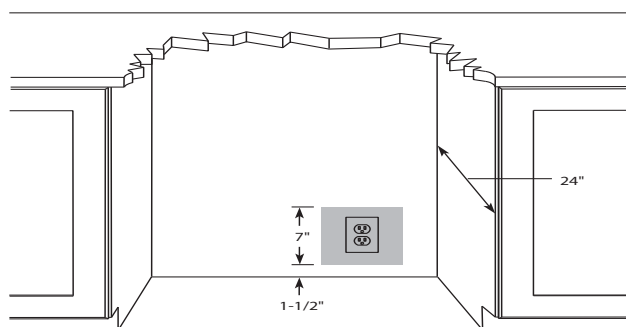

#### **CO1175**

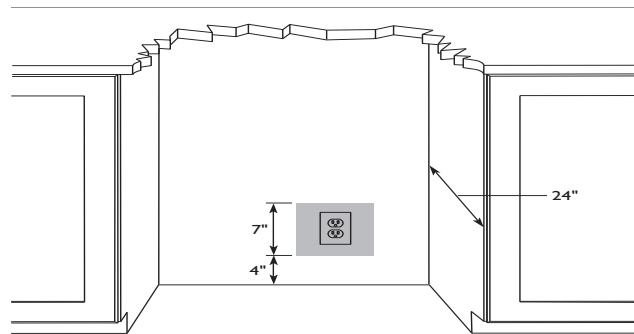

#### **CO29**

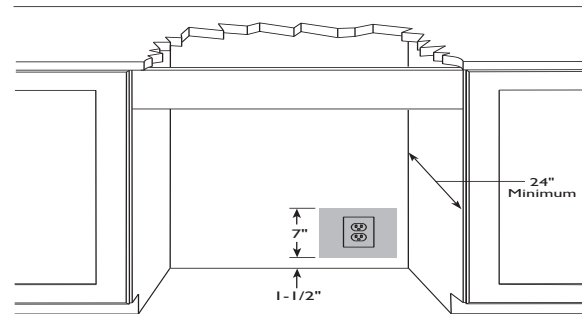

#### **CO2175FF**

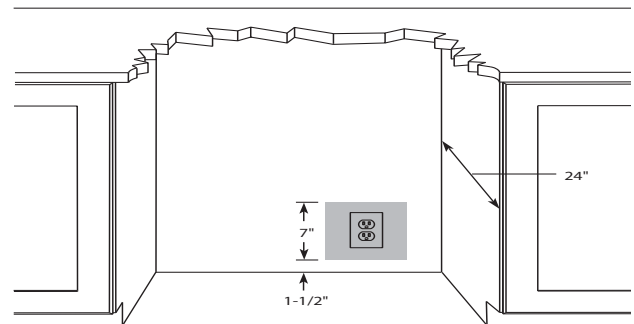

## 12 Prepare Plumbing

### WARNING

Prior to attempting installation, determine if this product contains a gravity style drain or factory installed drain pump. Products without a drain pump may only use a gravity style drain. Failure to connect water supply or drain line connections properly may result in water leakage, personal injury, and/or property damage. Disconnect power and turn off water to the unit before attempting to alter these connections. Please consult U-Line or your installation instructions for further details. These connections are the responsibility of the owner and must be connected per local plumbing code. If you are uncertain of how to safely and properly install this product, contact a licensed plumber.

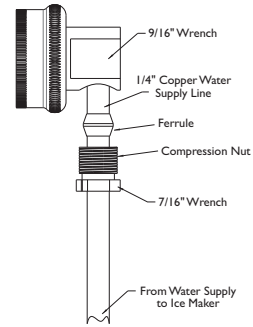

### Water Connections:

### CAUTION

Review, obey, and understand the local plumbing codes before you install your unit. Connect to the cold water supply. The water pressure should be between 20 and 120 psi. The water line **MUST** have a shut-off valve on the 1/4" supply line.

### IMPORTANT

- U-Line requires the use of copper tubing for installation or the U-Line water hookup kit available at [www.u-line.com](http://www.u-line.com). This kit includes a flexible water supply connecting hose and brass fitting.
- Do not use any plastic water supply line. The line is under pressure at all times. Plastic may crack or rupture with age and cause damage to your home.
- Do not use Teflon tape or joint compound on the water fitting. The rubber washer provides an adequate seal. Other materials could cause blockage of the valve.

### Copper Water Supply Connection:

### CAUTION

Turn off water supply and disconnect electrical supply to unit prior to attempting installation

1. Turn off water supply and disconnect electrical supply to product prior to attempting installation.
2. Locate the desired cold water supply location.
3. Attach a 1/4" copper line to this location and route the tubing to the appliance. Leave approximately 8' of water line to be coiled behind the appliance. The water line should be looped into 2 coils. This will allow the line to flex when removing the unit for cleaning and service. Do not kink or pinch the coiled line.
4. Locate the U-Line supplied hose fitting. Ensure the end on the copper tubing has been cut straight and is free of burrs. Slide the compression nut and ferrule onto the copper tubing as shown below.

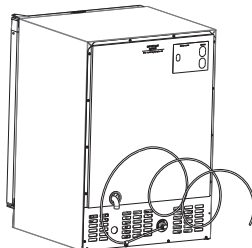

5. Push the assembly completely into the garden hose fitting and tighten.
6. Attach the copper water line to the back of the unit using the supplied clamp and the back panel screw. This will prevent rotation of the line when moving the unit.
7. Turn on water and check for leaks.

## U-Line Water Hookup Kit Connection:

### CAUTION

**Turn off water supply and disconnect electrical supply to unit prior to attempting installation**

1. Locate the desired cold water supply location.
2. Attach the garden hose connection from the kit to the rear of the unit using 2 pliers.
3. Attach the braided line to this location and route the tubing to the appliance. Leave approximately 4' of water line to be coiled behind the appliance. The water line should be looped into 2 coils. This will allow the line to flex when removing the unit for cleaning and servicing. Do not kink or pinch the coiled line.
4. Turn on water supply and check for leaks.

## Drain Connection:

### CAUTION

If your U-Line unit did not come with a factory installed drain pump you must use a gravity style drain connection.

For assistance in determining if your unit has a pump please contact U-Line. The floor drain must be large enough to accommodate drainage from all attached drains. Follow these guidelines when installing drain lines to prevent water from flowing back into the ice maker storage bin and/or potentially flowing onto the floor, which may result in personal injury or property damage.

### IMPORTANT

**Drain can NOT be located directly below the unit. Unit has a solid base that will not allow the unit to drain below itself.**

### IMPORTANT

**There is a possibility that hose connections may have loosened during shipment.**

## Gravity Drain:

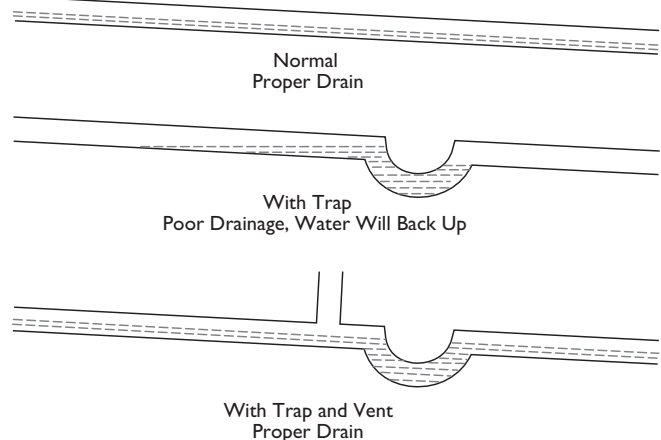

### A gravity drain may be used if:

- Drain line has at least a 1" drop per 48" of run (1/4" per foot).
  - Drain line does not create traps and is vented per local code.
1. Cut the pre-installed drain tube to length.
  2. Connect to your local plumbing per the local code.
  3. If necessary, insulate drain line to prevent condensation.
  4. Test the drain system per the test procedure under "Final Installation" on page 21.

## WARNING

Failure to connect water supply or drain line connections properly can result in personal injury and property damage. Gravity drain connections must be routed downward from the rest of the unit at the rate of 1/4" per foot.

### Factory Installed Drain Pump

- If your drain line will run up to a stand pipe, disposal or spigot assembly, or does not otherwise meet the requirements for a gravity drain, you may have ordered the CLR2160 or CLR2175 with a pre-installed U-Line P60 drain pump.
- If you need to install a P60 drain pump into your unit, see Locally Installed Drain Pump on pg 21.
- See below for typical installations requiring a drain pump.

Stand Pipe  
P60 Pump Required

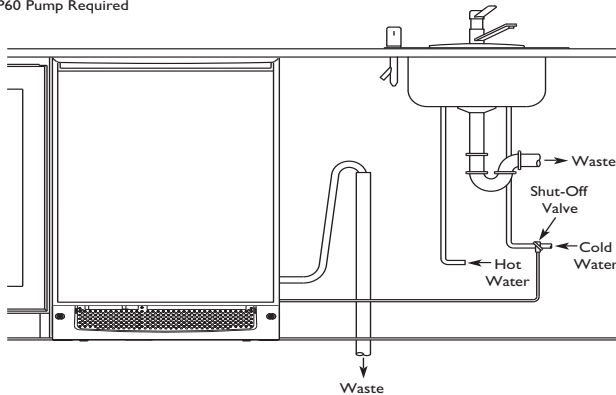

Disposal Assembly  
P60 Pump Required

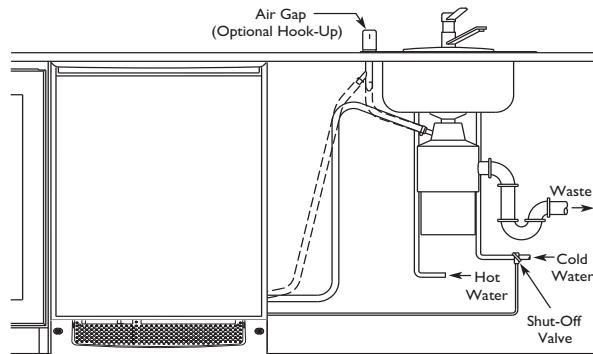

Y-Branch Tailpiece  
P60 Pump Required

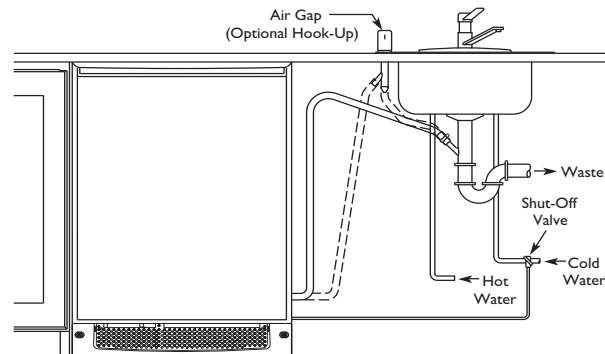

## IMPORTANT

The maximum lift for the P60 drain pump is 10 feet. This must be done as close to the rear of the unit as possible.

## IMPORTANT

Before installing your U-Line CLR2160 or CLR2175 with factory-installed U-Line P60 pump, it is extremely important to check and test all hose connections at the drain pump.

### Test Hose Connections:

1. Place a suitable container beneath the pump's discharge tube. The container must be able to hold a minimum of one gallon.
2. Plug the ice maker power cord into a properly grounded, polarized electrical outlet.
3. Place the unit into OFF mode by holding the power key for 10 seconds. Failure to power down the ice maker will cause it to begin a fill cycle which will run for 3 minutes.
4. Verify pump operation by pouring one gallon of water into the ice storage bin of the ice maker. The pump should energize and pump the water into the container.
5. At this time, verify that all tube and clamp connections are tight and leak-free.
6. Unplug unit power cord from electrical outlet.

## Drain Connection:

---

### WARNING

---

To prevent accidental electrocution and / or slipping make certain the floor surfaces surrounding the unit are dry at all times.

---

### IMPORTANT

---

**There is a possibility that hose connections may have loosened during shipment.**

1. Route pre-installed drain tube and cut to length. Connect to local plumbing per code. Common fittings and clamps have been included for your convenience. Avoid dips or sags in the drain line and ensure the maximum lift is under 10'.
2. Insulate the drain line, if necessary to prevent condensation.
3. Test the drain system per the test procedure under "Final Installation" on page 21.

### Locally Installed Drain Pump:

If a gravity drain connection is not possible, and you have not purchased a CLR2160 or CLRCO2175 without a factory installed pump, we strongly recommend the use of the U-Line P60 drain pump.

The U-Line P60 drain pump is available through your dealer, with complete installation instructions.

## Final Installation

---

### IMPORTANT

---

**In the event of a power outage, restricted drain or pump failure, the failure to use the U-Line P60 drain pump could result in substantial water leakage and pooling with severe and costly water damage and related consequential damages and harm.**

1. Plug in unit and put into OFF mode by holding the power key for 10 seconds.
2. Turn on the water supply and ensure the connections are free of leaks.
3. Pour 1 gallon of water into the bin and ensure all the connections and fittings are free from leaks.
4. Begin to push the appliance into the desired cabinet opening. The copper tubing should remain in 2 coils behind the unit.

---

### IMPORTANT

---

**Normal operation creates some vibration. A water supply line contacting the cabinet may cause excessive noise during operation, or damage the line. Make certain the water line is not in contact with the cabinet.**

5. While pushing the unit into the opening, continuously reroute the drain tube and water line to avoid kinks. The most common installation pulls the slack into an adjacent cabinet or basement area.
6. When installation is complete and unit is secured in the opening pour 1 gallon of water into the unit and ensure the water drains from the bin and there is no water leakage in and around product.

---

### IMPORTANT

---

**Failure to properly perform the installation of water supply and drainage connections may result in water leakage, which can damage the unit, damage other property and result in personal injury through electrocution and/or slips and falls. As a result, failure to properly install and connect the water supply and drainage connections shall serve to void U-Lines warranty on the supplied equipment. In no event shall U-Line be responsible for direct, indirect, incidental, consequential or any other damage arising from improper water supply and drain installation and/or connections.**

## 13 Level The Unit

### Leveling Information

It is recommended that the unit is level.

1. Use a level to check the levelness of the unit from front to back and from side to side. Level should be placed along top edge and side edge as shown

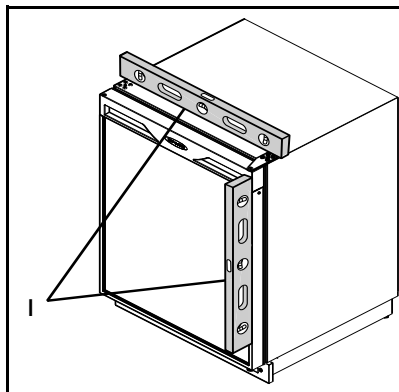

2. If the unit is not level, adjust the feet on the corners of the unit as necessary (not available in CO29 models).

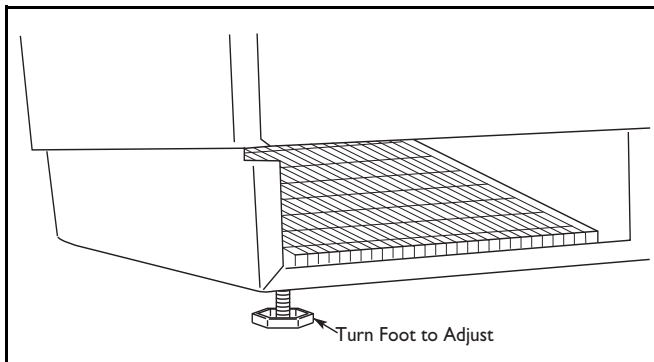

3. Check the levelness after each adjustment and repeat the previous steps until the unit is level.

### INSTALLATION TIP

If the room floor is higher than the floor in the cut-out opening, adjust the rear feet to achieve a total unit rear height of 1/8" less than the opening's rear height. Shorten the unit height in the front by adjusting the front feet. This allows the unit to be gently tipped into the opening. Readjust the front feet to level the unit after it is correctly positioned in the opening.

## 14 Install the Unit

### Installation

1. Open the water supply valve in the main water source.
2. Plug in the power cord.

#### CLR2160 & CLRCO2175 Only

- Open the door and press the POWER icon, to turn the unit OFF.

Note: If the unit is NOT turned OFF, water will immediately start flowing into the unit when it is first plugged into the electrical outlet.

- Test the drain system by pouring one gallon of water into the ice bin. The water should drain freely and there should be no leakage.

#### All Models

3. Gently push the unit into position. Be careful not to kink the water supply line or entangle the electrical cord.
4. Re-check the leveling, from front to back and side to side. Make any necessary adjustments. The unit's top surface should be approximately 1/8" below the counter top.
5. Remove the tape from the glass shelves and wipe out the inside of the unit with a clean, water-dampened cloth.

### Relocating the Shelves

Both the glass shelves in the refrigerator and the inner door shelves can be moved to accommodate your bottles, cans and containers.

#### Glass Shelves on Right-Hand Hinge Units

- Open door fully, grasp shelf firmly, lift front edge slightly, and pull straight out.
- Choose new location and slide shelf onto the appropriate rib.

#### Glass Shelves on Left-Hand Hinge Units

- Pull shelf out about 6" to clear the wall's molded protrusion.
- Tilt right-hand edge of shelf up.
- Keeping at this angle and hugging the right wall, pull the shelf out.
- Choose new location and insert over ribs, tilting right-hand edge up. Push in, then lower shelf onto ribs.

#### Door Shelves

- First pull shelf up at a 45° angle, then straight out (see Figure 39).
- Choose new location and line up on bosses. First push straight in, then down at a 45° angle.



## Installation Troubleshooting

### **Q:** Problem

Water is leaking under the unit.

### **A:** Solution

A water leak under the unit is most likely caused by a bad connection in the water supply line. Make sure the water line's brass fitting is screwed tight to its valve and threaded correctly.

### **Q:** Problem

The door remains open unless it is pushed closed.

### **A:** Solution

The hinges should be self-closing when the door is open approximately 8". If this is not the case, make sure the closers (at the bottom of the hinge pin) are clean, greased and installed correctly. Also, re-check leveling from front to back of the unit and readjust if necessary. Make sure that pivot plate is installed correctly.

### **Q:** Problem

The custom overlay door was designed to align with the rest of the cabinet doors, but the unit has crept forward.

### **A:** Solution

Make sure that the electrical cord and water supply line are not obstructing the installation.

## PRODUCT INFORMATION

Complete Installation Guides, Use and Care Guides, Specifications & Features and Benefits, CAD Drawings, Overlay Panel/Frame and Toe-Kick Specifications and Instructions, Compliance Documentation and Applicable Energy Guides are available for reference and download at [u-line.com](http://u-line.com).

## SERVICE INFORMATION

Please consult your Use and Care Guide for troubleshooting information. Answers to Customer Frequently Asked Questions are available at [u-line.com](http://u-line.com) under Customer Service. You may contact U-Line directly:

### GENERAL INQUIRIES:

U-Line Corporation  
P.O. Box 245040  
Milwaukee, Wisconsin 53224-9540 U.S.A.  
Phone 1-414-354-0300  
FAX 1-414-354-7905  
Email: [sales@u-line.com](mailto:sales@u-line.com)  
[u-line.com](http://u-line.com)

### SERVICE ASSISTANCE:

Phone 1-800-779-2547  
FAX 1-414-354-5696  
Email: [onlineservice@u-line.com](mailto:onlineservice@u-line.com)  
[u-lineservice.com](http://u-lineservice.com)

### PARTS ASSISTANCE:

E-mail: [onlineparts@u-line.com](mailto:onlineparts@u-line.com)

---

## BUILDING ON THREE GENERATIONS OF INNOVATION

For nearly five decades and three generations, U-Line continues to be the leader in innovation, quality and value in the premium built-in undercounter ice making, refrigeration and wine preservation market. U-Line has captivated those with an appreciation for the finer things with exceptional functionality, style, inspired innovation and attention to even the smallest details. We are known and respected for our unwavering dedication to product design, quality and selection.

In 1962, Henry Uihlein founded U-Line Corporation as an outgrowth of Ben-Hur Freezer Company and was the first to develop and patent an automatic stand-alone undercounter residential ice maker. His foresight and determination to develop new ideas and to succeed when there were no clear guidelines or solutions are evident today. The newest Uihlein generation continues to build upon the family's innovative legacy at the Milwaukee, Wisconsin based business by providing continuity and vision from which new designs and technology continue to be born.

Today the complete U-Line product collection includes Ice Makers, Wine Captain® Models, Combo® Models, a Refrigerator / Freezer, Refrigerators, Drawers and Beverage Centers. The U-Line brand offers products in the 1000 Series, 2000 Series and the Modular 3000 Series. The 1000 Series offers a more targeted priced product with appropriate features, while the 2000 Series offers upscale features, advanced technology and specialized product families. U-Line's approach to its breadth of products, multiple price points and features allows a choice and product that will fit any lifestyle.

## DESIGNED, ENGINEERED AND ASSEMBLED IN WISCONSIN, USA