

# ADJUSTABLE CLEANOUT

## » 851 SERIES

### SPECIFICATION

Sioux Chief 851 Series adjustable cleanout shall be used where necessary in drainage systems. Cleanout shall have a cast iron no-hub connection and adjustable access cover. Scoriated cleanout cover shall meet applicable load requirements for intended use. Cleanout shall include a slotted, polypropylene cleanout plug. Designed in accordance with ASME A112.36.2M-2002.

### MATERIALS

**Adapter body:** Cast iron  
**Ring/cover:** Nickel-bronze, tenzallo, cast iron  
**Cleanout plug:** Polypropylene

### COVER LOAD RATING

**Nickel-bronze:** 2,500 lbs. (Medium duty)  
**Tenzalloy:** 1,250 lbs. (Light duty)  
**Cast iron:** 7,500 lbs. (Extra-heavy duty)  
**Cast iron with nickel-bronze veneer:** 7,500 lbs. (Extra-heavy duty)

### DIMENSIONS

<b>A:</b> Connection	4" No-Hub
<b>B:</b> Ring/cover diameter	
Nickel-bronze/tenzallo	6"
Cast iron	6"
Cast iron with nickel-bronze veneer	7 <sup>1</sup> / <sub>8</sub> "
<b>C:</b> Overall height	
Nickel-bronze/tenzallo	3 <sup>1</sup> / <sub>4</sub> " – 4 <sup>1</sup> / <sub>2</sub> "
Cast iron	3 <sup>3</sup> / <sub>4</sub> " – 5 <sup>3</sup> / <sub>4</sub> "
Cast iron with nickel-bronze veneer	4" – 6"
<b>D:</b> Cleanout plug	4"

ITEM # SUBMITTED	_____
JOB NAME	_____
LOCATION	_____
ENGINEER	_____
CONTRACTOR	_____
PO#	_____ TAG _____



851-24i

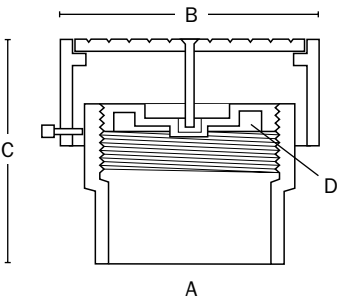

### Create Item Number

## 851-24A B

e.g. **851-24i**: Adjustable cleanout with 4" No-Hub connection and cast iron ring/cover

#### RING/COVER A

**N** = Nickel-bronze ring/cover  
**T** = Tenzalloy ring/cover  
**i** = Cast iron ring/cover  
**iN** = Cast iron with nickel-bronze veneer

#### INSTALLED OPTIONS B

**V** = Vandal-resistant screw  
**S** = Stamping: specify letters<sup>1</sup>  
**C** = Carpet marker<sup>1</sup>

<sup>1</sup> Not available on cast iron covers