



Ductile Iron MJ Compact Fittings

ANSI/AWWA C153/A21.53

GENERAL SPECIFICATIONS

- MATERIAL: Ductile Iron per ASTM A536
PRESSURE: 350 PSI rating for 2" - 24" sizes, 250 PSI rating for 30" - 48" sizes and 150 PSI rating for 54" - 64" sizes
TESTING: In accordance with ANSI/AWWA C153/A21.53, ANSI/AWWA C111/A21.11, UL and FM requirements
LAYING LENGTH: In accordance with ANSI/AWWA C153/A21.53 (fittings not listed in ANSI/AWWA have dimensions per Star design as noted in the catalog)
DEFLECTION: 2"-4"=8° | 6"-7" | 8"-12"=5° | 14"-16"=3 1/2° | 18"-24"=3° | 30"-64"=2°
WEIGHTS: Are in pounds, unless noted otherwise and do not include accessories, cement lining and coating
FLANGES: Flanged ends on fittings match ANSI/AWWA C115/A21.15 and ANSI B16.1 class 125 flanges
CEMENT LINING: In accordance with ANSI/AWWA C104/A21.4 -- size 2" - 3" single thickness and sizes 4" - 64" double thickness
COATING: Asphaltic seal coat inside and out in accordance with ANSI/AWWA C104/A21.4 and referenced in ANSI/AWWA C153/A21.53
GASKETS: SBR in accordance with ANSI/AWWA C111/A21.11
T-BOLTS/NUTS: Low alloy steel in accordance with ANSI/AWWA C111/A21.11
APPROVALS: 3" - 12" UL/ULC Listed | 2" and greater are UL/ANSI/NSF Standards 61 and 372 | 3" - 16" FM APPROVED. Please consult factory for detail listing and approvals.
DIMENSIONS: All dimensions are in inches unless noted otherwise.
INSTALLATION: Per ANSI/AWWA C600 and C111 using DIP conforming to C150/C151 and PVC pipe conforming to C900/C905



SUBMITTAL INFORMATION
PROJECT NAME:
ENGINEER:
CONTRACTOR:
SPEC. SECTION:

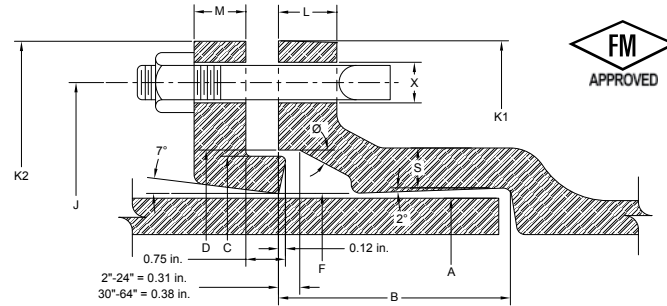

MECHANICALJOINT DIMENSIONS

Table with columns: NOM. SIZE, A DIA., B, C DIA., D DIA., F DIA., J DIA., K1 DIA., K2 DIA., L, M, S, Ø, X DIA., BOLTS (SIZE, NO.). Rows include sizes from 2 to 64 inches.

SIZE RANGE (Please specify):
Size Range _____

LINING OPTIONS (Please check one):
Standard: Cement-lined and asphalt seal coat per ANSI/AWWA C104/A21.4 and UL/NSF-61
Optional: FBE (Fusion Bonded Epoxy) per ANSI/AWWA C116/A21.15 and UL/NSF-61 - ID & OD Only
Optional: P401 (Protecto 401) Ceramic Epoxy - sewer applications only. Not NSF-61
Optional: Other (specify) _____

COATING OPTIONS (Please check one):
Standard: Asphaltic seal coat per ANSI/AWWA C104/A21.4
Optional: FBE (Fusion Bonded Epoxy) per ANSI/AWWA C116/A21.15 and UL/NSF-61 - ID & OD Only
Optional: Other (specify) _____





Compact MJ Fittings

ANSI/AWWA C153/A21.53

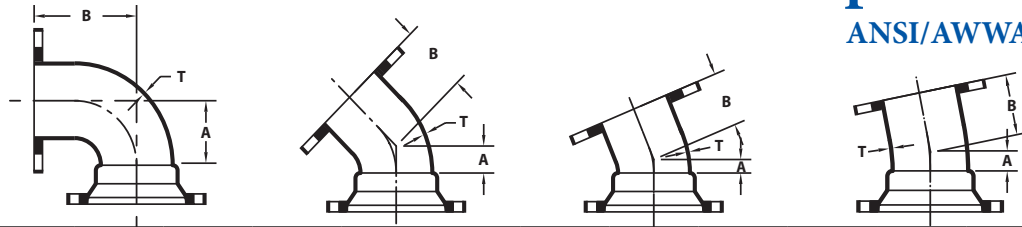

MJ x FE BENDS		90° MJ x FE BENDS (1/4)			45° MJ x FE BENDS (1/8)			22 1/2° MJ x FE BENDS (1/16)			11 1/4° MJ x FE BENDS (1/32)		
NOM. SIZE	T	A	B	WT (LBS.)	A	B	WT (LBS.)	A	B	WT (LBS.)	A	B	WT (LBS.)
3	0.33	3.50	5.50	20	1.50	3.00	17	1.00	3.00	17	1.00	3.00	15
4	0.34	4.00	6.50	26	2.00	4.00	24	1.50	4.00	26	1.25	4.00	19
6	0.36	5.00	8.00	47	3.50	5.00	40	2.00	5.00	36	1.50	5.00	30
8	0.38	6.50	9.00	68	3.50	5.50	57	2.50	5.50	53	1.75	5.50	50
10	0.40	7.50	11.00	102	4.50	6.50	83	3.00	6.50	102	2.00	6.50	75
12	0.42	9.00	12.00	134	5.50	7.50	110	3.50	7.50	134	2.25	7.50	88
14	0.47	11.50	14.00	227	5.00	7.50	207	3.75	7.50	166	---	---	---
16	0.50	12.50	15.00	306	5.50	8.00	239	3.75	8.00	228	2.50	8.00	201
18	0.54	14.00	16.50	357	6.00	8.50	268	4.50	8.50	259	3.00	8.50	247
20	0.57	15.00	18.00	445	7.00	9.50	339	4.50	9.50	321	3.00	9.50	307
24	0.61	17.00	22.00	650	7.50	11.00	474	4.50	11.00	444	3.00	11.00	427
30	0.66	21.50	25.00	1070	10.50	15.00	858	6.75	15.00	764	4.75	15.00	733
36	0.74	24.50	28.00	1554	11.50	18.00	1240	7.75	18.00	1176	5.00	18.00	1118
42	0.82	29.25	31.00	2190	14.00	21.00	1820	---	---	---	6.00	21.00	1627
48	0.90	33.25	34.00	3015	15.00	24.00	2421	---	---	---	---	---	---

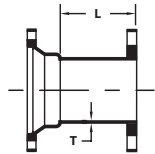

MJ x FLANGE ADAPTER			
NOM. SIZE	T	L	WT (LBS.)
3	0.33	3.50	13
4	0.34	3.50	22
6	0.36	3.50	32
8	0.38	3.50	47
10	0.40	4.00	66
12	0.42	4.00	91
14	0.47	5.00	141
16	0.50	5.00	170
18	0.54	5.00	176
20	0.57	5.00	252
24	0.61	5.00	320
30	0.66	7.00	558
36	0.74	8.50	796
42	0.82	12.00	1180
48	0.90	12.00	1499
54	1.05	13.00	1889
60	1.10	13.00	2148

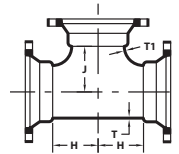

MJ x MJ TEES					
NOM. SIZE	T	T1	H	J	WT (LBS.)
2 x 2	0.39	0.39	3.25	3.25	20
3 x 2	0.48	0.39	3.50	3.50	43
3 x 3	0.33	0.33	3.00	3.00	28
4 x 2	.034	0.30	3.00	4.00	29
4 x 3	0.34	0.33	3.50	4.00	30
4 x 4	0.34	0.34	4.00	4.00	32
6 x 3	0.36	0.33	3.50	5.00	42
6 x 4	0.36	0.34	4.00	5.00	46
6 x 4 x 6	0.36	0.36	5.00	5.00	50
6 x 6	0.36	0.36	5.00	5.00	56
6 x 6 x 8	0.36	0.38	6.50	6.50	62
8 x 3	0.38	0.33	4.00	6.50	52
8 x 4	0.38	0.34	4.00	6.50	60
8 x 6	0.38	0.36	5.00	6.50	72
8 x 6 x 6	0.38	0.38	5.00	6.50	62
8 x 6 x 8	0.38	0.38	6.00	6.50	85
8 x 8	0.38	0.38	6.50	6.50	86
10 x 3	0.40	0.33	4.00	7.50	75
10 x 4	0.40	0.34	4.00	7.50	78
10 x 6	0.40	0.36	5.00	7.50	90
10 x 8	0.40	0.38	6.50	7.50	105
10 x 10	0.40	0.40	7.50	7.50	120
12 x 3	0.42	0.33	4.00	8.75	90
12 x 4	0.42	0.34	4.00	8.75	94

(Con't)

UCAT:19.01

* REGISTERED TRADEMARK OF STAR PIPE PRODUCTS



STAR[®] PIPE PRODUCTS



Compact MJ Fittings

ANSI/AWWA C153/A21.53

MJ x MJ TEES (Con't)					
NOM. SIZE	T	T1	H	J	WT (LBS.)
12 x 6	0.42	0.36	5.00	8.75	110
12 x 8	0.42	0.38	6.50	8.75	125
12 x 10	0.42	0.40	7.50	8.75	140
12 x 12	0.42	0.42	8.75	8.75	160
14 x 6	0.47	0.36	6.50	10.50	182
14 x 8	0.47	0.38	7.50	10.50	190
14 x 10	0.47	0.40	8.50	10.50	206
14 x 12	0.47	0.42	9.50	10.50	221
14 x 14	0.47	0.47	10.50	10.50	251
16 x 6	0.50	0.36	6.50	11.50	218
16 x 8	0.50	0.38	7.50	11.50	223
16 x 10	0.50	0.40	8.50	11.50	264
16 x 12	0.50	0.42	9.50	11.50	280
16 x 14	0.50	0.47	10.50	11.50	316
16 x 16	0.50	0.50	11.50	11.50	322
18 x 6	0.54	0.36	6.50	12.50	275
18 x 8	0.54	0.38	7.50	12.50	295
18 x 10	0.54	0.40	8.50	12.50	315
18 x 12	0.54	0.42	9.50	12.50	335
18 x 14	0.54	0.47	10.50	12.50	380
18 x 16	0.54	0.50	11.50	12.50	405
18 x 18	0.54	0.54	12.50	12.50	435
20 x 4	0.57	0.34	5.50	14.00	295
20 x 6	0.57	0.36	6.50	14.00	315
20 x 8	0.57	0.38	8.00	14.00	345
20 x 10	0.57	0.40	9.00	14.00	370
20 x 12	0.57	0.42	10.00	14.00	395
20 x 14	0.57	0.47	11.00	14.00	440
20 x 16	0.57	0.50	12.00	14.00	465
20 x 18	0.57	0.54	13.00	14.00	505
20 x 20	0.57	0.57	14.00	14.00	535
24 x 4	0.61	0.34	6.00	16.00	398
24 x 6	0.61	0.36	7.00	16.00	415
24 x 8	0.61	0.38	8.00	16.00	445
24 x 10	0.61	0.40	9.00	16.00	470
24 x 12	0.61	0.42	10.00	16.00	500
24 x 14	0.61	0.47	11.00	16.00	550
24 x 16	0.61	0.50	12.00	16.00	580
24 x 18	0.61	0.54	13.00	16.00	625
24 x 20	0.61	0.57	14.00	16.00	660
24 x 24	0.61	0.61	16.00	16.00	720
30 x 6	0.66	0.36	8.00	20.00	685
30 x 8	0.66	0.38	8.50	20.00	739
30 x 10	0.66	0.40	10.00	20.00	760
30 x 12	0.66	0.42	10.00	20.00	830
30 x 14	0.66	0.47	11.00	20.00	880
30 x 16	0.66	0.50	12.50	20.00	878
30 x 18	0.66	0.54	14.00	20.00	1039
30 x 20	0.66	0.57	15.00	20.00	1000
30 x 24	0.66	0.61	21.00	22.00	1389
30 x 30	0.66	0.66	20.00	20.00	1323
36 x 4	0.74	0.34	7.00	23.50	924
36 x 6	0.74	0.36	8.00	23.50	1045

(Con't)➔

MJ x MJ TEES (Con't)					
NOM. SIZE	T	T1	H	J	WT (LBS.)
36 x 8	0.74	0.38	9.00	23.50	1095
36 x 10	0.74	0.40	9.00	23.50	1024
36 x 12	0.74	0.42	10.00	23.50	1072
36 x 14	0.74	0.47	11.00	23.50	1135
36 x 16	0.74	0.50	12.50	23.50	1210
36 x 18	0.74	0.54	13.00	23.50	1251
36 x 20	0.74	0.57	15.00	23.50	1350
36 x 24	0.74	0.61	16.00	23.50	1550
36 x 30	0.74	0.66	20.00	23.50	1986
36 x 36	0.74	0.74	23.50	23.50	2072
42 x 6	0.82	0.36	9.00	27.50	1366
42 x 8	0.82	0.38	9.00	27.50	1369
42 x 12	0.82	0.42	14.00	27.50	1885
42 x 16	0.82	0.50	13.00	27.50	1929
42 x 18	0.82	0.54	16.00	27.50	2072
42 x 20	0.82	0.57	18.00	27.50	1947
42 x 24	0.82	0.61	20.00	27.50	2270
42 x 30	0.82	0.66	22.00	29.50	2608
42 x 36	0.82	0.74	30.00	30.00	3000
42 x 42	0.82	0.82	30.00	30.00	3175
48 x 6	0.90	0.36	10.00	32.00	1949
48 x 12	0.90	0.42	14.00	32.00	2535
48 x 16	0.90	0.50	13.00	32.00	2657
48 x 18	0.90	0.54	16.00	32.00	2293
48 x 24	0.90	0.61	23.00	32.00	2870
48 x 30	0.90	0.66	23.00	32.00	3050
48 x 36	0.90	0.74	33.50	32.25	3900
48 x 42	0.90	0.82	33.50	33.50	4100
48 x 48	0.90	0.90	33.50	33.50	4250
54 x 20	1.05	0.57	23.00	37.00	3486
54 x 24	1.05	0.61	23.00	37.00	3505
54 x 30	1.05	0.66	29.30	37.00	4162
54 x 36	1.05	0.77	29.30	37.00	4257
54 x 42	1.05	0.88	31.00	39.00	4610
60 x 30	1.10	0.66	29.50	39.00	4648
64 x 64	1.16	1.16	43.30	43.30	7454

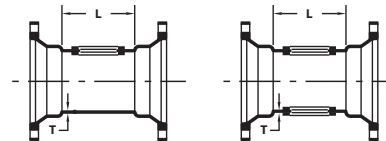

MJ x MJ TAPPED TEES / CROSSES (2" TAP)				
NOM. SIZE	T	L	MAX TAP	WT (LBS.)
3	0.33	6.00	2 1/2	18
4	0.34	6.00	3	25
6	0.36	6.00	3	42
8	0.38	6.00	3	55
10	0.40	6.00	3	70
12	0.42	6.00	3	85
16	0.50	6.00	3	164
24	0.61	8.00	3	325

Threads in Accordance with ANSI/ASME B1.20.1

STAR[®] PIPE PRODUCTS

UCAT:19.01
* REGISTERED TRADEMARK OF STAR PIPE PRODUCTS

