



MANUFACTURERS OF PIPE FITTINGS

Contact Us:
 Phone: (630) 543-4777
 Fax: (630) 543-4792
 www.BILLCOCORP.com
 770 West Belden Ave.
 Addison, IL 60101

BUSHINGS

STEEL HEX BUSHINGS

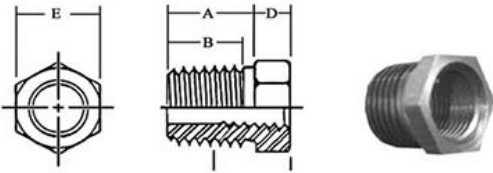

| NOMINAL PIPE SIZE | BODY LENGTH MIN. A | LENGTH OF EXT. THREAD MIN. B | LENGTH OF INT. THREAD MIN. C | HEIGHT OF HEAD MIN. D | DISTANCE ACROSS FLATS E |
|-------------------|--------------------|------------------------------|------------------------------|-----------------------|-------------------------|
| 1/4 X 1/8 | 0.48 | 0.41 | 0.26 | 0.15 | 5/8 |
| 3/8 X 1/8 | 0.50 | 0.43 | 0.25 | 0.16 | 11/16 |
| 3/8 X 1/4 | 0.50 | 0.43 | 0.40 | 0.16 | 11/16 |
| 1/2 X 1/8 | 0.61 | 0.54 | 0.25 | 0.19 | 7/8 |
| 1/2 X 1/4 | 0.61 | 0.54 | 0.32 | 0.19 | 7/8 |
| 1/2 X 3/8 | 0.61 | 0.54 | 0.41 | 0.19 | 7/8 |
| 3/4 X 1/8 | 0.72 | 0.62 | 0.25 | 0.22 | 1-1/16 |
| 3/4 X 1/4 | 0.72 | 0.62 | 0.32 | 0.22 | 1-1/16 |
| 3/4 X 3/8 | 0.72 | 0.62 | 0.36 | 0.22 | 1-1/16 |
| 3/4 X 1/2 | 0.72 | 0.62 | 0.43 | 0.22 | 1-1/16 |
| 1 X 1/8 | 0.75 | 0.67 | 0.25 | 0.25 | 1-5/16 |
| 1 X 1/4 | 0.75 | 0.67 | 0.32 | 0.25 | 1-5/16 |
| 1 X 3/8 | 0.75 | 0.67 | 0.36 | 0.25 | 1-5/16 |
| 1 X 1/2 | 0.75 | 0.67 | 0.43 | 0.25 | 1-5/16 |
| 1 X 3/4 | 0.75 | 0.67 | 0.50 | 0.25 | 1-5/16 |
| 1-1/4X1/4 | 0.89 | 0.76 | 0.32 | 0.28 | 1-3/4 |
| 1-1/4X3/8 | 0.89 | 0.76 | 0.36 | 0.28 | 1-3/4 |
| 1-1/4X1/2 | 0.89 | 0.76 | 0.43 | 0.28 | 1-3/4 |
| 1-1/4X3/4 | 0.89 | 0.76 | 0.50 | 0.28 | 1-3/4 |
| 1-1/4X1 | 0.89 | 0.76 | 0.58 | 0.28 | 1-3/4 |
| 1-1/2X3/4 | 0.91 | 0.83 | 0.50 | 0.31 | 2 |
| 1-1/2X1 | 0.91 | 0.83 | 0.58 | 0.31 | 2 |
| 1-1/2X1-1/4 | 0.91 | 0.83 | 0.67 | 0.31 | 2 |
| 2 X 1 | 0.96 | 0.88 | 0.58 | 0.34 | 2-1/2 |
| 2 X 1 1/4 | 0.96 | 0.88 | 0.67 | 0.34 | 2-1/2 |
| 2 X 1 1/2 | 0.96 | 0.88 | 0.70 | 0.34 | 2-1/2 |
| 2-1/2X1-1/4 | 1.07 | 1.07 | 0.67 | 0.44 | 3 |
| 2-1/2X1-1/2 | 1.07 | 1.07 | 0.70 | 0.44 | 3 |
| 2-1/2X2 | 1.07 | 1.07 | 0.75 | 0.44 | 3 |
| 3X1-1/2 | 1.13 | 1.13 | 0.70 | 0.48 | 3-1/2 |
| 3X2 | 1.13 | 1.13 | 0.75 | 0.48 | 3-1/2 |
| 3X2-1/2 | 1.13 | 1.13 | 0.92 | 0.48 | 3-1/2 |

Additional sizes available upon request

Available in:
 Black Steel, Zinc (galvanized) Plated, Lead Free Brass.
 NPTF Dryseal Taper Threads.
 ROHS, WEE, REACH Compliant.
 Made in U.S.A.

STEEL FACE BUSHINGS

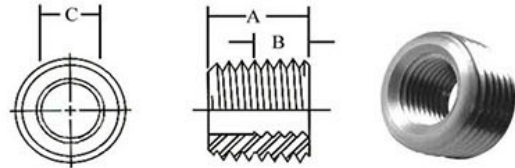

| NOMINAL PIPE SIZE | BODY LENGTH MIN. A | LENGTH OF INT. THREAD MIN. B | STOCK DIA. NOM. C |
|-------------------|--------------------|------------------------------|-------------------|
| 1/4 X 1/8 | 0.44 | 0.25 | 9/16 |
| 3/8 X 1/8 | 0.48 | 0.25 | 11/16 |
| 3/8 X 1/4 | 0.48 | 0.37 | 11/16 |
| 1/2 X 1/8 | 0.56 | 0.25 | 13/16 |
| 1/2 X 1/4 | 0.56 | 0.37 | 13/16 |
| 1/2 X 3/8 | 0.56 | 0.41 | 13/16 |
| 3/4 X 1/8 | 0.62 | 0.25 | 1-1/16 |
| 3/4 X 1/4 | 0.62 | 0.37 | 1-1/16 |
| 3/4 X 3/8 | 0.62 | 0.41 | 1-1/16 |
| 3/4 X 1/2 | 0.62 | 0.50 | 1-1/16 |
| 1 X 1/4 | 0.75 | 0.37 | 1-5/16 |
| 1 X 3/8 | 0.75 | 0.41 | 1-5/16 |
| 1 X 1/2 | 0.75 | 0.50 | 1-5/16 |
| 1 X 3/4 | 0.75 | 0.52 | 1-5/16 |
| 1-1/4 X 1/2 | 0.81 | 0.50 | 1-3/4 |
| 1-1/4 X 3/4 | 0.81 | 0.52 | 1-3/4 |
| 1-1/4 X 1 | 0.81 | 0.62 | 1-3/4 |
| 1-1/2 X 3/4 | 0.83 | 0.52 | 1-7/8 |
| 1-1/2 X 1 | 0.83 | 0.62 | 1-7/8 |
| 1-1/2 X 1-1/4 | 0.83 | 0.77 | 1-7/8 |

Available in:
 Black Steel, Zinc (galvanized) Plated, Lead Free Brass.
 NPTF Dryseal Taper Threads.
 ROHS, WEE, REACH Compliant.
 Made in U.S.A.