



MULTI FITTINGS

LAYING LENGTH

ISSUE DATE: 2018 02 07
SUPERCEDES: 2005 06 30

SANITARY TEE (HxHxH)

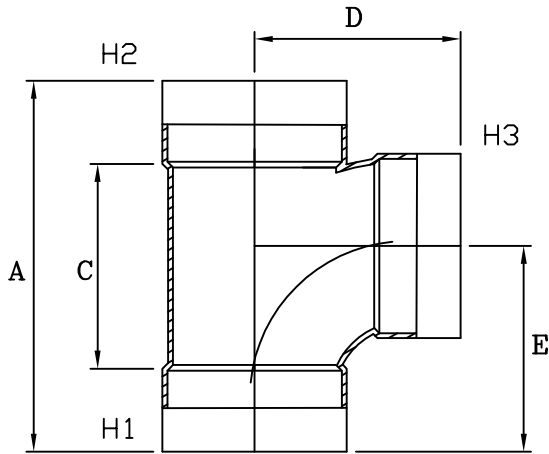

INJECTION MOLDED FITTING (M)

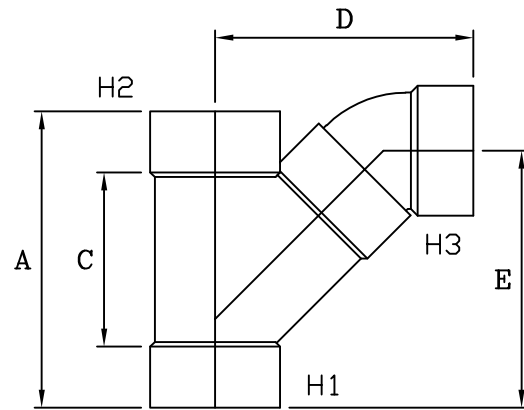

FABRICATED FITTING

	SIZE H1xH2xH3	PART NUMBER	A REF	C REF	D REF	E REF
M	4x4x4	026470	9.625	6.125	5.625	5.625
M	6x6x4	026079	12.000	6.000	6.125	6.875
M	6x6x6	026080	15.500	9.500	8.500	9.250
M	6x6x6	226052	15.500	9.500	8.500	9.250
F	8x8x4	294217	19.00	11.00	13.25	15.00
F	8x8x6	294219	22.00	14.00	17.00	18.75
P	8x8x8	026013	-	-	-	-
F	10x10x4	294221	21.25	11.25	14.25	16.25
F	10x10x6	294223	24.25	14.25	18.00	20.00
F	10x10x8	294225	27.00	17.00	21.25	23.00
F	10x10x10	294201	30.00	20.00	24.75	26.75
F	12x12x4	294227	23.50	11.50	15.25	17.25
F	12x12x6	294229	26.75	14.75	19.00	21.25
F	12x12x8	294231	29.50	17.50	22.25	24.25
F	12x12x10	294233	32.50	20.50	25.75	27.75
F	12x12x12	294203	35.25	23.25	29.00	31.00

NOTE: Refer to Page LPD5 for Molded hub detail
Refer to Page LPD5-1 for Fabricated hub detail