

Class 300 (XS/XH)

FIG. 3167

Reducing Coupling

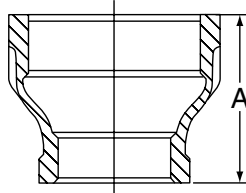

For Listings/Approval Details and Limitations, visit our website at www.anvilint.com or contact an Anvil® Sales Representative.

FIGURE 3167 - REDUCING COUPLING

| Nominal Size | Dimension A | Approx. Wt. Each | Nominal Size | Dimension A | Approx. Wt. Each |
|--------------|-------------|------------------|---------------|-------------|------------------|
| In. (mm) | In. (mm) | Lbs. (kg) | In. (mm) | In. (mm) | Lbs. (kg) |
| 3/8 x 1/4 | 1.44 | 0.21 | 1 1/2 x 1 | 2.69 | 1.60 |
| 10 x 8 | 36.58 | 0.10 | 40 x 25 | 68.33 | 0.73 |
| 1/2 x 1/4 | 1.69 | 0.31 | 1 1/2 x 1 1/4 | 2.69 | 1.80 |
| 15 x 8 | 42.93 | 0.14 | 40 x 32 | 68.33 | 0.82 |
| 1/2 x 3/8 | 1.69 | 0.34 | 2 x 1/2 | 3.19 | 2.40 |
| 15 x 10 | 42.93 | 0.15 | 50 x 15 | 81.03 | 1.09 |
| 3/4 x 3/8 | 1.75 | 0.47 | 2 x 3/4 | 3.19 | 2.40 |
| 20 x 10 | 44.45 | 0.21 | 50 x 20 | 81.03 | 1.09 |
| 3/4 x 1/2 | 1.75 | 0.50 | 2 x 1 | 3.19 | 2.50 |
| 20 x 15 | 44.45 | 0.23 | 50 x 25 | 81.03 | 1.13 |
| 1 x 1/2 | 2.00 | 0.71 | 2 x 1 1/4 | 3.19 | 2.70 |
| 25 x 15 | 50.80 | 0.32 | 50 x 32 | 81.03 | 1.22 |
| 1 x 3/4 | 2.00 | 0.79 | 2 x 1 1/2 | 3.19 | 2.70 |
| 25 x 20 | 50.80 | 0.36 | 50 x 40 | 81.03 | 1.22 |
| 1 1/4 x 1/2 | 2.38 | 1.10 | 2 1/2 x 1 1/2 | 3.69 | 4.10 |
| 32 x 15 | 60.45 | 0.50 | 65 x 40 | 93.73 | 1.86 |
| 1 1/4 x 3/4 | 2.38 | 1.20 | 2 1/2 x 2 | 3.69 | 4.30 |
| 32 x 20 | 60.45 | 0.54 | 65 x 50 | 93.73 | 1.95 |
| 1 1/4 x 1 | 2.38 | 1.30 | 3 x 2 | 4.06 | 5.80 |
| 32 x 25 | 60.45 | 0.59 | 80 x 50 | 103.12 | 2.63 |
| 1 1/2 x 1/2 | 2.69 | 1.50 | 3 x 2 1/2 | 4.06 | 6.50 |
| 40 x 15 | 68.33 | 0.68 | 80 x 65 | 103.12 | 2.95 |
| 1 1/2 x 3/4 | 2.69 | 1.60 | 4 x 3 | 4.38 | 10.00 |
| 40 x 20 | 68.33 | 0.73 | 100 x 80 | 111.25 | 4.54 |

MATERIAL SPECIFICATIONS

Dimensions: Fittings: ASME B16.3
 Unions: ASME B16.39
 Bushings/Plugs: ASME B16.14

Material: ASTM A-197

Finish: Black or Hot Dip Galvanized per ASTM A153 Class A

Threads: NPT per ASME B1.20.1

Pressure Ratings: Fittings: ASME B16.3
 Unions: ASME B16.39
 Bushings/Plugs: ASME B16.14

Pressure Testing: All malleable iron fittings are tested for through wall porosity using an air under water process.

Agency Approvals: All malleable iron fittings and unions are UL/ULC Listed and FM Approved.

PROJECT INFORMATION

APPROVAL STAMP

| | |
|------------------------|--|
| Project: | <input type="checkbox"/> Approved |
| Address: | <input type="checkbox"/> Approved as noted |
| Contractor: | <input type="checkbox"/> Not approved |
| Engineer: | Remarks: |
| Submittal Date: | |
| Notes 1: | |
| Notes 2: | |