

## IPS Line Cross

- Reinforced
- Fully Pressure Rated With Full Flow ID

Size [inch]	Part No.	Feedstock OD [inch]	A [inch]	B [inch]	SDR 9 WPR [psi]	SDR 11 WPR [psi]	SDR 17 WPR [psi]
4		6.625	15.3	12.0	200	160	100
6		8.625	18.3	14.0	200	160	100
8		10.750	19.9	14.5	200	160	100
10		12.750	20.9	14.5	200	160	100
12		14.000	24.0	17.0	200	160	100
14		16.000	25.0	17.0	200	160	100
16		18.000	27.0	18.0	200	160	100
18		20.000	28.0	18.0	200	160	100
20		22.000	31.0	20.0	200	160	100
22		24.000	32.0	20.0	200	160	100
24		26.000	35.0	20.0	200	160	100

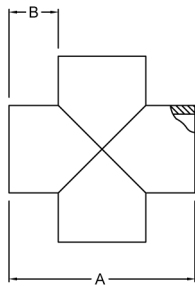

## DIPS Fabricated Line Cross

Size [inch]	Part No.	A [inch]	B [inch]	SDR 7 WPR [psi]	Weight [lbs]	SDR9 WPR [psi]	Weight [lbs]
4		16.8	6.0	160	11	128	8
6		18.9	6.0	160	20	128	17
8		25.0	8.0	160	44	128	40
10		27.1	8.0	160	73	128	60
12		29.2	8.0	160	108	128	91
14		33.3	9.0	160	173	128	143
16		35.4	9.0	160	235	128	200
18		39.5	10.0	160	328	128	271
20		41.6	10.0	160	411	128	346
24		49.8	12.0	160	701	128	591
30		60.0	14.0			128	1098

Size [inch]	SDR 11	
	WPR [psi]	Weight [lbs]
4		
6		
8		
10	80	43
12	80	62
14	80	97
16	80	132
18	80	183
20	80	234
24	80	398
30	80	737