



# Windward® 5' BubbleMassage™ Bath K-1112-G



## Features

- End drain.
- Integral lumbar support and armrests for comfort.
- 60" (1524 mm) x 42" (1067 mm) x 21" (533 mm)

## Material

- Acrylic

## Hydrotherapy

- 120 BubbleMassage™ airjets.
- Zones of Control feature allows you to target massage to back, midsection, or feet.
- Automatic purge cycles remove residual water from air channels after use.
- Built-in 300 W heater.
- Lighted keypad control.

## Installation

- Drop-in

## Recommended Accessories

- K- 11677 Bath Drain
- K- 7166-AF Bath Drain
- K- 24916 Wireless Music Kit



## Codes/Standards



ASME A112.19.7/CSA B45.10  
CSA B45.5/IAPMO Z124  
ASTM E162  
ASTM E662  
UL 1795  
Greenguard UL 2818 - Gold  
CARB P2

## KOHLER® One-Year Limited Warranty

See website for detailed warranty information.

## Available Color/Finishes

*Color tiles intended for reference only.*

Color	Code	Description
	0	White
	96	Biscuit
	47	Almond

No change in measurements if connected with drain illustrated. (K-11677)

Recommended faucet area

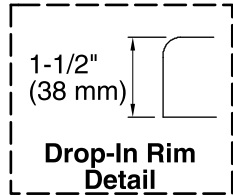

Blower/Control Access  
20" (508 mm) W x  
15" (381 mm) H Min

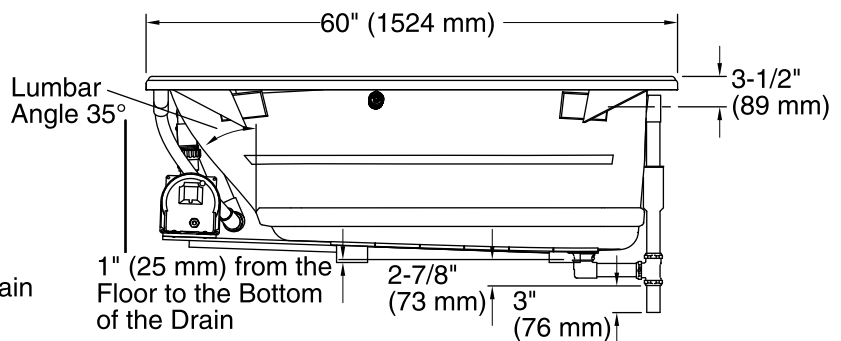
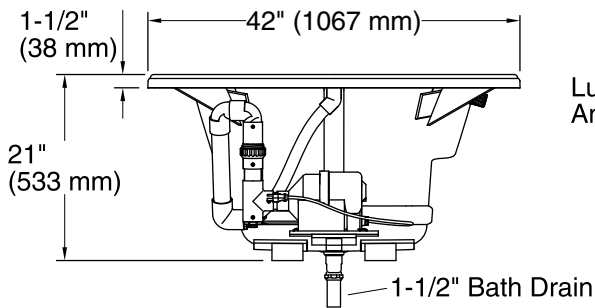
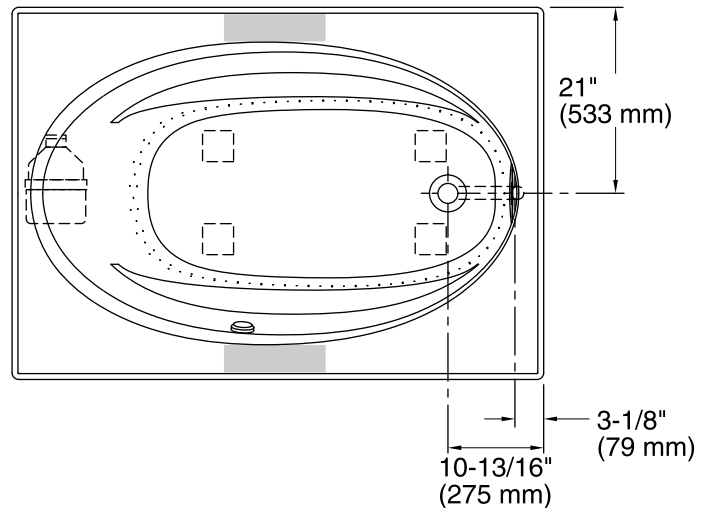

### Required Electrical Service

One dedicated circuit required, protected with Class A Ground-Fault Circuit-Interrupter (GFCI) or Residual Current Device (RCD).

Blower: 120 V, 15 A, 60 Hz

### Technical Information

All product dimensions are nominal.

Installation: Drop-in  
Drain location: End  
Basin area, bottom: 43" x 20-1/2" (1092 mm x 521 mm)  
Basin area, top: 53-1/2" x 32-1/8" (1359 mm x 816 mm)  
Weight: 110 lbs (49.9 kg)  
Minimum floor load: 35 lbs/ft² (170.9 kg/m²)  
Water depth: 15" (381 mm)  
Water capacity: 57 gal (215.8 L)  
Cutout: Drop-in, 58-1/2" x 40-1/2" (1486 mm x 1029 mm)  
Electrical component rating: Blower: 120 V, 10 A, 60 Hz, 300 W  
Blower speed: Variable  
Minimum flat for door: 3-1/4" (83 mm)

### Notes

Measure your actual product for rough-in details.

Install this product according to the installation instructions.

The hot water supply should be 70% of the capacity of the bath or greater. Installations will vary.

Provide one grounded electrical outlet within 24" (610 mm) of each component.

If installing a rim-mount faucet, make sure there is no interference with drain overflow before drilling any holes. Consult local and national codes for minimum air gap requirements if installing a spout on the faucet deck.

Remote blower installation kit K-1446 is available for relocating the blower. Provide access for servicing the blower.

Do not relocate or alter the PVC tee or coiled flexible tubing connected to the blower. Follow the blower relocation instructions exactly.