

LONG STARTING COLLAR — RX12 (no damper) RX13 (damper)

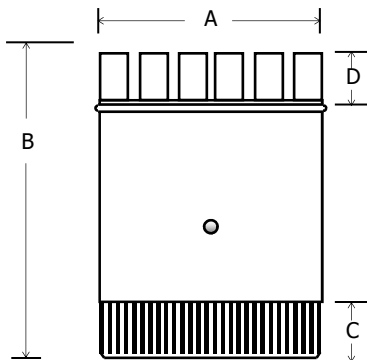

A	B	C	D	GA
4	6	1.75	1.0	30, 28
5	6	1.75	1.0	30, 28
6	6	1.75	1.0	30, 28, 26
7	6	1.75	1.0	30, 28, 26
8	6	1.75	1.0	30, 28, 26
9	6	1.75	1.0	30, 28, 26
10	6	1.75	1.0	30, 28, 26
12	6	1.75	1.0	26
14	6	1.75	1.0	26
16	6	1.75	1.0	26
18	6	1.75	1.0	26
20	6	1.75	1.0	26
22	6	1.75	1.0	26
24	6	1.75	1.0	26, 24
26	6	1.75	1.0	26, 24
28	6	1.75	1.0	26, 24
30	6	1.75	1.0	26, 24
32	6	1.75	1.0	26, 24
34	6	1.75	1.0	26, 24
36	6	1.75	1.0	26, 24

Galvanized Steel, G30/40 coating standard, G90 available. Specify GA Metals tabs with 1/4" bead for sheet metal application, crimp one end.

PART NUMBER DESIGNATIONS

RX12xx (no damper)

RX13xx (with damper)

XX = Diameter (03-36)

Single and dual hardware damper available

PROJECT: _____	COMPANY: _____	DATE : _____
LOCATION: _____		SUBMITTED BY: _____