



Three Handle Tub & Shower Fittings

**Features:**

- Features compression stems
- Body cast of high copper content brass
- Exposed parts have heavy chrome plate finish
- Working parts can easily be replaced
- 2.5 GPM (9.5 L/min) maximum showerhead at 80 psi
- 1/2" I.P.S. or 1/2" nominal copper sweat connections
- 11" Centers with sliding sleeve escutcheons
- ADA compliant handle operates with less than 5 lbs. force
- Three valve with center diverter
- Zinc die cast tub spout

Standards & Certifications:

- ANSI/ASME A112.18.1M
- ANSI A117.1 (ADA)
- IAPMO/cUPC

Catalog Numbers:**47-130-83** IPS/Sweat (Chrome)**07-47-130-83**PS/Sweat(Chrome)**Prefixes Available:**

07-Metal Fluted Handles

Suffixes Available:

None

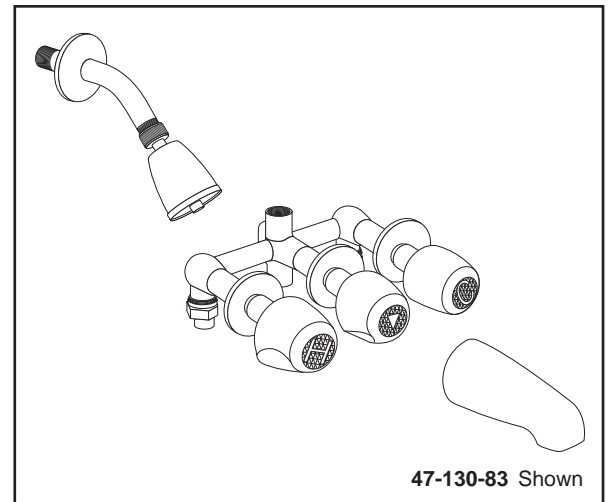
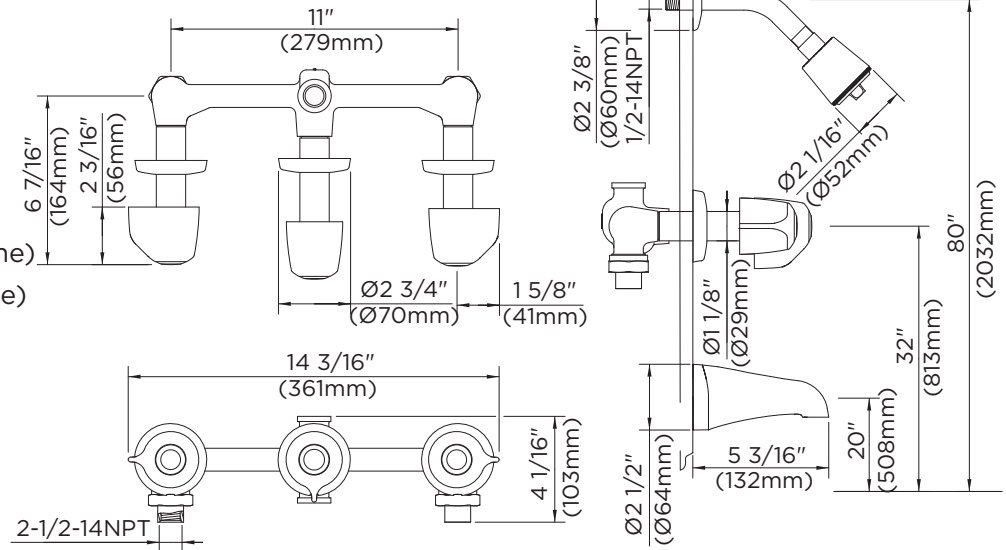
**47-130-83** Shown

Job Name	
Date	
Model Specified	
Quantity	
Customer	
Contractor	
Architect/engineer	