



4700 W. 160th St.
Cleveland, Ohio 44135
Ph: (800) 321-9532
Fax: (800) 321-9535
www.oatey.com

Reversible Metal Washing Machine Outlet Boxes



SUBMITTAL SPECIFICATION

Engineering Specification: Oatey Reversible Drain Metal Washing Machine Outlet Boxes can be used in commercial or residential applications which require supply valves and waste drain recessed into the wall. Available water hammer arrestor option provides water pressure shock arrestors required on supply lines to quick closing valves.

Job Reference



Front View

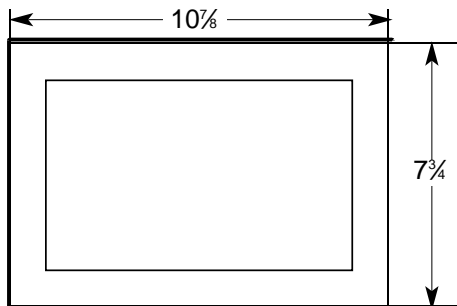
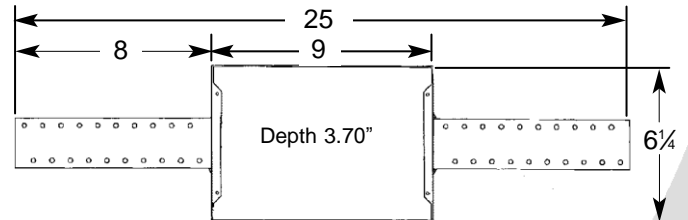

Faceplate

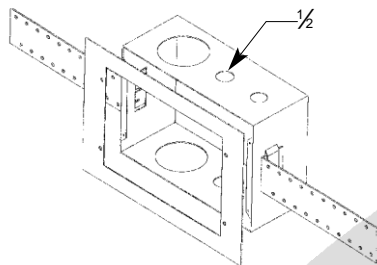

(All dimensions in inches)

- 2" drain opening - rubber coupling or solvent weld
- All reversible metal washing machine outlet boxes are shipped 1 per carton
- Allows for left or right hand drain
- Box made of 20 gauge steel
- 2 support brackets
- Easy to remove 1/2" metal cap knockouts
- Screw-on faceplate frame accommodates up to 1" drywall
- Faceplate made of 18 gauge steel

Prod. No	Description
38694	1/4 Turn Brass Hammer Ball Valves - ASTM F1807 PEX - With Grommets
38979	1/4 Turn Brass Ball Valves - CPVC- Rubber Tailpiece - Standard Pack
38980	Plain box - No valves - No Tailpiece - Standard Pack
38981	1/4 Turn Brass Ball Valves - Copper Sweat - PVC Tailpiece - Standard Pack
38982	Single Lever Turn Brass Ball Valve - Copper Sweat - PVC Tailpiece - Standard Pack
38983	1/4 Turn Brass Ball Valves - Copper Sweat - ABS Tailpiece - Standard Pack
38984	Single Lever Turn Brass Ball Valve - Copper Sweat - ABS Tailpiece - Standard Pack
38985	1/4 Turn Brass Ball Valves - Copper Sweat - 2" Rubber Tailpiece - Standard Pack
38986	Single Lever Turn Brass Ball Valve - Copper Sweat - 2" Rubber Tailpiece - Standard Pack
38992	North American Brass Boiler Drain Valves - Copper Sweat - ABS Tailpiece - Standard Pack
38993	1/4 Turn Brass Ball Valves - Copper Sweat - Metal 2" NPT Tailpiece - Standard Pack
38994	1/4 Turn Brass Ball Valves - ASTM F1960 PEX - PVC Tailpiece - Standard Pack
38995	1/4 Turn Brass Hammer Ball Valves - Copper Sweat - 2" Rubber Tailpiece - Standard Pack
38996	1/4 Turn Brass Hammer Ball Valves - CPVC- With Grommets - Top Mount



Data is subject to manufacturing tolerances.

Valves meet ASME A112.18.1
Water hammer arrestors meet ASSE Standard 1010.

Visit www.oatey.com for updates.

◀ Accessories		
	38975	Metal Faceplate for Metal WMOB
	38976	Metal Brackets for Metal WMOB
	38990	2" Rubber Tailpiece for Metal WMOB
	38987	2" PVC Drain Tailpiece for Metal WMOB
	38988	2" ABS Drain Tailpiece for Metal WMOB
	38989	1.5" Rubber Tailpieces for Metal WMOB