

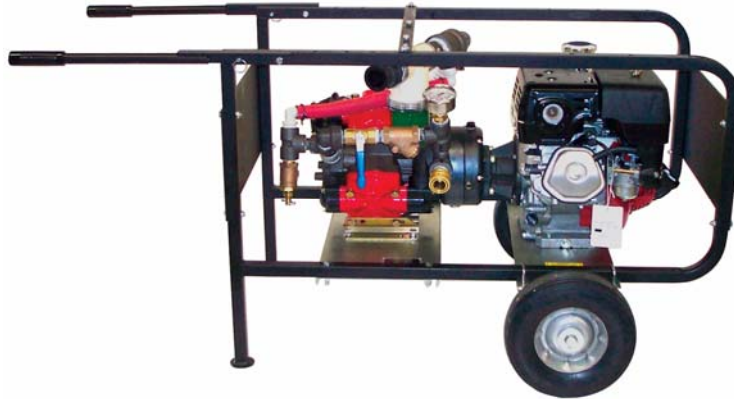

Operating Instructions Models 46800 and 468000 Hydrostatic Test Pumps

Specifications



46800	DIMENSIONS:	39" (70cm) L x 19" (60 cm) W x 26" (87.5cm) H
WEIGHT:		203 lbs 104.5 kg
PUMP:		Triple diaphragm: Positive displacement Ports: 1-1/2 " Inlet; 3/4" NPT outlet Capacity: 26gpm Pressure: Maximum of 250psi Operating Speed: 550rpm Lubrication: Pump: 30oz Udor Lube or SAE 30W non-detergent oil Gear case: 16oz 90W Gear Lube Shaft Size: 1"
ENGINE:		8hp Briggs & Stratton Intek Pro, 4 cycle, gasoline
CONTROL:		Built in pulsation Dampener
GAUGE:		Glycerin filled, 0-600psi, 0-42 kg
DISCHARGE HOSE:		3/4" x 10' (3m) 1000psi working pressure
INTAKE HOSE:		1" x 10' (3m)

468000	DIMENSIONS:	39" (70cm) L x 19" (60 cm) W x 26" (87.5cm) H
WEIGHT:		233 lbs 106 kg
PUMP:		Triple diaphragm: Positive displacement Ports: 1-1/2 " Inlet; 3/4" NPT outlet Capacity: 26gpm Pressure: Maximum of 250psi Operating Speed: 550rpm Lubrication: Pump: 30oz Udor Lube or SAE 30W non-detergent oil Gear case: 16oz 90W Gear Lube Shaft Size: 1"
ENGINE:		8hp Honda; gasoline
CONTROL:		Built in pulsation Dampener
GAUGE:		Glycerin filled, 0-600psi, 0-42 kg
DISCHARGE HOSE:		3/4" x 10' (3m) 1000psi working pressure
INTAKE HOSE:		1" x 10' (3m)



Operating Instructions Models 46800 and 468000 Hydrostatic Test Pumps

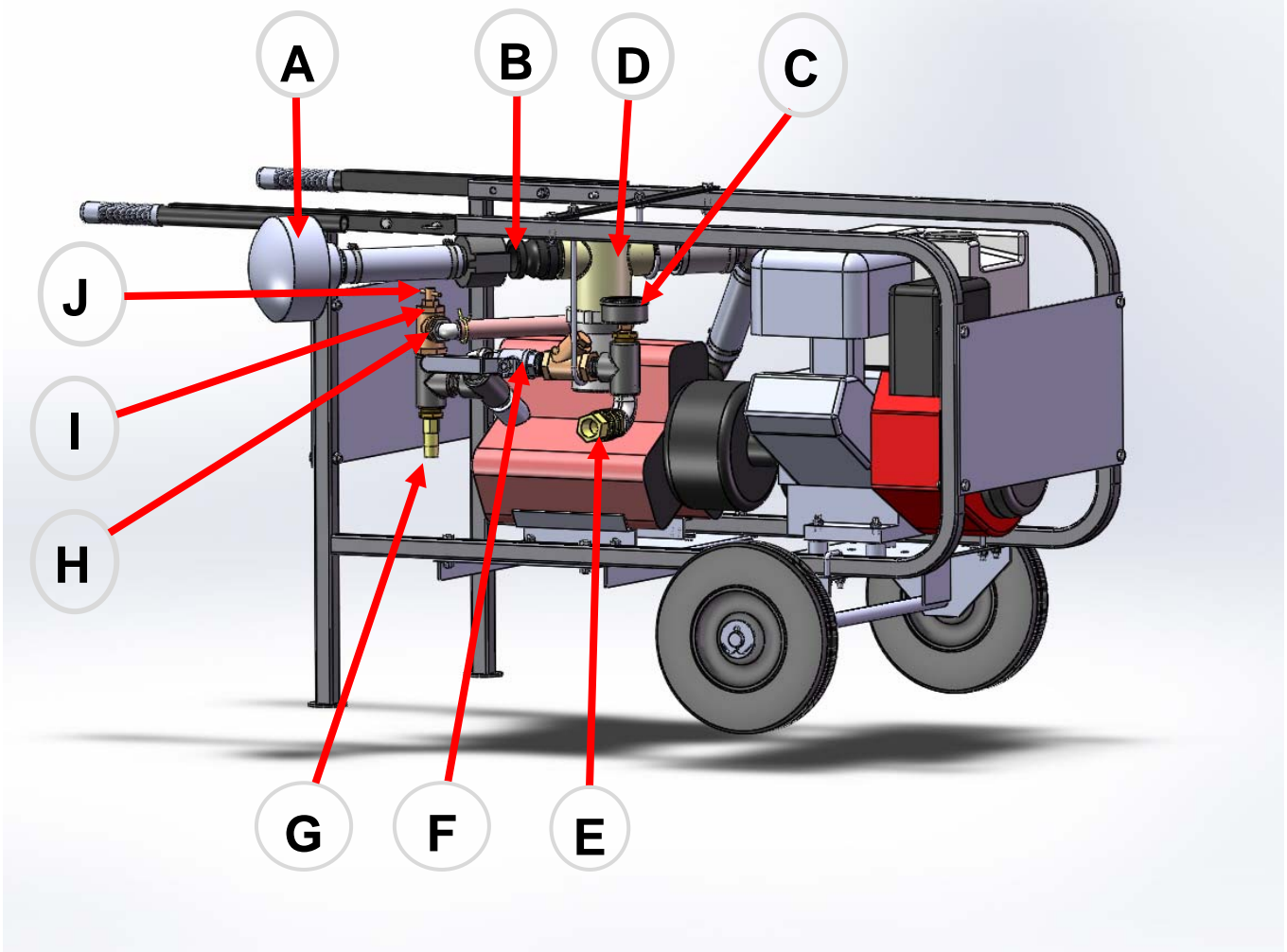

A	Suction Hose
B	Inlet Connection
C	Gauge
D	Strainer
E	Output Connection
F	Isolation Valve
G	Safety Valve
H	Pressure Relief Valve
I	Jam Nut
J	Pressure Relief Valve Knob



Operating Instructions Models 46800 and 468000 Hydrostatic Test Pumps

Gravity Feed Method: (Preferred Method)

1. Fill the water line (or test vessel) to be tested prior to pump connection.
2. Connect water supply hose (A) to the inlet connection (B) on the pump.
3. Open valve and turn water supply on.
4. Purge the pump & pressure hose of all air.
5. Connect output (pressure) hose between the pump outlet connection (E) and water line (or vessel) being tested.
6. Turn pump on.
7. Purge water line (or vessel) of all air at the highest point of the system.
8. Bring water line (or vessel) to pressure. Watch the gauge (C) while pumping. When the desired pressure is achieved; turn the isolation valve (F) to the 'off' position. The engine can now be turned off. If pressure drops off, there is a leak in the line.

Siphon Method

Use a clean water source

1. Fill the water line to be tested.
2. Fill the intake hose (A) with water, then quickly place the hose into a bucket and then turn the pump on. (The unit is self-priming once primed). Continue to pump until you see the water coming out of the outlet hose, with little or no air mixed with it.
3. Connect the output hose to the water line. Continue with steps 6 through 8 above in Gravity Feed Method.

Pre-Setting Your Pump

Your pump can be pre-set to a specific pressure easily by adjusting the pressure relief valve.

1. Loosen jam nut (I) and unscrew (counterclockwise direction) pressure relief valve knob (J) a few turns. Be sure not to unscrew the pressure relief valve knob all the way as small internal parts may fall out.
2. Add a ball valve (not supplied with the pump) to the end of the high pressure hose.
3. Follow steps 2 through 4 from the Gravity Feed Method above.
4. As water is flowing out of the high pressure hose, turn the ball valve to the "off" position.
5. Slowly start turning pressure relief valve knob (J) in the clockwise direction by 1/4 turn increments until you reach the desired pressure. Tighten jam nut (I).
6. Your test pump is now pre-set. This eliminates over-pressurizing the water line (or vessel).



Operating Instructions Models 46800 and 468000 Hydrostatic Test Pumps

Troubleshooting Your Pump

- Test pressure not being reached
 - ◇ Possible air in air in line (or vessel)
 - * Air needs to be purged from system.
 - * Check strainer (D) O-ring for cracks.
 - * Remove pump from system & follow steps 1 thru 6 of the 'Pre-Setting Your Pump' section.
 - * If using the Siphon Method and not getting pressure, try the Gravity Feed Method to ensure water is getting into the pump.
 - * Check inlet connection (B) for an airtight connection.
 - * Check suction hose (A) for obstructions in the hose or around the suction screen.
 - ◇ Pressure relief valve (H) not adjusted properly.
 - * Turn pressure relief valve knob (J) clockwise and watch for change in pressure.

Pump Maintenance

- Pump 50/50 antifreeze/water solution thru pump after each use to avoid freezing and to lubricate pump.
- Check strainer (D) O-ring for cracks prior to each use.
- Check & change engine oil per manufactures specs.
- Check pump oil level prior to each use.
- Check gear reduction oil prior to each use.
- Check gear reduction oil per manufacturers specifications.

Safety Valve

- Safety Valve is designed to "pop off" or bleed off any extra pressure.

CAUTION !!!
This pump is designed for water only!!

The pump is equipped with an adjustable pressure relief valve (H), which helps protect the system from being over pressurized. It can be preset by plugging the end of the hose. Turn the adjusting knob clockwise to increase pressure and counterclockwise to decrease.



WHEELER-REX LIMITED LIFETIME WARRANTY

WHEELER-REX covers its products with a Limited Lifetime Warranty, with exception of pipe threading machines which have a Limited Three Year Warranty (including electric motors). Warranties from manufacturers of components used in our products may pre-empt the Wheeler-Rex warranty. Wheeler-Rex warranties against defects in material or workmanship. To take advantage of this warranty, the complete product must be delivered prepaid to Wheeler-Rex or any WHEELER-REX AUTHORIZED SERVICE CENTER. No tools are to be returned to the factory without receiving prior authorization. Obviously, failures due to misuse, abuse, or normal wear and tear are not covered by this warranty. **NO OTHER WARRANTY, WRITTEN, OR ORAL, APPLIES. THERE ARE NO WARRANTIES WHICH EXTEND BEYOND THE DESCRIPTION ON THE FACE HEREOF.** No employee, agent, dealer, or other person is authorized to give any warranty on behalf of Wheeler-Rex. Warranted products will be repaired or replaced at our option, at no charge and returned to you via prepaid transportation. Such replacement or repair is the exclusive remedy available from Wheeler-Rex. Wheeler-Rex is not liable for damage of any sort, including incidental and consequential damages. Some U.S.A. states do not allow the exclusion or limitation of incidental or consequential damages, so the above limitation or exclusion may not apply. This warranty gives you specific legal rights, and you may also have other rights which vary from state to state.

Form # 1031

WARNING

GENERAL TOOL OPERATION WARNINGS

FOR ALL TOOLS-

1. **Keep Guards in Place** and in working order.
2. **Remove Adjusting Keys and Wrenches** from tool before turning it on.
3. **Keep Work Area Clean.** Cluttered areas and benches invite accidents.
4. **Avoid Dangerous Environment.** Don't use power tools in damp or wet locations. Keep work area well lit. Don't expose power tools to rain.
5. **If you must use an electric tool in a damp or wet location;** make sure it is plugged into a circuit which is protected by a ground fault interrupt.
6. **Keep Children Away. ALL VISITORS SHOULD BE KEPT A SAFE DISTANCE FROM WORK AREA.**
7. **Store Idle Tools** in dry, high, or locked-up place out of reach of children.
8. **Don't Force Tool.** It will do a better and safer job at the rate for which it is designed.
9. **Use Right Tool.** Don't force a small tool or attachment to do the job of a heavy-duty tool.
10. **Wear Proper Apparel.** No loose clothing or jewelry to get caught in moving parts. Rubber gloves and footwear are recommended when working outdoors.
11. **Use Safety Glasses.**
12. **Don't Abuse Cord.** Never carry tool by cord or yank it to disconnect from receptacle. Keep cord from heat, oil, and sharp edges.
13. **Secure Work.** Use clamps or vise to hold work when practical. It's safer than using your hand and it frees both hands to operate tool.
14. **Don't Overreach.** Keep proper footing and balance at all times.
15. **Maintain Tools Properly.** Keep tools sharp and clean for best and safest performance. Follow instructions for lubricating and changing accessories. Equipment operators must have proper maintenance & instruction sheets. Be sure the tool operator reads and understands this information. If you don't have current maintenance and instruction sheets, contact the factory & we will supply them at no charge.
16. **Disconnect Tools** when not in use; before servicing; when changing accessories such as dies, cutters, etc.
17. **Avoid Accidental Starting.** Don't carry plugged-in tool with finger on switch. Be sure switch is off when plugging in.
18. **Outdoor Use Extension Cords.** When tool is used outdoors, use only extension cords suitable for use outdoors and so marked.
19. **Wear Ear Protection** if exposed to long periods of very noisy shop operations.
20. **Do not operate tools** while under the influence of alcohol, drugs or medication.



46800 Hydrostatic Test Pump

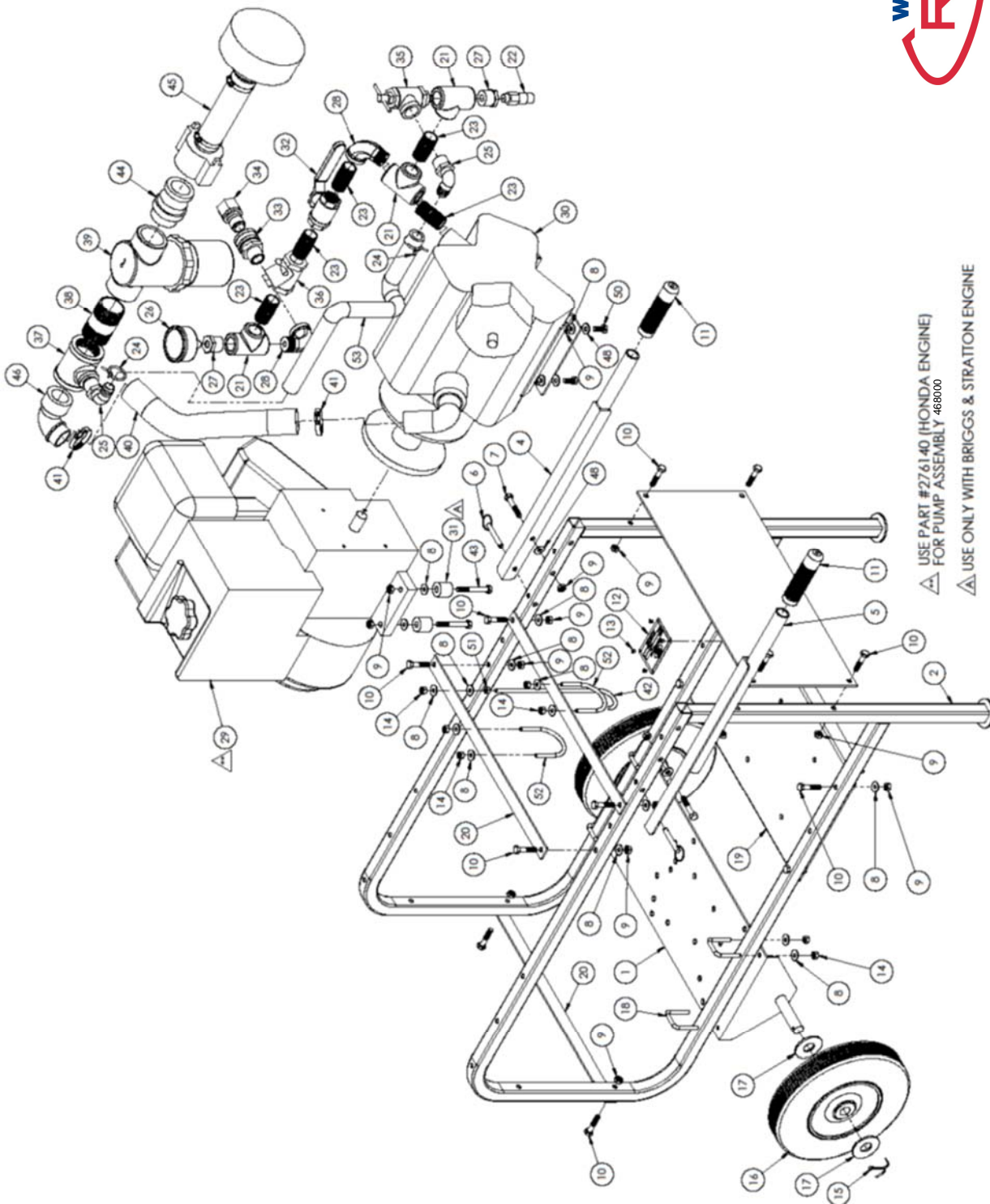

USE PART #276140 (HONDA ENGINE)
FOR PUMP ASSEMBLY 46800

USE ONLY WITH BRIGGS & STRATTON ENGINE

Item	Part No	Description	Qty
1	700943	AXLE ASSEMBLY	1
2	700387	CART SIDE	2
3	700958	END PLATE	1
4	700858	RIGHT HANDLE ASSEMBLY	1
5	700859	LEFT HANDLE ASSEMBLY	1
6	276752	COTTERLESS PIN w/ RING	2
7	275639	5/16-18 x 1 3/4" HHCS	2
8	276540	1/4" FLAT WASHER	34
9	275857	5/16-18 HEX NYLON-INSERTS LOCKNUTS	24
10	275638	5/16 x 1 1/2" HEX HEAD CAP SCREW	14
11	154	GRIP	2
12	220874	NAME PLATE	1
13	275543	POP RIVET, STAR 4-2AAD	4
14	275426	1/4-20 ESNA STOP NUT	13
15	276330	1/8 x 2 5/16 COTTER PIN	2
16	276441	THREADER CART WHEEL	2
17	276129	3/4" WASHER	4
18	700406	U-BOLT	4
19	700961	PUMP SUPPORT	1
20	700959	TOP SUPPORT	3
21	275644	3/4" TEE	3
22	275950	SAFETY VALVE, CAT 30960	1
23	275646	3/4" CLOSE NIPPLE	5
24	276105	HOSE CLAMP, 1 1/8" OD RC HC-18S	2
25	276116	3/4 MP x 3/4 MH 90 DEG HOSE BARB	2
26	36359	0-600 PSI GAUGE	1
27	276108	3/4" x 1/4" BRASS REDUCER BUSHING	2
28	275643	3/4" STREET ELBOW	2
29	276662	8 HP B&S ENGINE	1
30	276660	PUMP w/ 207P-12-14 ADAPTER	1
31	700892	SPACER	4
32	275636	3/4" BALL VALVE	1
33	276100	PH QD FEM HLF BST-6M	1
34	276101	PH QD MALE HALF BST N6	1
35	36331	RELIEF VALVE	1
36	275634	CHECK VALVE	1
37	276815	TEE 1 1/2" x 3/4" x 1 1/2"	1
38	276816	1 1/2" x 3" NIPPLE	1
39	276658	STRAINER ASSEMBLY	1
40	700965	HOSE 1 1/2" DIA x 10" LONG	1
41	276661	HOSE CLAMP	2
42	700963	J-BOLT LONG	1
43	276133	5/16-18 x 2 1/2" HHCS	4
44	276812	1 1/2" M Q/D	1
45	700685	INTAKE HOSE ASSY	1
46	276814	PVC 1 1/2" M NPT x 1 1/2" MALE HOSE BARB	1
47	222000	WARNING TAG **NOT SHOWN**	1
48	275685	5/16" FLAT WASHER	6
49	221065	HIGH PRESSURE HOSE **NOT SHOWN**	1
50	166	5/16-18 x 3/4 HEX HEAD CAP SCREW	4
51	275245	1/4-20 HEX NUT	1
52	275830	U-BOLT	2
53	700964	BY-PASS HOSE	1



Wheeler Rex ▪ 3744 Jefferson Road ▪ Ashtabula, Ohio 44005
Tel: 800-321-7950 or 440-998-2788 ▪ Fax: 440-992-2925
wheeler@wheelerrex.com ▪ www.wheelerrex.com