



# Underscore® 5' BubbleMassage™ Bath K-1168-GCR



## Features

- Chromatherapy lighting allows you to select a preferred color scheme to suit your mood.
- End drain.
- Slotted overflow for deep soaking.
- Integral lumbar support.
- 60" (1524 mm) x 32" (813 mm) x 21" (533 mm)

## Material

- Acrylic

## Hydrotherapy

- 122 BubbleMassage™ airjets. 18 levels of massage intensity.
- Zones of Control feature allows you to target massage to back, midsection, or feet.
- Automatic purge cycles remove residual water from air channels after use.
- Built-in 300 W heater.
- Lighted keypad control.

## Installation

- Drop-in or under-mount.

## Required Accessories

K- 7271 Brass Slotted Overflow Bath Drain

or

K- 7272 PVC Slotted Overflow Bath Drain

## Recommended Accessories

K- 1491 Bath/Whirlpool Pillow

K- 1601 Bath/Whirlpool Footstop

K- 1705 Whirlpool/BubbleMassage™ Remote Control

K- 590 Under-mount Installation Kit

K- 9498 3" Keypad Trim

K- 24916 Wireless Music Kit



## Codes/Standards

ASME A112.19.7/CSA B45.10

CSA B45.5/IAPMO Z124

ASTM E162

ASTM E662

UL 1795

CSA C22.2 No. 218.2

Greenguard UL 2818 - Gold

CARB P2

## KOHLER® One-Year Limited Warranty

See website for detailed warranty information.

## Available Color/Finishes

*Color tiles intended for reference only.*

| Color | Code | Description   |
|-------|------|---------------|
|       | 0    | White         |
|       | 96   | Biscuit       |
|       | 47   | Almond        |
|       | NY   | Dune          |
|       | 95   | Ice™ Grey     |
|       | G9   | Sandbar       |
|       | 33   | Mexican Sand™ |
|       | K4   | Cashmere      |
|       | 58   | Thunder™ Grey |
|       | 7    | Black Black™  |

USA/Canada: 1-800-4KOHLER (1-800-456-4537)

Kohler Co. reserves the right to make revisions without notice to product specifications.

For the most current Specification Sheet, go to [www.kohler.com](http://www.kohler.com).

3-27-2016 02:23

THE BOLD LOOK  
OF **KOHLER**®

No change in measurements if connected with drain illustrated. (K-7272)

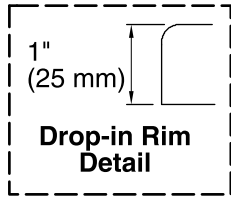

Blower Motor/Control Access  
34" (864 mm) W x 15" (381 mm) H Min

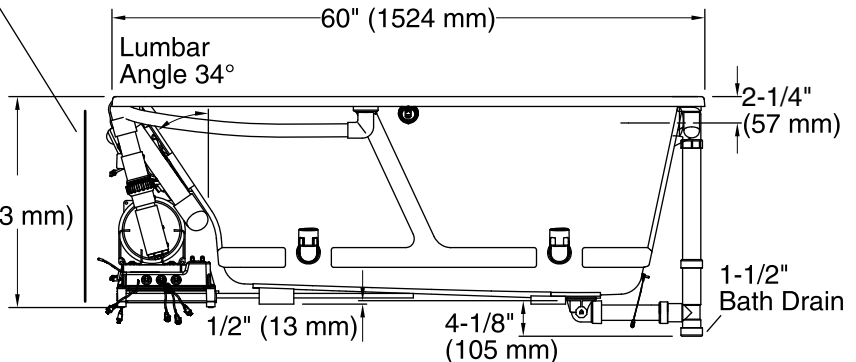
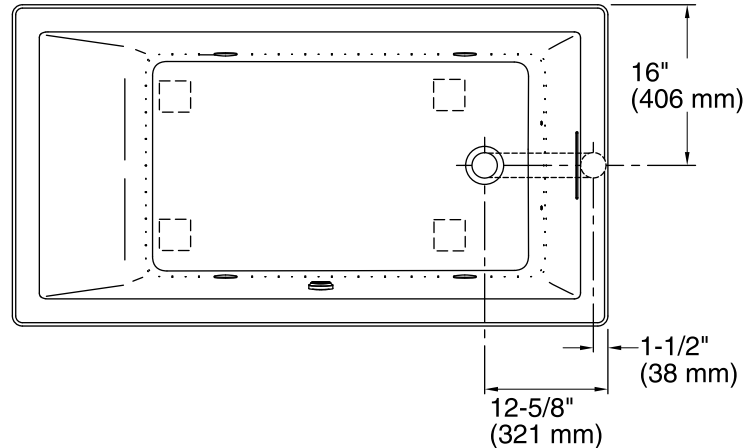
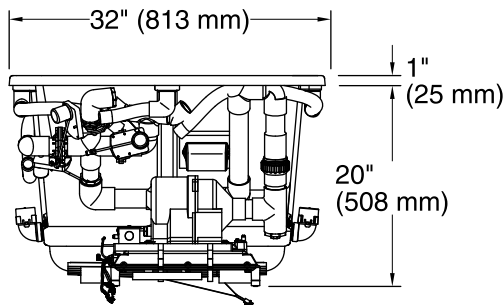

### Required Electrical Service

One dedicated circuit required, protected with Class A Ground-Fault Circuit-Interrupter (GFCI) or Residual Current Device (RCD).

Blower: 240 V, 15 A, 50/60 Hz

### Technical Information

All product dimensions are nominal.

|                              |   |
|------------------------------|---|
| Installation:                | Drop-in, Under-mount                          |
| Drain location:              | End   |
| Basin area, bottom:          | 42" x 23-1/2" (1067 mm x 597 mm)              |
| Basin area, top:             | 55-1/8" x 27-1/8" (1400 mm x 689 mm)          |
| Weight:                      | 100 lbs (45.4 kg)                             |
| Minimum floor load:          | 55 lbs/ft² (268.5 kg/m²)                      |
| Water depth:                 | 17-1/8" (435 mm)                              |
| Water capacity:              | 81 gal (306.6 L)                              |
| Cutout:                      | Drop-in, 59-1/2" x 31-1/2" (1511 mm x 800 mm) |
| Electrical component rating: | Blower: 240 V, 5 A, 50/60 Hz, 300 W           |
| Blower speed:                | Variable                                      |
| Minimum flat for door:       | 2-3/8" (61 mm)                                |

### Notes

Measure your actual product for rough-in details.

Install this product according to the installation instructions.

The hot water supply should be 70% of the capacity of the bath or greater. Installations will vary.

If relocating the blower motor, do not relocate or alter the PVC tee or coiled flexible tubing connected to the blower. Follow the blower relocation instructions exactly. Provide access for servicing the blower.