

# Victaulic® No. T-60 Test Cap Kit for Metallic IPS Pipe



## 1.0 PRODUCT DESCRIPTION

### Available Sizes

- Kit includes 2 – 8"/50 – 200 mm IPS T-60 Test Caps (Two per size - 2", 2½", 3", 4", 6" and 8").
- Individual T-60 Test Caps in 2 – 12"/50 – 300 mm sizes may be ordered separately.

### NOTES

- The 2 – 8"/50 – 200 mm T-60 Test Caps come with a ¾" NPT ball valve.
- The 10"/250 mm and 12"/300 mm T-60 Test Caps come with a 1" NPT ball valve.

### Pipe Material

- For use on metallic IPS pipe.
- Contact Victaulic for use on nonmetallic IPS pipe (such as PVC or CPVC).

### Maximum Test Pressure

- 250 psi/1724 kPa/17 bar.
- Test pressure shall not exceed joint rating at point of attachment.

### Test Media

- Water and glycol fluids, air and inert gases. For other media, contact Victaulic.

### Maximum Test Temperature

- Not to exceed 110°F/43°C.

### Application

- T-60 Test Caps contain a ball valve which provides another means to verify whether the piping system is unpressurized (atmospheric pressure) and empty of test media before removal of the T-60 Test Cap.
- T-60 Test Caps may be used for filling, testing or draining purposes by connecting to the female NPT outlet of the ball valve. The installer is responsible for verifying the suitability of all connected components.
- T-60 Test Caps are intended for use during piping system testing activities and therefore, for temporary use only. T-60 Test Caps shall not be permanently installed within a piping system.
- T-60 Test Caps can be used repeatedly within the maximum test pressure shown above provided the product remains undamaged. It is the responsibility of the installer to inspect and verify the suitability for service of all T-60 Test Caps prior to installation and use.
- T-60 Test Caps are recommended for use with Victaulic Style 107N Installation-Ready™ Rigid Couplings and Victaulic Style 07 Zero-Flex™ Rigid Couplings.

**ALWAYS REFER TO ANY NOTIFICATIONS AT THE END OF THIS DOCUMENT REGARDING PRODUCT INSTALLATION, MAINTENANCE OR SUPPORT.**

System No.		Location	
Submitted By		Date	

Spec Section		Paragraph	
Approved		Date	

## 2.0 CERTIFICATION/LISTINGS

Not applicable – contact Victaulic with any questions.

## 3.0 SPECIFICATIONS - MATERIAL

**Cap:** Ductile iron per ASTM A536, Grade 65-45-12.

**Ball Valve**

**Body:** Forged brass UNS C37700.

**Ball:** Forged brass UNS C37700, chrome-plated.

**Stem:** Forged brass UNS C37700.

**Seat:** Polytetrafluoroethylene (PTFE).

**Handle:** Chrome-plated carbon steel.

**Stem Nut:** Nickel-plated carbon steel.

**Stem Packing:** Polytetrafluoroethylene (PTFE).

## 4.0 DIMENSIONS

**Test Cap Assembly  
No. T-60**

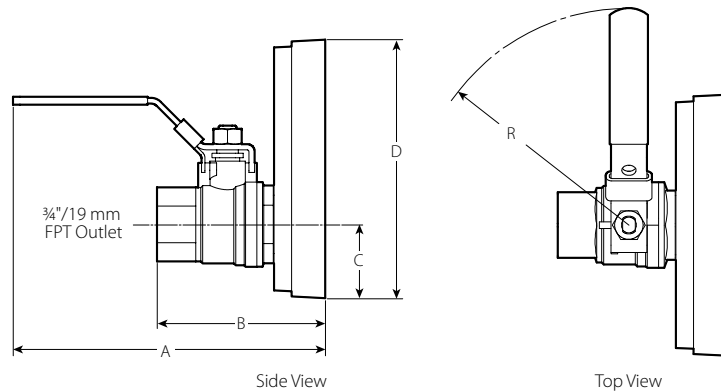

2 – 8\"/>

### 3/4\"/>

Pipe Size		Dimensions				Weight
Nominal inches DN	Actual Outside Diameter "D" inches mm	A inches mm	B inches mm	C inches mm	R inches mm	Approximate (Each) lb kg
2 DN50	2.375 60.3	5.50 140	3.00 76	1.13 29	3.88 99	1.4 0.6
2½	2.875 73.0	5.50 140	3.00 76	1.25 32	3.88 99	1.7 0.7
3 DN80	3.500 88.9	5.50 140	3.00 76	1.25 32	3.88 99	2.3 1.0
4 DN100	4.500 114.3	5.63 143	3.00 76	1.38 36	3.88 99	3.5 1.6
6 DN150	6.625 168.3	5.63 143	3.00 76	1.50 39	3.88 99	7.0 3.2
8 DN200	8.625 219.1	5.75 147	3.25 83	1.63 42	3.88 99	13.8 6.2

### NOTES

- The 2 – 4\"/>
- The 6 – 8\"/>
- The entire rolling storage case weighs 89.0 lbs/40.4 kg.

4.0 DIMENSIONS (Continued)

Test Cap Assembly  
No. T-60

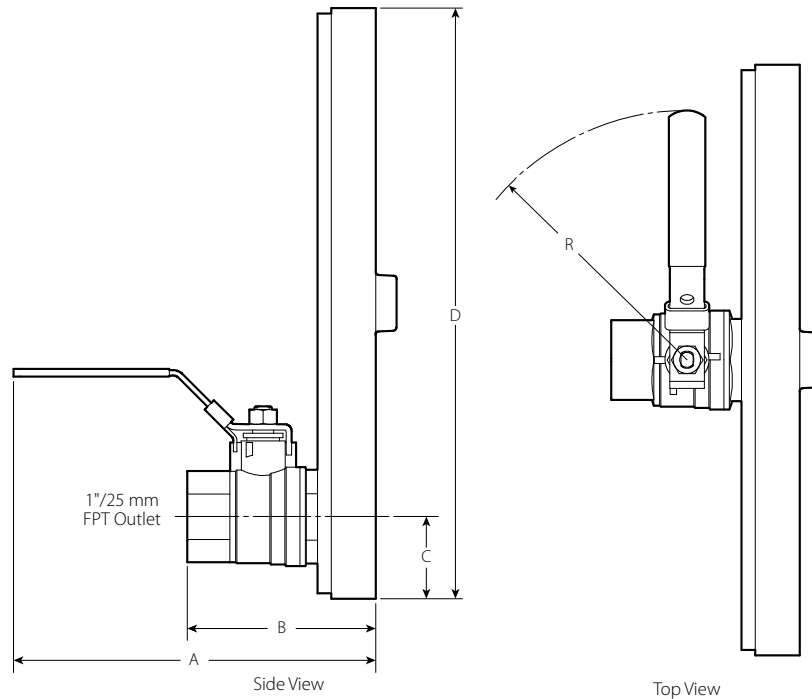

10\"/>

1" NPT Ball Valve Test Caps

Pipe Size		Dimensions				Weight
Nominal inches DN	Actual Outside Diameter "D" inches mm	A inches mm	B inches mm	C inches mm	R inches mm	Approximate (Each) lb kg
10 DN250	10.750 273.0	6.63 169	3.50 89	1.50 39	4.63 118	24.0 10.9
12 DN300	12.750 323.9	6.88 175	3.63 92	1.38 35	4.63 118	38.8 17.6

## 5.0 PERFORMANCE

### Maximum Test Pressure

- 250 psi/1724 kPa/17 bar.

### Maximum Test Temperature

- Not to exceed 110°F/43°C.

T-60 Test Caps can be used repeatedly within the maximum test pressure shown above provided the product remains undamaged. It is the responsibility of the installer to inspect and verify the suitability for service of all T-60 Test Caps prior to installation and use.

## 6.0 NOTIFICATIONS

### WARNING



- **COUPLING/T-60 TEST CAP ASSEMBLY MAY BE UNDER PRESSURE**

- **Before attempting to loosen or remove the coupling/T-60 test cap, always depressurize and drain the piping system completely and verify before proceeding with removal.**
- **Use caution when opening the ball valve. Be sure the ball valve opening is clear of obstructions.**
- **Keep face and other body parts away from the ball valve's outlet when attempting to test the system.**
- **Do not tamper with the ball valve. The user is responsible for verifying that the test cap assembly is not damaged and is in proper working condition prior to use.**

**Failure to follow these instructions could result in death or serious personal injury and property damage.**

- Test pressure shall not exceed joint rating at point of attachment. Joint rating is affected by pipe size, material and wall thickness.
- For use only with Victaulic IPS grooved pipe couplings on metallic IPS pipe. For use on nonmetallic IPS pipe (such as PVC and CPVC), contact Victaulic.
- CAUTION: Pipe plug shall not be installed in the female NPT outlet of the ball valve.

## 7.0 REFERENCE MATERIALS

[O6.15: Victaulic Steel Pipe Pressure Ratings/End Loads Design Data](#)

[I-100: Victaulic Field Installation Handbook](#)

[I-107N: Victaulic QuickVic™ Rigid Coupling Style 107N Installation Manual](#)

### User Responsibility for Product Selection and Suitability

Each user bears final responsibility for making a determination as to the suitability of Victaulic products for a particular end-use application, in accordance with industry standards and project specifications, and the applicable building codes and related regulations as well as Victaulic performance, maintenance, safety, and warning instructions. Nothing in this or any other document, nor any verbal recommendation, advice, or opinion from any Victaulic employee, shall be deemed to alter, vary, supersede, or waive any provision of Victaulic Company's standard conditions of sale, installation guide, or this disclaimer.

### Intellectual Property Rights

No statement contained herein concerning a possible or suggested use of any material, product, service, or design is intended, or should be construed, to grant any license under any patent or other intellectual property right of Victaulic or any of its subsidiaries or affiliates covering such use or design, or as a recommendation for the use of such material, product, service, or design in the infringement of any patent or other intellectual property right. The terms "Patented" or "Patent Pending" refer to design or utility patents or patent applications for articles and/or methods of use in the United States and/or other countries.

### Note

This product shall be manufactured by Victaulic or to Victaulic specifications. All products to be installed in accordance with current Victaulic installation/assembly instructions. Victaulic reserves the right to change product specifications, designs and standard equipment without notice and without incurring obligations.

### Installation

Reference should always be made to the Victaulic installation handbook or installation instructions of the product you are installing. Handbooks are included with each shipment of Victaulic products, providing complete installation and assembly data, and are available in PDF format on our website at [www.victaulic.com](http://www.victaulic.com).

### Warranty

Refer to the Warranty section of the current Price List or contact Victaulic for details.

### Trademarks

*Victaulic* and all other Victaulic marks are the trademarks or registered trademarks of Victaulic Company, and/or its affiliated entities, in the U.S. and/or other countries.