

Series 78Y/78U Manual Koil-Kit™ Coil Pack with TA Series 78BL Balancing Ball Valve

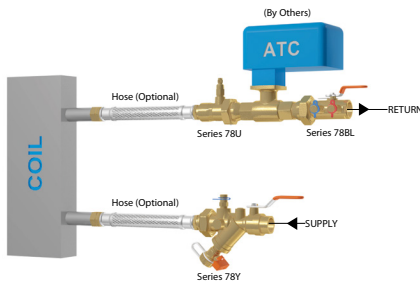

1.0 PRODUCT DESCRIPTION

Available Sizes

- ½ – 2”/DN15 – DN50

Maximum Working Pressure

- Up to 400 psi/2758 kPa/27.6 bar

NOTE

- Coil hose ratings may vary from the maximum working pressure rating stated above. If a coil hose is included, please refer to the Coil Hose table on page 6 for more information.

Operating Temperature Range

- –4°F to +230°F/–20°C to +110°C

Function

- Provides simplified coil circuit installation that meets optimal hydronic system design requirements

Application

- Hot and cold water, including treated and untreated water systems
- This KOIL-KIT™ Coil Pack is available with or without hoses
 - KOIL-KIT™ Coil Pack with sweat ends and without hoses includes:
 - (1) Series 78Y Y-Strainer/Ball Valve Combination – Sweat x Sweat
 - (1) Series 78U Union Port Fitting – Sweat x Male Union
 - (1) TA Series 78BL Balancing Ball Valve – Sweat x Sweat
 - KOIL-KIT™ Coil Pack with threaded ends and without hoses includes:
 - (1) Series 78Y Y-Strainer/Ball Valve Combination – Female x Female
 - (1) Series 78U Union Port Fitting – Female x Male Union
 - (1) TA Series 78BL Balancing Ball Valve – Female x Female
 - KOIL-KIT™ Coil Pack with threaded ends and with hoses includes:
 - (1) Series 78Y Y-Strainer/Ball Valve Combination – Female x Female with 2' Male x Male Union Hose
 - (1) Series 78U Union Port Fitting – Female x Male Union with 2' Male x Male Union Hose
 - (1) TA Series 78BL Balancing Ball Valve – Female x Female

NOTE

- The Series 78Y includes a PT port and a blow-down valve. The Series 78U includes a PT port and a manual air vent.

ALWAYS REFER TO ANY NOTIFICATIONS AT THE END OF THIS DOCUMENT REGARDING PRODUCT INSTALLATION, MAINTENANCE OR SUPPORT.

System No.		Location	
Submitted By		Date	

Spec Section		Paragraph	
Approved		Date	

2.0 CERTIFICATION/LISTINGS

Product designed and manufactured under the Victaulic Quality Management System, as certified by LPCB in accordance with ISO-9001:2008.

3.0 SPECIFICATIONS – MATERIAL

Series 78Y Y-Strainer/Ball Valve Combination

Body: Dezincification resistant (DZR) brass alloy

Union: DZR brass with EPDM O-ring

Tailpiece: DZR brass

Stem: Brass

Stem O-Ring Seals: EPDM

Ball: Plated brass

Handle: Steel with vinyl grip

Strainer: Stainless steel, 20 mesh

Strainer Seal: EPDM O-ring

Series 78U Union Port Fitting

Body: DZR brass alloy

Union: DZR brass with EPDM O-ring

Seals: EPDM O-ring

Tailpiece: DZR brass alloy

TA Series 78BL Balancing Ball Valve

Body and End Face: Low-lead brass equivalent to UNS C69300

O-Rings: EPDM suitable for service with propylene and ethylene glycol mixtures up to 50% by volume in water

Blowout Proof Stem: Stainless steel

Ball: Stainless steel

Ball Seats: Polytetrafluoroethylene (PTFE).

Indexing Handle with Adjustable Memory Stop: Zinc-plated carbon steel with a vinyl dip

Positioning Pin and Dial Scale: UNS S30400

Fixed Connection: Female NPT or sweat

Coil Hose

Hose: Braided stainless steel

Core: EPDM polymer with stainless ferrules

End Material: CW617 brass

4.0 DIMENSIONS

Series 78Y Y-Strainer/Ball Valve Combination

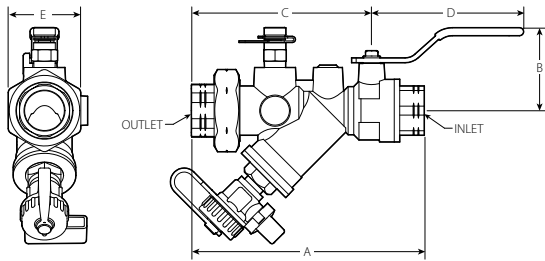

Size			Dimensions					Weight			
Nominal Inlet x Outlet inches DN	Actual Outside Diameter		A Sweat or Female Threaded End inches mm	B inches mm	C inches mm	D inches mm	E inches mm	Approx. (Each) lb kg			
	Inlet	Outlet							Inlet	Outlet	
1/2 DN15	x	1/2 DN15	0.840 21.3	x	0.840 21.3	5.10 130	1.90 49	3.80 97	4.00 100	1.50 38	1.7 0.8
3/4 DN20	x	3/4 DN20	1.050 26.9	x	1.050 26.9	6.10 155	2.00 51	4.60 117	4.00 100	1.80 46	2.4 1.1
1 DN25	x	1 DN25	1.315 33.7	x	1.315 33.7	6.40 163	2.00 51	4.90 124	4.00 100	1.80 46	2.4 1.1
1 1/4 DN32	x	1 1/4 DN32	1.660 42.4	x	1.660 42.4	8.00 203	2.40 61	6.10 155	5.30 135	2.60 66	5.4 2.4
1 1/2 DN40	x	1 1/2 DN40	1.900 48.3	x	1.900 48.3	8.10 206	2.40 61	6.10 155	5.30 135	2.60 66	5.4 2.4
2 DN50	x	2 DN50	2.375 60.3	x	2.375 60.3	11.20 284	3.10 79	8.50 216	5.90 151	3.30 84	11.5 5.2

NOTE

- Optional tailpieces may be ordered for reductions and for changing end configurations from sweat to threaded or threaded to sweat. If needed, specify optional tailpiece when ordering.

4.1 DIMENSIONS

Series 78U Union Port Fitting

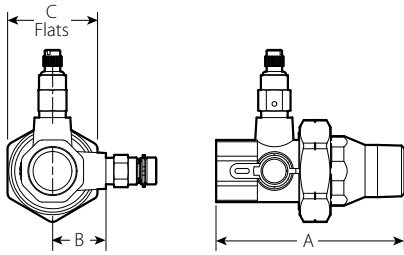

Size		Dimensions			Weight
Nominal Inlet x Outlet inches DN	Actual Outside Diameter Inlet x Outlet inches mm	A Sweat or Female Threaded End inches mm	B inches mm	C inches mm	Approx. (Each) lb kg
1/2 DN15 x 1/2 DN15	0.840 x 0.840 21.3 x 21.3	3.48 89	0.84 21	1.46 37	0.7 0.3
3/4 DN20 x 1/2 DN15	1.050 x 0.840 26.9 x 21.3	3.87 98	1.08 27	1.81 46	1.0 0.5
		3.87 98	1.08 27	1.81 46	0.9 0.4
1 DN25 x 1/2 DN15	1.315 x 0.840 33.7 x 21.3	4.03 102	1.08 27	1.81 46	1.0 0.5
		4.03 102	1.08 27	1.81 46	1.1 0.5
		4.14 105	1.08 27	1.81 46	1.1 0.5
1 1/4 DN32 x 1/2 DN15	1.660 x 0.840 33.7 x 21.3	4.36 111	1.46 37	2.63 67	1.9 0.9
		4.36 111	1.46 37	2.63 67	1.9 0.9
		4.36 111	1.46 37	2.63 67	1.9 0.9
		4.19 106	1.46 37	2.63 67	2.1 1.0
1 1/2 DN40 x 3/4 DN20	1.900 x 1.050 48.3 x 26.9	4.19 106	1.46 37	2.63 67	2.2 1.0
		4.19 106	1.46 37	2.63 67	2.2 1.0
		4.19 106	1.46 37	2.63 67	2.3 1.0
		4.19 106	1.46 37	2.63 67	2.3 1.0
		4.40 112	1.46 37	2.63 67	2.3 1.0
2 DN50 x 1 DN25	2.375 x 1.315 60.3 x 33.7	4.47 114	1.76 45	3.26 83	3.1 1.4
		4.47 114	1.76 45	3.26 83	3.1 1.4
		4.47 114	1.76 45	3.26 83	3.2 1.5
		4.47 114	1.76 45	3.26 83	3.2 1.5
		4.47 114	1.76 45	3.26 83	3.2 1.5

NOTE

- Optional tailpieces may be ordered for reductions and for changing end configurations from sweat to threaded or threaded to sweat. If needed, specify optional tailpiece when ordering.

4.2 DIMENSIONS

TA Series 78BL Balancing Ball Valve

Female NPT

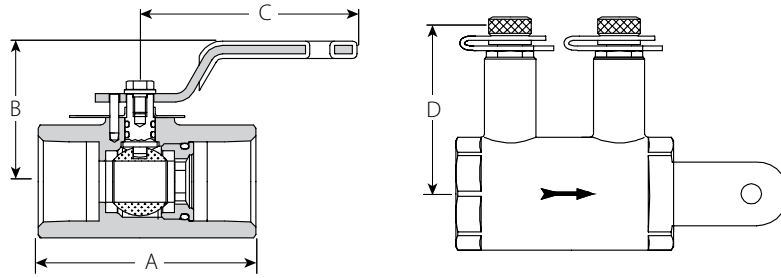

Body Size inches DN	Dimensions				Full Open C _v K _v	Flow Range GPM L/H	Weight
	A inches mm	B inches mm	C inches mm	D inches mm			Approximate (Each) lb kg
1/2 DN50	2.38 60	1.50 38	2.50 64	1.88 48	2.83 2.45	0.38 - 5.30 86.3 - 1204	0.6 0.3
3/4 DN20	2.50 64	1.63 41	2.50 64	2.00 51	6.67 5.77	0.94 - 12.48 213 - 2834	0.8 0.4
1 DN125	3.13 79	2.00 51	4.00 102	2.13 54	10.32 8.93	1.56 - 19.30 354 - 4383	1.3 0.6
1 1/4 DN32	3.38 86	2.25 57	4.00 102	2.25 57	16.31 14.11	2.11 - 30.50 479 - 6927	2.0 0.9
1 1/2 DN40	3.63 92	2.50 64	4.75 121	2.38 60	24.30 21.02	2.68 - 45.40 609 - 10310	2.8 1.3
2 DN50	4.13 105	2.75 70	4.75 121	2.63 67	45.30 39.18	6.18 - 85.00 1404 - 19304	4.4 2.0

4.3 OPTIONAL PARTS

Coil Hose (Optional)



Size inches DN	Inlet Options		Rated Pressure psi kPa	Minimum Bend Radius inches mm	Nominal Length inches mm	Weight
	A Male End Thread	B NPSM MNPT Swivel Union				Approx. (Each) lb kg
1/2 DN15	x 1/2 NPT	1/2	375 2585	2.6 66.7	24 610	0.5 0.2
3/4 DN20	x 3/4 NPT	3/4	300 2068	4.5 114.3	24 610	1.0 0.5
1 DN25	x 1 NPT	1	300 2068	5.5 139.7	24 610	1.5 0.7
1 1/4 DN32	x 1 1/4 NPT	1 1/4	225 1550	6.8 171.5	24 610	2.0 0.9
1 1/2 DN40	x 1 1/2 NPT	1 1/2	150 1034	8.4 212.7	24 610	4.4 2.0
2 DN50	x 2 NPT	2	150 1034	11.3 285.8	24 610	4.8 2.2

4.4 OPTIONAL PARTS

Series 78Y/78U Union Tailpieces (Optional)



Female Tailpiece

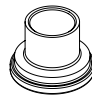

Sweat Tailpiece

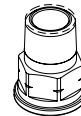

Male Tailpiece

Size		Victaulic Part Code		
Nominal inches		Female Tailpiece	Sweat Tailpiece	Male Tailpiece
1/2	x 1/2	P00478Y304	P00478Y504	P00478U404
3/4	x 1/2	P00678Y304	P00678Y504	P00678U404
		P00678Y306	P00678Y506	P00678U406
1	x 1/2	P00678Y304*	P00678Y504*	P00678U404*
		P00678Y306*	P00678Y506*	P00678U406*
		P00678Y310	P00678Y510*	P00678U410*
1 1/4	x 1/2	-	-	P01278U404
		P01278Y306	P01278Y506	P01278U406
		P01278Y310	P01278Y510	P01278U410
		P01278Y312	P01278Y512	P01278U412
1 1/2	x 1/2	-	-	P01278U404*
		P01278Y306*	P01278Y506*	P01278U406*
		P01278Y310*	P01278Y510*	P01278U410*
		P91278Y312*	P01278Y512*	P01278U412*
		P01278Y314	P01278Y514*	P01278U414*
2	x 1	-	-	P02078U410*
		P02078Y312*	P01278Y512*	P02078U412*
		P02078Y314*	P01278Y514*	P02078U414*
		P02078Y320	P02078Y520*	P02078U420*

NOTE

* When swapping a tailpiece from the line size female tailpiece provided, a union collar is also needed. The 1", 1 1/2" and 2" female tailpieces have an integrated collar that cannot be reused with these tailpieces. See "Union Collar" chart in section 4.5 for more information.

4.5 OPTIONAL PARTS

Union Collar



Valve Size	Victaulic Part Code
Nominal inches	
1/2	P00478Y204
3/4 - 1	P00678Y206
1 1/4 - 1 1/2	P01278Y212
2	P02078Y220

4.6 OPTIONAL PARTS

Hose End Drain Valve (Optional)

A hose end drain valve is factory-installed on the Series 78Y. This product can also be mounted on the Series 78U or provided loose for other piping needs.

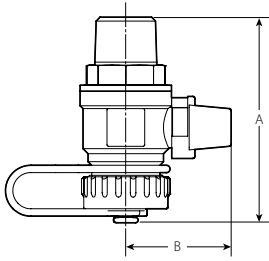

Size	Dimensions		Part Code
	A	B	
NPT	inches	inches	
	mm	mm	
¼	2.04	1.37	P00278YDRN
6	52	35	
½	2.74	1.53	P00478YDRN
13	70	39	

4.7 OPTIONAL PARTS

Probe Port (Optional)

For Series 78Y

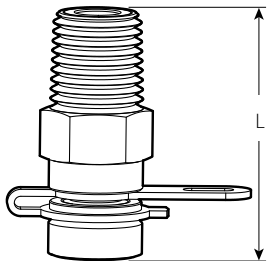

Connection Size	Dimensions		Part Code
	L		
	inches		
	mm		
¼ NPT	1.55		P00278YPTP
	39		

4.8 OPTIONAL PARTS

Port Extender (Optional)

For Series 78Y & 78U

The port extender is used to extend accessories to clear 2"/50 mm or 4"/100 mm insulation (M x F ¼"). Extends probe port and air vent.



Length inches mm	Victaulic Part Code
2 50	P01278Y2XT
4 100	P04378Y0XT

4.9 OPTIONAL PARTS

Handle Extension (Optional)

For Series 78Y

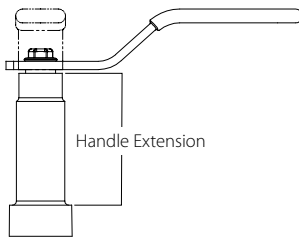

Valve Inlet Size	Victaulic Part Code	
	2" Handle Extension	4" Handle Extension
½ – 1"	P00478Y2HL	P00478Y4HL
1 ¼ – 1 ½"	P01278Y2HL	P01278Y4HL
2"	P02078Y2HL	P02078Y4HL

4.10 OPTIONAL PARTS

Air Vent

A manual air vent is factory-installed on the Series 78U. This product can also be mounted on the Series 78Y or provided loose for other piping needs.

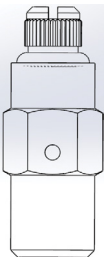

Connection Size	Part Code
¼ NPT	P00278UMAV

4.11 OPTIONAL PARTS

Replacement O-Rings

Valve Size inches	Series 78Y, 78T & 78U End Face O-Rings (Sold in Bags of 10)	Series 78Y Strainer O-Rings (Sold in Bags of 10)
½	P004799ORG	G00478YGSK
¾ – 1	P006799ORG	G00678YGSK
1¼ – 1½	P012799ORG	G01278YGSK
2"	P020799ORG	G02078YGSK

4.12 OPTIONAL PARTS

Replacement Series 78Y Strainer Basket

Valve Size inches	Part Code
½	P00478YSTN
¾ – 1	P00678YSTN
1¼ – 1½	P01278YSTN
2	P02078YSTN

4.13 OPTIONAL PARTS

Hose Adapter Replacement Parts

Size inches	Part Code			
	Male Adapter	Female Adapter	Sweat Adapter	O-Rings (Bag of 10)
½	P004799MOR	P004799FOR	P004799SOR	K004799HOR
¾	P006799MOR	P006799FOR	P006799SOR	K006799HOR
1	P010799MOR	P010799FOR	P010799SOR	K010799HOR
1¼	P012799MOR	P012799FOR	P012799SOR	K012799HOR
1½	P014799MOR	P014799FOR	P014799SOR	K014799HOR
2	P020799MOR	P020799FOR	P020799SOR	K020799HOR

5.0 PERFORMANCE

Cv/Kv values for flow of water at +60°F/+16°C are shown in the table.

Formulas for Cv and Kv values

$$\Delta P = Q^2/Cv^2$$

$$\Delta P = Q^2/Kv^2$$

Where:

$$Q = Cv \times \sqrt{\Delta P}$$

$$Q = Kv \times \sqrt{\Delta P}$$

Flow Coefficient	Cv	Kv
Q (Flow)	GPM	m ³ /hr
ΔP (Pressure Drop)	psi	bar

Series 78Y Y-Strainer/Ball Valve Combination

Size		Flow Coefficient (Fully Open)	
Nominal inches DN	Actual Outside Diameter inches mm	Threaded Cv Kv	Sweat Cv Kv
½ DN15	0.840	5.1	4.3
	21.3	4.4	3.7
¾ DN20	1.050	7.8	7.7
	26.9	6.7	6.7
1 DN25	1.315	7.4	8.5
	33.7	6.4	7.3
1 ¼ DN32	1.660	28.8	25.0
	42.4	25.0	21.6
1 ½ DN40	1.900	28.8	25.0
	48.3	24.9	21.6
2 DN50	2.375	56.6	49.6
	60.3	49.0	42.1

Series 78U Union Port Fitting

Size		Flow Coefficient (Fully Open)	
Nominal inches DN	Actual Outside Diameter inches mm	Threaded Cv Kv	Sweat Cv Kv
½ DN15	0.840	9.8	6.1
	21.3	6.1	5.3
¾ DN20	1.050	21.2	17.3
	26.9	17.2	14.9
1 DN25	1.315	41.4	35.3
	33.7	35.2	30.4
1 ¼ DN32	1.660	76.0	61.0
	42.4	6.2	52.6
1 ½ DN40	1.900	103.0	82.7
	48.3	6.8	71.3
2 DN50	2.375	159.5	127.9
	60.3	137.9	110.3

Coil Hose

Size		Nominal Length inches mm	Flow Coefficient (Fully Open)	
Nominal inches DN	Actual Outside Diameter inches mm		Straight Form Cv Kv	90° Bend Cv Kv
½ DN15	0.840	24	3.5	3.4
	21.3	600	3.0	3.0
¾ DN20	1.050	24	10.0	9.6
	26.9	600	8.7	8.3
1 DN25	1.315	24	18.9	18.3
	33.7	600	16.3	15.8
1 ¼ DN32	1.660	24	33.0	32.6
	42.4	600	28.4	28.1
1 ½ DN40	1.900	24	63.1	60.2
	48.3	600	54.4	51.9
2 DN50	2.375	24	114.6	Not Recommended
	60.3	600	98.8	

5.1 PERFORMANCE

TA Series 78BL Balancing Ball Valve

Sizing

When Δp and design flow is known, calculate the Cv by using the formula provided. Select the valve size so the setting will be approximately 75% of total opening.

$$Cv = 1.52 \frac{q}{\sqrt{\Delta p}} \quad q \text{ in GPM, } \Delta p \text{ in ft WG}$$

$$Cv = \frac{q}{\sqrt{\Delta p}} \quad q \text{ in GPM, } \Delta p \text{ in psi}$$

Cv Versus Handle Position Table - Threaded

Handle Position	Average Cv					
	1/2"	3/4"	1"	1 1/4"	1 1/2"	2"
0	0.00	0.00	0.00	0.00	0.00	0.00
1	0.00	0.03	0.03	0.03	0.00	0.06
2	0.03	0.12	0.18	0.16	0.17	0.60
3	0.08	0.23	0.36	0.45	0.51	1.34
4	0.14	0.32	0.58	0.74	0.95	2.33
5	0.21	0.50	0.83	1.13	1.43	3.30
7.5	0.43	0.92	1.54	2.21	3.03	6.45
10	0.71	1.63	2.54	3.80	5.41	11.13
12.5	1.10	2.61	3.90	5.95	8.91	17.77
15	1.63	3.76	5.73	8.65	13.02	26.12
17.5	2.58	5.89	8.86	13.25	20.14	40.36
20	2.83	6.67	10.32	16.31	24.27	45.31

5.2 PART CODES

Kit Description	Nominal Kit Size	Expected Control Valve Size (Series 78U Outlet Size)	Balancing Valve Size	Without Customer-Supplied ATC Valve	
				Without PT Ports and Handle Extensions	With PT Ports and Handle Extensions
				Victaulic Figure String	
78Y Sweat x Sweat, 78U Sweat x Male Union, 78BL Male Union x Sweat without hoses	1/2	1/2	1/2	K9YASAS00000ASAM0LAMAS000	K9YASAS00000ASAM0LAMAS020
	3/4	1/2	3/4	K9YBSBS00000BSAM0LAMBS000	K9YBSBS00000BSAM0LAMBS020
	3/4	3/4	3/4	K9YBSBS00000BSBM0LBMS000	K9YBSBS00000BSBM0LBMS020
	1	1/2	1	K9YCSCS00000CSAM0LAMCS000	K9YCSCS00000CSAM0LAMCS020
	1	3/4	1	K9YCSCS00000CSBM0LBMCS000	K9YCSCS00000CSBM0LBMCS020
	1	1	1	K9YCSCS00000CSCM0LCMCS000	K9YCSCS00000CSCM0LCMCS020
	1 1/4	1 1/4	1 1/4	K9YDSDS00000DSDM0LDMDS000	K9YDSDS00000DSDM0LDMDS020
	1 1/2	1 1/2	1 1/2	K9YESES00000ESEM0LEMES000	K9YESES00000ESEM0LEMES020
78Y Fem x Fem, 78U Fem x Male Union, 78BL Male Union x Fem without hoses	2	2	2	K9YFDFS00000FSFM0LFMFS000	K9YFDFS00000FSFM0LFMFS020
	1/2	1/2	1/2	K9YAFAF00000AFAM0LAMA000	K9YAFAF00000AFAM0LAMA020
	3/4	1/2	3/4	K9YBFBF00000BFAM0LAMB000	K9YBFBF00000BFAM0LAMB020
	3/4	3/4	3/4	K9YBFBF00000BFBM0LBMB000	K9YBFBF00000BFBM0LBMB020
	1	1/2	1	K9YCFCF00000CFAM0LAMCF000	K9YCFCF00000CFAM0LAMCF020
	1	3/4	1	K9YCFCF00000CFBM0LBMCF000	K9YCFCF00000CFBM0LBMCF020
	1	1	1	K9YCFCF00000CFM0LCMCF000	K9YCFCF00000CFM0LCMCF020
	1 1/4	1 1/4	1 1/4	K9YDFDF00000DFDM0LDMDF000	K9YDFDF00000DFDM0LDMDF020
78Y Fem x Fem w/ 2' Male x Male Union Hose, 78U Fem x Male Union w/ 2' Male x Male Union Hose, 78BL Male Union x Fem	1 1/2	1 1/2	1 1/2	K9YEFEF00000EFEM0LEMEF000	K9YEFEF00000EFEM0LEMEF020
	2	2	2	K9YFFFF00000FFFM0LFMFF000	K9YFFFF00000FFFM0LFMFF020
	1/2	1/2	1/2	K9YAFAF0AEAEAFAM0LAMA000	K9YAFAF0AEAEAFAM0LAMA020
	3/4	1/2	3/4	K9YBFBF0BEBEBFAM0LAMB000	K9YBFBF0BEBEBFAM0LAMB020
	3/4	3/4	3/4	K9YBFBF0BEBEBFAM0LBMB000	K9YBFBF0BEBEBFAM0LBMB020
	1	1/2	1	K9YCFCF0CECECFAM0LAMCF000	K9YCFCF0CECECFAM0LAMCF020
	1	3/4	1	K9YCFCF0CECECFBM0LBMCF000	K9YCFCF0CECECFBM0LBMCF020
	1	1	1	K9YCFCF0CECECFM0LCMCF000	K9YCFCF0CECECFM0LCMCF020
1 1/4	1 1/4	1 1/4	K9YDFDF0DEDEDFDM0LDMDF000	K9YDFDF0DEDEDFDM0LDMDF020	
1 1/2	1 1/2	1 1/2	K9YEFEF0EEEEEFEM0LEMEF000	K9YEFEF0EEEEEFEM0LEMEF020	
2	2	2	K9YFFFF0FEFEFFM0LFMFF000	K9YFFFF0FEFEFFM0LFMFF020	

5.2 PART CODES (CONTINUED)

Kit Description	Nominal Kit Size	Expected Control Valve Size (Series 78U Outlet Size)	Balancing Valve Size	With Customer-Supplied ATC	
				Without PT Ports and Handle Extensions	With PT Ports and Handle Extensions
				Victaulic Figure String	
78Y Sweat x Sweat, 78U Sweat x Male Union, 78BL Male Union x Sweat without hoses	1/2	1/2	1/2	KVYASAS00000ASAM0LAMAS000	KVYASAS00000ASAM0LAMAS020
	3/4	1/2	3/4	KVYBSBS00000BSAM0LAMBS000	KVYBSBS00000BSAM0LAMBS020
	3/4	3/4	3/4	KVYBSBS00000BSBM0LBMS000	KVYBSBS00000BSBM0LBMS020
	1	1/2	1	KVYCSCS00000CSAM0LAMCS000	KVYCSCS00000CSAM0LAMCS020
	1	3/4	1	KVYCSCS00000CSBM0LBMCS000	KVYCSCS00000CSBM0LBMCS020
	1	1	1	KVYCSCS00000CSCM0LCMCS000	KVYCSCS00000CSCM0LCMCS020
	1 1/4	1 1/4	1 1/4	KVYDSDS00000DSDM0LDMDS000	KVYDSDS00000DSDM0LDMDS020
	1 1/2	1 1/2	1 1/2	KVYESES00000ESEM0LEMES000	KVYESES00000ESEM0LEMES020
2	2	2	KVYFDFS00000FSFM0LFMFS000	KVYFDFS00000FSFM0LFMFS020	
78Y Fem x Fem, 78U Fem x Male Union, 78BL Male Union x Fem without hoses	1/2	1/2	1/2	KVYAFAF00000AFAM0LAMAF000	KVYAFAF00000AFAM0LAMAF020
	3/4	1/2	3/4	KVYBFBF00000BFAM0LAMB000	KVYBFBF00000BFAM0LAMB020
	3/4	3/4	3/4	KVYBFBF00000BFBM0LBMB000	KVYBFBF00000BFBM0LBMB020
	1	1/2	1	KVYCFCF00000CFAM0LAMCF000	KVYCFCF00000CFAM0LAMCF020
	1	3/4	1	KVYCFCF00000CFBM0LBMC000	KVYCFCF00000CFBM0LBMC020
	1	1	1	KVYCFCF00000CFCM0LCMCF000	KVYCFCF00000CFCM0LCMCF020
	1 1/4	1 1/4	1 1/4	KVYDFDF00000DFDM0LDMDF000	KVYDFDF00000DFDM0LDMDF020
	1 1/2	1 1/2	1 1/2	KVYEFEF00000EFEM0LEMEF000	KVYEFEF00000EFEM0LEMEF020
2	2	2	KVYFFFF00000FFFM0LFMFF000	KVYFFFF00000FFFM0LFMFF020	
78Y Fem x Fem w/ 2' Male x Male Union Hose, 78U Fem x Male Union w/ 2' Male x Male Union Hose, 78BL Male Union x Fem	1/2	1/2	1/2	KVYAFAF0AEAEAFAM0LAMAF000	KVYAFAF0AEAEAFAM0LAMAF020
	3/4	1/2	3/4	KVYBFBF0BEBEBFAM0LAMB000	KVYBFBF0BEBEBFAM0LAMB020
	3/4	3/4	3/4	KVYBFBF0BEBEBFBM0LBMB000	KVYBFBF0BEBEBFBM0LBMB020
	1	1/2	1	KVYCFCF0CECECFAM0LAMCF000	KVYCFCF0CECECFAM0LAMCF020
	1	3/4	1	KVYCFCF0CECECFBM0LBMC000	KVYCFCF0CECECFBM0LBMC020
	1	1	1	KVYCFCF0CECECFCM0LCMCF000	KVYCFCF0CECECFCM0LCMCF020
	1 1/4	1 1/4	1 1/4	KVYDFDF0DEDEDFDM0LDMDF000	KVYDFDF0DEDEDFDM0LDMDF020
	1 1/2	1 1/2	1 1/2	KVYEFEF0EEEEEFEM0LEMEF000	KVYEFEF0EEEEEFEM0LEMEF020
2	2	2	KVYFFFF0FEFEFFFM0LFMFF000	KVYFFFF0FEFEFFFM0LFMFF020	

6.0 NOTIFICATIONS

⚠ WARNING



- Read and understand all instructions before attempting to install, remove, adjust, or maintain any Victaulic piping products.
- Depressurize and drain the piping system before attempting to install, remove, adjust, or maintain any Victaulic piping products.
- Wear safety glasses, hardhat, and foot protection.

Failure to follow these instructions could result in death or serious personal injury and property damage.

7.0 REFERENCE MATERIALS

[08.50: Victaulic Balancing Ball Valve TA Series 78BL](#)

[I-KOIL-KIT: Victaulic KOIL-KIT™ Coil Pack Installation and Maintenance Instructions](#)

User Responsibility for Product Selection and Suitability

Each user bears final responsibility for making a determination as to the suitability of Victaulic products for a particular end-use application, in accordance with industry standards and project specifications, and the applicable building codes and related regulations as well as Victaulic performance, maintenance, safety, and warning instructions. Nothing in this or any other document, nor any verbal recommendation, advice, or opinion from any Victaulic employee, shall be deemed to alter, vary, supersede, or waive any provision of Victaulic Company's standard conditions of sale, installation guide, or this disclaimer.

Intellectual Property Rights

No statement contained herein concerning a possible or suggested use of any material, product, service, or design is intended, or should be construed, to grant any license under any patent or other intellectual property right of Victaulic or any of its subsidiaries or affiliates covering such use or design, or as a recommendation for the use of such material, product, service, or design in the infringement of any patent or other intellectual property right. The terms "Patented" or "Patent Pending" refer to design or utility patents or patent applications for articles and/or methods of use in the United States and/or other countries.

Note

This product shall be manufactured by Victaulic or to Victaulic specifications. Victaulic recommends all products to be installed in accordance with current IMI TA installation/assembly instructions. Victaulic and IMI TA reserve the right to change product specifications, designs and standard equipment without notice and without incurring obligations.

Installation

Reference should always be made to the current IMI TA installation/assembly instructions for the product you are installing. For coupling and strainer installation, reference should always be made to the [I-100 Victaulic Field Installation Handbook](#) for the product you are installing. Handbooks are included with each shipment of Victaulic products for complete installation and assembly data, and are available in PDF format on our website at www.victaulic.com

Warranty

Refer to the Warranty section of the current Price List or contact Victaulic for details.

Trademarks

Victaulic and all other Victaulic marks are the trademarks or registered trademarks of Victaulic Company, and/or its affiliated entities, in the U.S. and/or other countries.