

REVISIONS					
REV	PCA	DATE	DESCRIPTION	INIT	APP'D
1		6/18/2012	RELEASED FOR PRODUCTION	BJO	CGM

### INSPECTION CRITERIA:

1. FINISH TO MEET ASME A112.18.1 SPECIFICATIONS.
2. DIMENSIONS ARE FOR REFERENCE ONLY.
3. PRODUCT TO INCLUDE A RUBBER WASHER.
4. PRODUCT TO BE PACKAGED IN A PLAIN WHITE BOX.
5. SEE PAGE 2 FOR CORRECT LABEL MARKINGS.

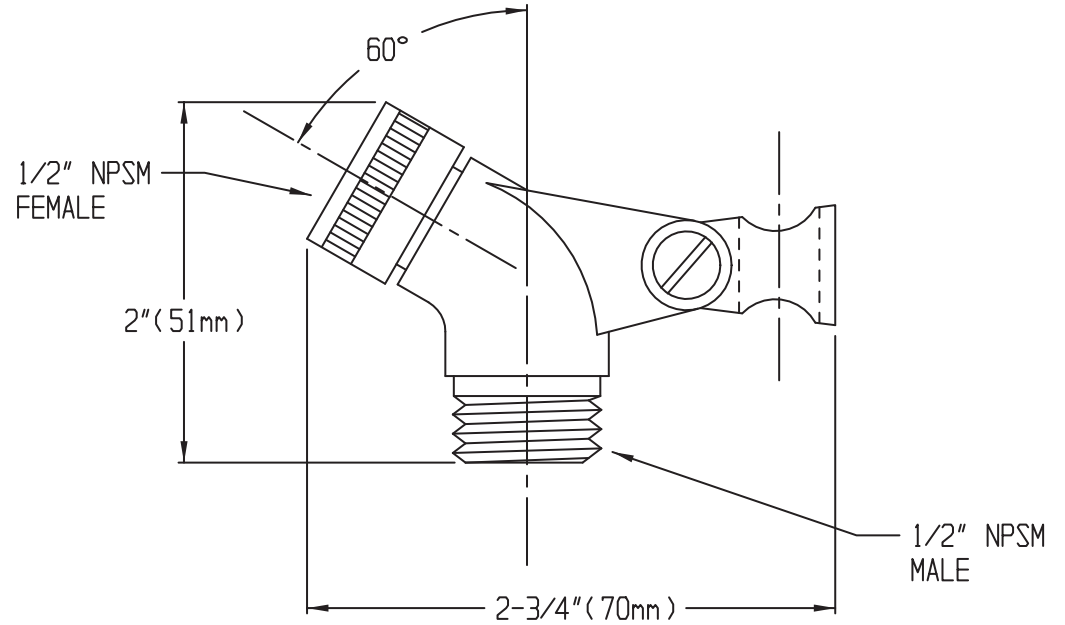

<b>TOLERANCE</b> UNLESS OTHERWISE SPEC'D X.X = ` .030" X.XX = ` .015" X.XXX = ` .005" FRACTIONAL = ` 1/64" ANGULAR = ` 1/2 ± CONC. WITHIN .006"		<b>SPEAKMAN COMPANY</b> WILMINGTON, DE			
		DRAWING TITLE			
		<b>INCOMING INSPECTION DRAWING FOR VS-120</b>			
DRAWN	CHK'D	SIZE	DWG NO.	REV	
BJO	CGM	A	VS-120	1	
DATE	APPRV'D	SCALE	SHEET		
6/18/2012	CGM	NTS	1 OF 2		

**SPEAKMAN**<sup>®</sup>  
WWW.SPEAKMANCOMPANY.COM

VS-120

**SWIVEL CONNECTOR**

WITH 1/2 IN. NPSM INLET & 1/2 IN. NPSF OUTLET



MODEL NO: VS-120  
FINISH: WHITE  
MADE IN CHINA



MFG.DATE

**SPEAKMAN**<sup>®</sup>  
WWW.SPEAKMANCOMPANY.COM

VS-120-PC

**SWIVEL CONNECTOR**

WITH 1/2 IN. NPSM INLET & 1/2 IN. NPSF OUTLET



MODEL NO: VS-120-PC  
FINISH: POLISHED CHROME  
MADE IN CHINA



MFG.DATE