

robern®

209-1100 CANDRE & METALLIQUE SCONCE INSTALLATION INSTRUCTIONS



General Notes

Install Instruction for Model Numbers:

- MLLWCDG Candre Sconce, Tinted Gray Mirror
- MLLWCDW Candre Sconce, White
- MLLWMDCR Metallique Sconce, Polished Chrome
- MLLWMDBN Metallique Sconce, Brushed Nickel

1. Unpack the light fixture. Check the box thoroughly for all hardware and loose parts as follows: A. Sconce Base B. Mounting Plate C. Hardware D. Sconce Shade
2. Fixture is rated for 26 W max, 4-pin Compact Fluorescent bulb, UL listed for damp locations.
3. Be sure you have all the contents listed above and in the **Parts List**.
4. Save these instructions for future use and reference. An improper installation voids the warranty. Installed sconces cannot be returned. If you experience any problems with your sconce, contact your dealer or Robern directly.

Limited Warranty — One Year Term (see page 3)

Parts List

A. Sconce Base

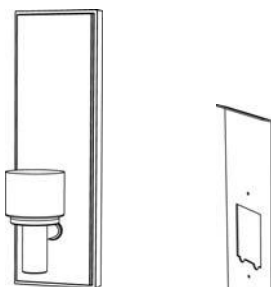

B. Mounting Plate

C. Hardware

1. Screws (2)

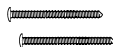

2. Hex Wrench



D. Sconce Shade



Cleaning and Care

NOTE: Under no circumstances should an ammonia-based cleaner be used on sconces.

When cleaning the mirrored-surface use only a lint-free polishing cloth for cleaning. To remove stubborn stains slightly dampen the cloth with water or rubbing alcohol.

When cleaning the metal frame use only a damp cloth.

NOTE: Do not use abrasive cleansers on any part of the sconce.

For grooming and task applications a 2700 K, 26 W bulb is recommended. An 18 W bulb can also be used.

Recommended replacement bulb options:

- Sylvania Dulux D/E CF26DD/E/827
- Philips PL-C CLuster 4-Pin PL-C 26W/827/4P/ALTO
- GE F26DBX/SPX827/4P

In case of a broken glass shade, contact Robern and reference part number X202-1081.

Installing the Sconce

1. Dimensions of Sconce

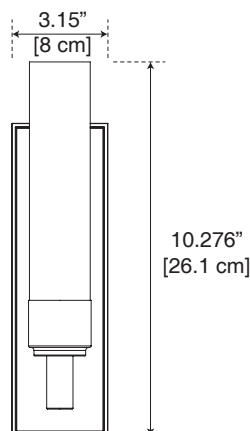

2. Selecting a Location

When Installing **209-1100 Candre or Metallique Sconces** with a **Robern M Series Cabinet** Install **CABINETS** at the following location:

■ For optimal installation with a **Robern MP cabinet**, with an overall height of 39-3/8" [100 cm], the cabinet should be installed with the lower edge at least 40" [102 cm] above the floor.

■ For optimal installation with a **Robern MT cabinet**, with an overall height of 30" [76.2 cm], the cabinet should be installed with the lower edge at least 45" [114.3 cm] above the floor.

NOTE: For a cabinet install, there must be at least a 1" [2.54 cm] clearance between the top of the faucet spout and the bottom of the cabinet door and at least 1" clearance from the top of the cabinet door to the ceiling.

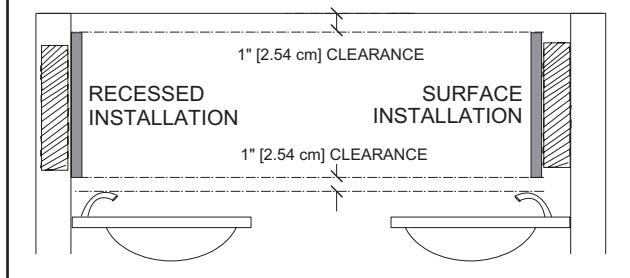

Suggested location for the junction box used with **209-1100 Candre or Metallique Sconces**:

■ Install only with a standard UL Listed junction box measuring 2-3/8" x 3-1/2" x 2-3/4" [6.03 cm x 8.89 cm x 6.98 cm] deep.

■ If installed with a Robern cabinet or mirror, the center of the junction box should be located 2" [5.08 cm] above the center of the cabinet or mirror (see Figure 1).

EXAMPLE: The suggested center of an installed Robern M Series Cabinet is 60" [152 cm] above the floor. Therefore the junction box location would be 62-1/2" [158.8 cm] above the floor.

■ If installed with a **Robern M Series Cabinet** the Sconces should be installed with a center to center distance of at least the width of the cabinet + 10" [25.4 cm] (see Figure 1).

EXAMPLE: If using lights with a Robern MP24 cabinet, the junction boxes would be located 24" + 10" = **30"** [61 cm x 25.4 cm x 76.2 cm] away from each other (see Figure 1).

NOTE: For existing mirrors or cabinets it is suggested that the junction boxes be located at least 30" [76.2 cm] apart and a minimum of 57-1/2" [146.1 cm] above the floor.

Figure 1

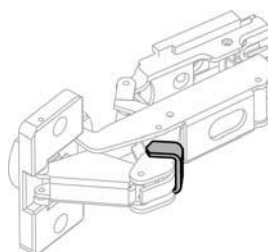
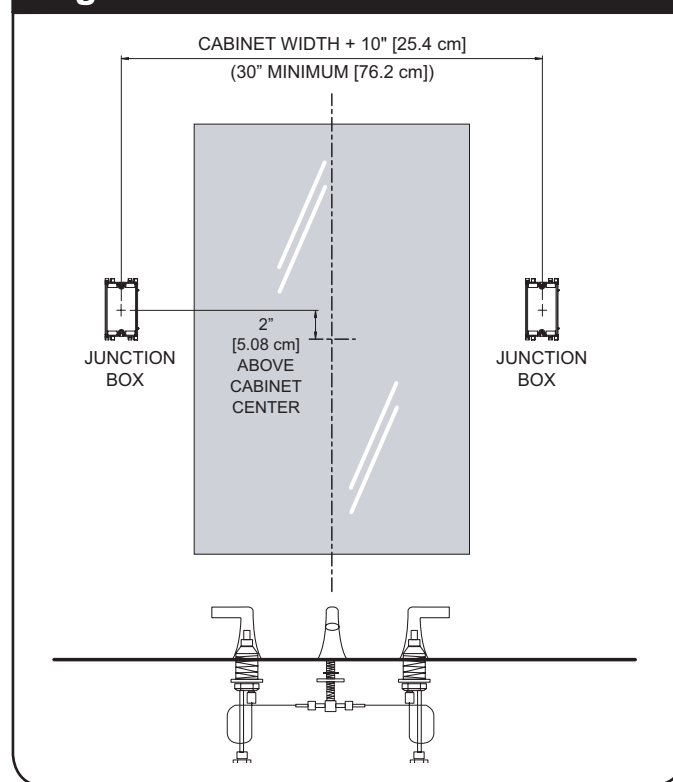

NOTE: To protect lights from damage, make sure to install **hinge clips** on Robern cabinets. This will insure that the cabinet door does not open more than 110 degrees.

2. Installation

1. Using the hex wrench, loosen set screw in the top of the sconce base and remove back plate.
2. Orient back plate as shown in Figure 2. Mount back plate to junction box using the two screws provided.
3. Connect field wires to wires on the sconce base through the open area in the back plate per electrical codes (see Figure 2).

Figure 2

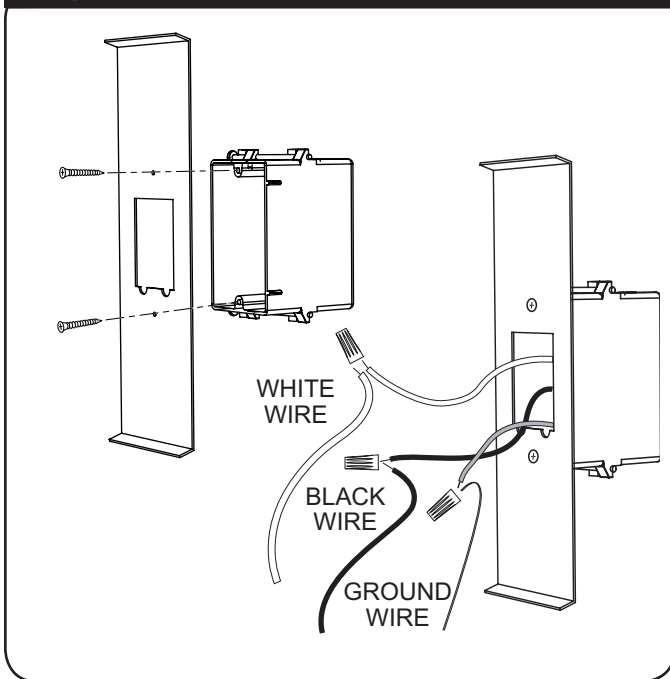

4. Place Sconce Base on Mounting Plate and tighten Set Screw with the hex wrench (see Figure 3).
5. Install recommended 26 W, 4-pin 2700 K Compact Fluorescent bulb (not included) into socket.
6. Place Glass Shade in fixture.

Figure 3

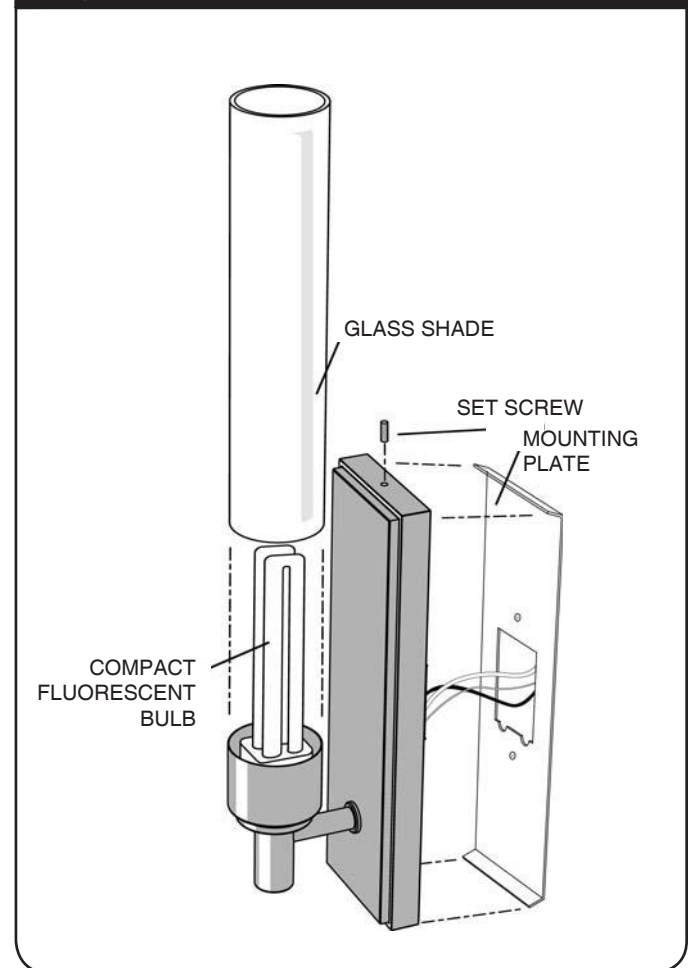

Limited Warranty One Year Term

ROBERN warrants to the original purchaser that, it will, at its election repair, replace, or make appropriate adjustment to products made by this company shown to have significant defects in material or workmanship which are reported to ROBERN in writing within one (1) year from the date of delivery. ROBERN is not responsible for installation costs.

The warranty is void in the event the product is damaged in transit, or if damage or failure is caused by abuse, misuse, abnormal usage, faulty installation, damage in an accident, improper maintenance, or any repairs other than those authorized by ROBERN. At the expiration of the one year warranty period, ROBERN shall be under no further obligation under any warranty, expressed or implied, including the implied warranty of merchantability.

ROBERN shall not be liable for any consequential damages arising out of or in connection with the use or performance of its products. Some states do not allow limitations on how long an implied warranty lasts or do not allow the exclusion or limitation of incidental or consequential damages, so the above limitation or exclusion may not apply to you.

Any liability against ROBERN under any implied warranty, including the warranty of merchantability, is expressly limited to the terms of this warranty. Permission to return any merchandise under this warranty must be authorized by ROBERN and returned prepaid by the purchaser. Claims under this warranty should be sent directly to your dealer.