

System Data Sheet

ProPress 316



ProPress 316 is a stainless steel system designed to be used with Viega 316 stainless steel tubing to form a complete press system that is ideal for process water and durable enough to handle industrial applications or environments. ProPress 316 fittings feature the same

EPDM sealing element found in ProPress copper fittings and provide the same permanent leak-free connections in dimensions from 1/2" to 4".

ProPress 316 fittings are offered in configurations including: elbows, couplings, reducers, tees, reducing tees, threaded adapters, unions, caps, and flanges. ProPress 316 fittings in 2 1/2" to 4" have a 420 stainless steel grip ring and a PBT separator ring in addition to the EPDM sealing element.

Operating Parameters

- Operating Pressure: 200 psi maximum
- Test Pressure: 600 psi maximum
- Operating Temperature: 0°F to 250°F

Listings and Certificates

- ABS
- ASME B31.1, B31.3, B31.9
- IAPMO PS-117
- ICC-ES LC1002

International Listings and Certificates

- BV: Bureau Veritas
- DNV GL: Det Norske Veritas Germanischer
- LR: Lloyd's Register
- NKK: Nippon Kaija Kyokai

Contact your local Viega representative for details on local approvals.

Compliant With

- ASME B31
- ASTM A312
- ASTM A403
- ASTM A554
- IAPMO Uniform Mechanical Code (UMC)
- ICC International Mechanical Code (IMC)

Approved Applications

- Hydronic heating (with glycol)
- Chilled water
- Low pressure steam (15 psi maximum)
- Isopropyl alcohol
- Latex Paint
- Phosphoric acid
- Compressed Air
- Non-medical gases
- Vacuum (29.2" Hg maximum @ 68°F)

ProPress 316 systems are approved for underground use. When installed underground, ProPress 316 fittings should have proper corrosion protection in accordance with local and national codes.

For more specific information on applications for ProPress 316, contact Viega Technical Services at 1-800-976-9819.

Smart Connect® Technology

ProPress 316 fittings are manufactured with Viega's patented Smart Connect technology. Designed into the fitting itself, Viega Smart Connect technology allows identification of an unpressed fitting during pressure testing.

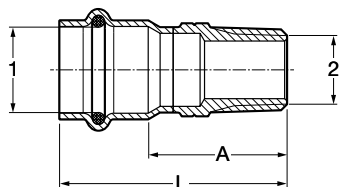
ProPress Stainless Adapter P x MPT - Models 6011 / 4011

Part No.		Size (in)		A (in)	L (in)
304	316	1	2		
85012	80010	1/2 x 1/2 MPT		1.37	2.11
85017	80015	1/2 x 3/4 MPT		1.44	2.19
85022	80020	3/4 x 1/2 MPT		1.42	2.32
85027	80025	3/4 x 3/4 MPT		1.46	2.36
85032	80030	3/4 x 1 MPT		1.71	2.62
85037	80035	1 x 3/4 MPT		1.47	2.37
85042	80040	1 x 1 MPT		1.74	2.65
85047	80045	1 1/4 x 1 1/4 MPT		1.89	2.92
85052	80050	1 1/2 x 1 1/2 MPT		1.94	3.37
85054	80055	2 x 2 MPT		2.10	3.68

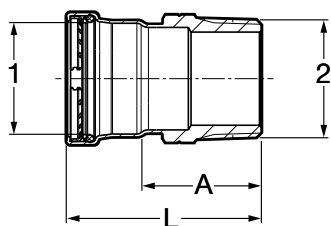
ProPress Stainless Adapter P x MPT - Models 6011XL / 4011XL

Part No.		Size (in)		A (in)	L (in)
304	316	1	2		
85062	80060	2 1/2 x 2 1/2 MPT		2.99	4.69
85067	80065	3 x 3 MPT		3.09	5.06
85072	80070	4 x 4 MPT		3.13	5.49

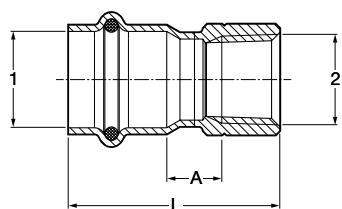
ProPress Stainless Adapter P x FPT - Models 6012 / 4012

Part No.		Size (in)		A (in)	L (in)
304	316	1	2		
85082	80080	1/2 x 1/2 FPT		0.54	1.82
85087	80085	3/4 x 1/2 FPT		0.51	1.95
85096	80090	3/4 x 3/4 FPT		0.57	2.03
85094	80092	1 x 1/2 FPT		0.62	2.06
85097	80095	1 x 3/4 FPT		0.62	2.08
85128	80100	1 x 1 FPT		0.61	2.18
85107	80105	1 1/4 x 1 1/4 FPT		0.62	2.33
NA	80110	1 1/2 x 1 1/4 FPT		0.69	2.80
85117	80115	1 1/2 x 1 1/2 FPT		0.69	2.80
85077	80075	2 x 1 FPT		0.75	2.99
85122	80120	2 x 1 1/2 FPT		0.73	2.99
85127	80125	2 x 2 FPT		0.71	2.99

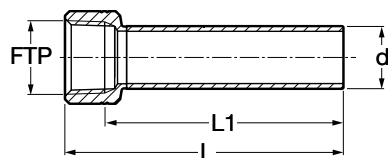
ProPress 316 Instrument Adapter - Model 4012.5

Part No.	Size (in)	L (in)	L1 (in)
316	FPT x FTG (d)		
80126	1/2 x 1/2	4.06	3.52
80127	3/4 x 3/4	3.94	3.38