

INSTALLATION INSTRUCTIONS

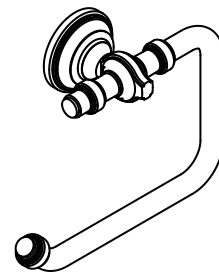
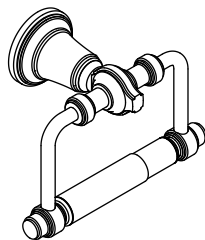
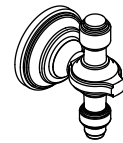
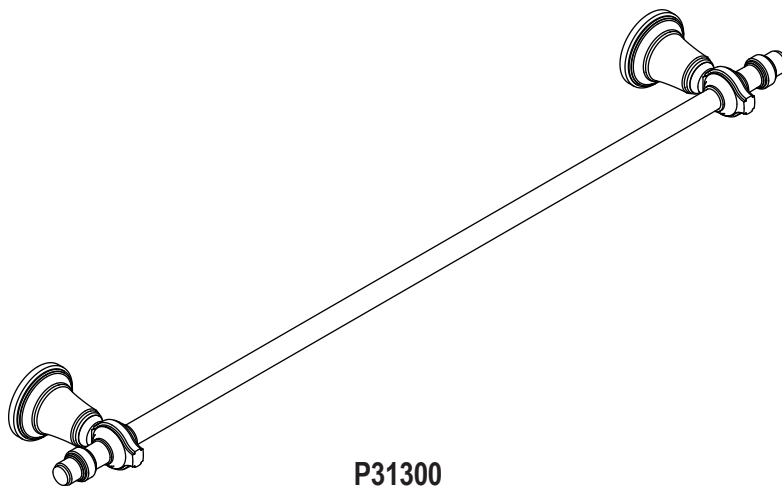

INSTALLATION INSTRUCTIONS

THANK YOU FOR CHOOSING KALLISTA

We appreciate your commitment to Kallista quality products. Please take a moment to review this manual before you install your Kallista product. If you encounter any installation or performance problems, please do not hesitate to contact us at the phone number listed at the bottom of the page.

BEFORE YOU BEGIN

 **DANGER: Risk of personal injury.** These products are not designed or intended for use as a grab bar or support bar. Do not install any of these products in any area where they are likely to be used inadvertently as a grab bar or support bar.

IMPORTANT! Do not overtighten the setscrew(s). Overtightening can damage the accessory.

- ☐ These products should be located and mounted to a wall stud.
- ☐ While it is possible to mount them to any surface, a stud mounted product will yield the best results.
- ☐ Use a level to ensure that the center lines for the wall plates are vertical where applicable and the post center lines are horizontal where applicable.
- ☐ Kallista reserves the right to make revisions in the design of products without notice, as specified in the Price Book.

TOOLS AND MATERIALS

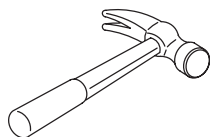

Claw
Hammer



Pencil



Assorted
Screwdrivers



Drill



Level



Measuring Tape



Assorted
Hex Wrenches

Plus:

- Assorted Drill Bits

Assorted woodworking tools may be needed to finish the wall.

INSTALLATION INSTRUCTIONS

ROUGHING-IN INFORMATION

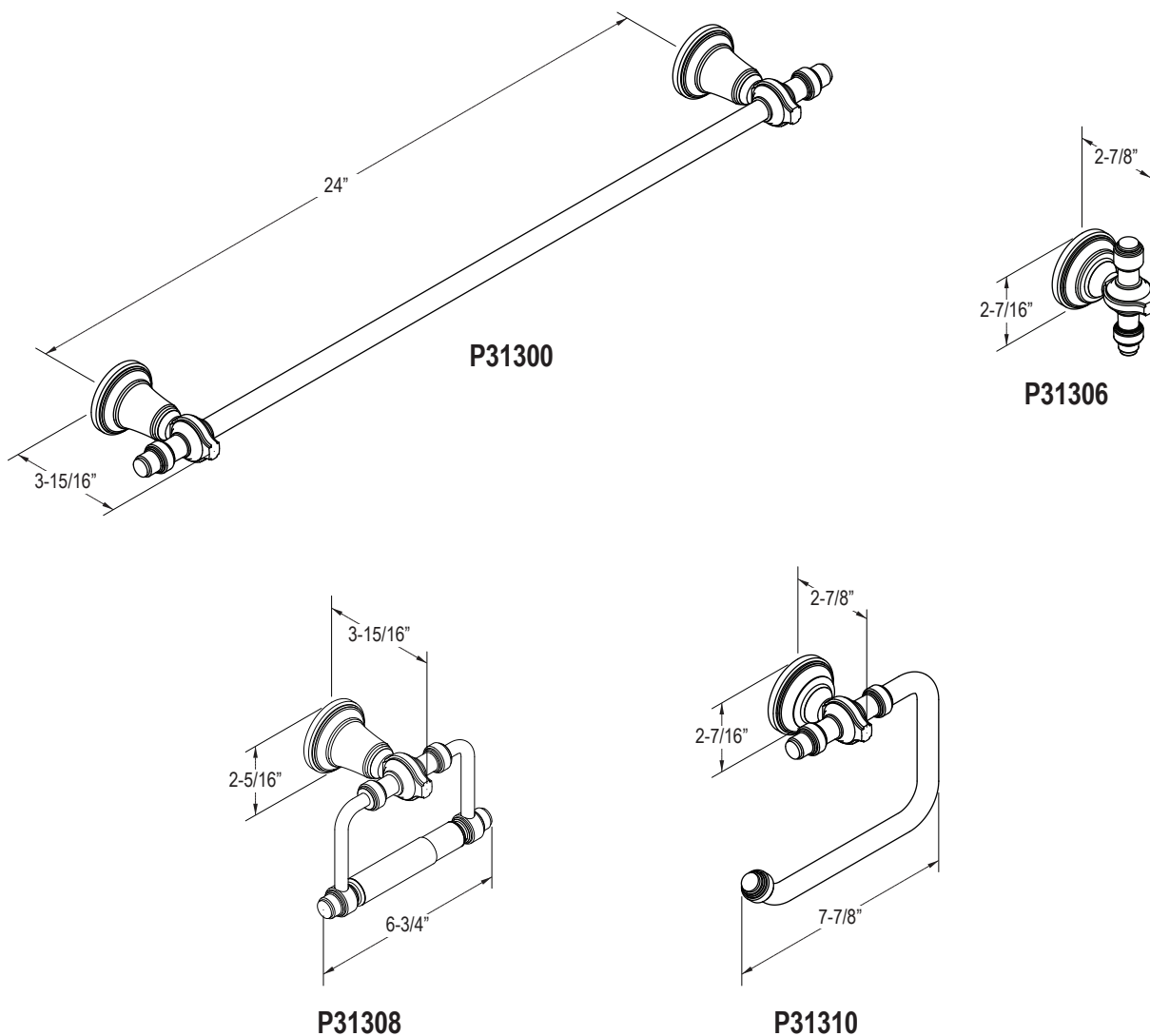

1. PREPARE THE SITE

IMPORTANT! Be sure all center points are level before drilling. There is no provision for later adjustment if the center points and resulting pilot holes are not level.

For Multiple-Post Accessories

NOTE: Take into account the length of the accessory components to determine the required distance between the post center points.

- ☐ Consult the "Roughing-In Information" section for dimensions.

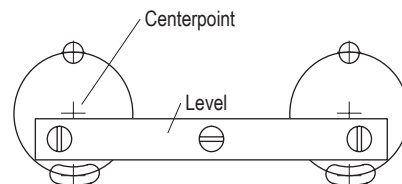
Locate the Wall Plate

For multiple-post layout only.

INSTALLATION INSTRUCTIONS

1. PREPARE THE SITE (CONT'D)

- ☐ Mark the vertical and horizontal center lines for each post. Use a level to ensure that all center points are level.
- ☐ Horizontally align and mark the holes of each wall plate. Set the wall plate aside.

For Single-Post Accessories

- ☐ Mark the vertical and horizontal center lines for the post. Consult the "Roughing-In Information" section for dimensions.
- ☐ Horizontally align and mark the holes of the wall plate. Set the wall plate aside.

For All Accessories

- ☐ Select a drill and 5/16" drill bit appropriate for the wall material you will be drilling through.
- ☐ Carefully drill a 5/16" hole at all marked pilot hole locations

Wall Bracket Hole Locations

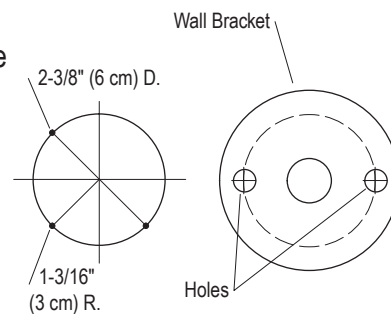

2. INSTALL THE WALL PLATE

NOTE: You may need to disassemble some of the accessories. Some accessories will be packed with the wall plate installed in the post.

- ☐ Loosen the setscrew and remove the wall plate if needed.
- ☐ In Wall
- ☐ Plate AnchorsMounting
- ☐ Holes ScrewsInstall the Wall Plate sert the wall anchor legs into the hole. Insert all wall anchors into the pre-drilled mounting holes.
- ☐ Carefully tap each wall anchor into the finished surface until flush.
- ☐ Horizontally align the mounting holes on the wall plate with the installed anchors, as shown.
- ☐ Secure the wall plate with the supplied screws.
- ☐ Repeat this procedure at each wall plate location.

Install the Wall Plate

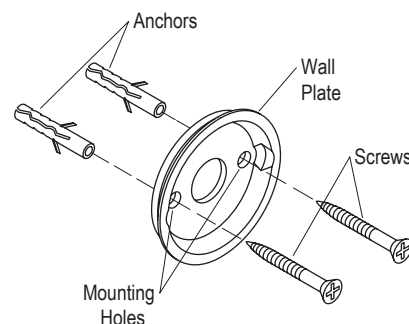

INSTALLATION INSTRUCTIONS

3. INSTALL THE TOWEL BAR

- ☐ Partially thread a setscrew into each escutcheon.
- ☐ Place the towel bar assembly onto the wall plates.
- ☐ Tighten the setscrews. Do not over-tighten.

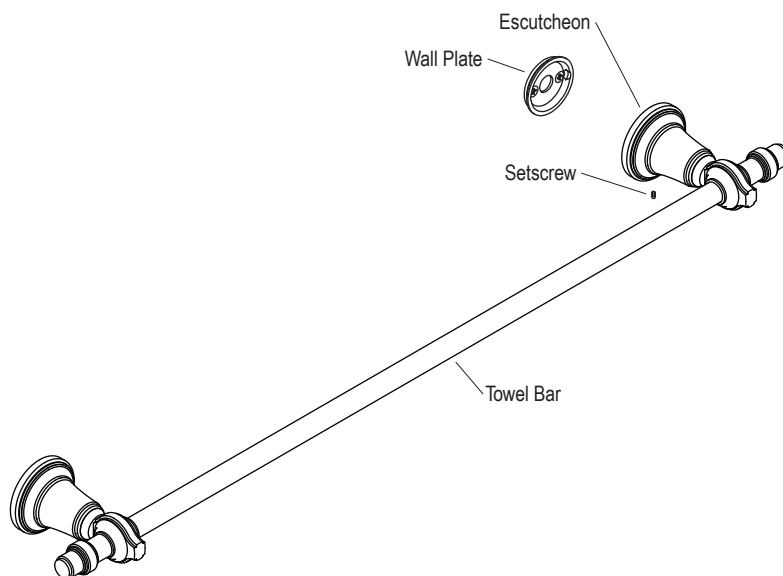

4. INSTALL THE TOWEL RING

- ☐ Partially thread the setscrew into the escutcheon.
- ☐ Align the towel ring assembly over the wall plate.
- ☐ Tighten the setscrew. Do not overtighten.

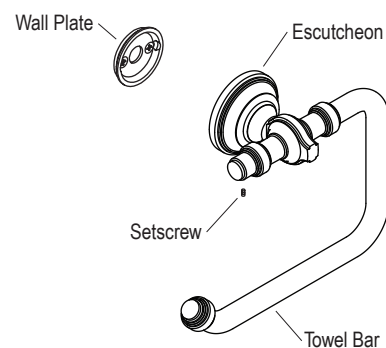

5. INSTALL THE TISSUE HOLDER

- ☐ Partially thread the setscrew into the escutcheon.
- ☐ Align the tissue holder assembly over the wall plate.
- ☐ Tighten the setscrew. Do not overtighten.

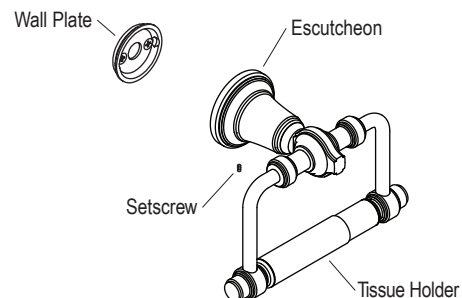

INSTALLATION INSTRUCTIONS

6. INSTALL THE ROBE HOOK

- ☐ Partially thread the setscrew into the escutcheon.
- ☐ Align the robe hook assembly over the wall plate.
- ☐ Tighten the setscrew. Do not overtighten.

