

Strong Back RC Series Repair Couplings

Designed for resistance to heavy earth loads and shear forces and provides improved pipe alignment.

Strong Back RC Couplings offer a .012" stainless steel shield and a molded in bushing.



TECHNICAL SPECS & CODE APPROVALS

Gasket

- Manufactured to meet the material requirements of:
 - CSA B602 - mechanical couplings for drain, waste, vent pipe and sewer pipe
 - ASTM D 5926 - Standard Specification for Poly Vinyl Chloride (PVC) Gaskets for Drain, Waste, and Vent (DWV), Sewer, Sanitary, and Storm Plumbing Systems
 - ASTM C 1173 - Standard Specification for Flexible Transition Couplings for Underground Piping Systems
- Hardness, Shore "A", Inst. +5.....65
- Tensile Strength, Min. psi 1000
- Elongation at Rupture, Min. %.....250
- Tear Strength, Min.....150 lb/in.
- Brittleness Temperature.....-40°F

Clamps

- Clamp Housing- 301 Stainless Steel
- Clamp Band - 301 Stainless Steel
- Clamp Screw - 305 Stainless Steel
- Installation torque 60" lbs

Shear Ring

- .012" Thick, 300 Series Stainless Steel
- Width manufactured according to coupling width (1.50", 2.13", or 4")
- Length manufactured according to coupling diameter
- Clamps spot welded in place

Coupling

- Manufactured to conform to the performance requirements of:
 - ASTM C 1173 - standard specification for flexible transition couplings for underground piping systems



This product can be custom ordered for ANY common sewer pipe size and material combination.

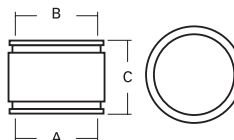

Part numbers on the next page...

Strong Back RC Couplings - RC Series Repair Couplings



1051 RC Series - Asbestos Cement Fibre (AC) or Ductile Iron to Cast Iron or Plastic

Part No.	A		B		C	
	in.	mm	in.	mm	in.	mm
1051-44RC*	4.80	122	4.39	112	3.94	100
1051-45RC	5.00	127	5.52	140	3.97	101
1051-46RC*	4.75	121	6.60	168	5.74	146
1051-55RC	5.90	150	5.50	140	5.92	150
1051-64RC	6.95	177	4.38	111	5.92	150
1051-65RC	6.95	177	5.50	140	5.92	150
1051-66RC*	6.69	177	6.69	170	5.91	150
1051-8-10RC	9.05	230	10.63	270	5.89	150
1051-88RC*	9.25	235	8.51	216	5.97	152
1051-10-8RC	11.02	280	8.38	213	5.97	152
1051-1212RC	13.37	340	12.60	320	5.97	152
1051-1818RC	19.74	501	19.74	501	9.89	251



1055 RC Series - AC or Ductile Iron to AC or Ductile Iron

Part No.	A		B		C	
	in.	mm	in.	mm	in.	mm
1055-44RC	4.75	121	4.75	121	3.96	101
1055-66RC	6.65	169	6.65	169	5.92	150
1055-88RC	9.05	230	9.05	230	5.98	152
1055-1010RC	11.22	285	11.22	285	5.97	152
1055-1212RC	13.37	340	13.37	340	5.97	152



1056 RC Series - CI, PL, Copper, ST or Lead to CI, PL, Copper, ST or Lead

Part No.	A		B		C	
	in.	mm	in.	mm	in.	mm
1056-150RC	1.94	49	1.94	49	3.43	87
1056-22RC	2.41	61	2.41	61	3.45	88
1056-32RC	3.52	89	2.38	60	3.96	101
1056-33RC	3.46	88	3.46	88	3.98	101
1056-43RC	4.58	116	3.38	86	4.02	102
1056-44RC	4.58	116	4.58	116	4.02	102
1056-54RC	5.52	140	4.38	111	3.97	101
1056-55RC	5.52	140	5.52	140	3.97	101
1056-64RC*	6.60	168	4.50	114	5.74	146
1056-65RC	6.60	168	5.62	143	5.74	146
1056-66RC	6.60	168	6.60	168	5.74	146
1056-86RC	8.64	219	6.63	162	6.04	153
1056-88RC	8.64	219	8.64	219	6.04	153
1056-1010RC	10.63	270	10.63	270	5.89	150
1056-1212RC	12.52	318	12.52	318	6.32	161
1056-1515RC	15.92	404	15.92	404	9.89	251
1056-1818RC	19.10	485	19.10	485	9.89	251

SHIELDED COUPLINGS



This product can be custom ordered for ANY common sewer pipe size and material combination.

*Designated part numbers come with an insert bushing.

