

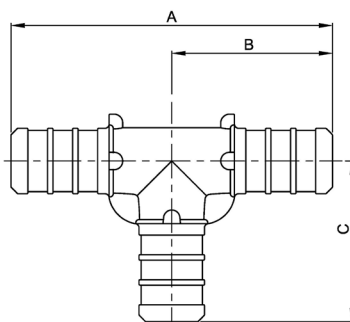

## F2159 POLY PEX TEE

- Simple and dependable plumbing connection
- Easy installation
- Leak-proof connections
- Polymer construction
- Manufactured of premium-grade resin with non-mixed blends
- Can be used with brass PEX crimp rings or stainless steel PEX clamps
- Certified to ASTM F2159-2014 and CSA B137.5-2013
- Certified to ASTM F877-2020 and CSA B137.5-2020
- Certified to NSF/ANSI 14-2015, NSF/ANSI 14-2016a, and NSF/ANSI 372-2011
- Certified to NSF/ANSI/CAN 61-2018
- cUPC listed



Part No.	Description	Color	A - in (mm)	B - in (mm)	C - in (mm)	Weight-lbs (grams)
C76700	1/2" F2159	White	2.32 (59.00)	1.16 (29.50)	1.16 (29.50)	0.01 (6.30)
C76762	1/2" F2159	Black	2.32 (59.00)	1.16 (29.50)	1.16 (29.50)	0.01 (6.30)
C76701	3/4" F2159	White	2.52 (64.00)	1.26 (32.00)	1.26 (32.00)	0.03 (14.00)
C76763	3/4" F2159	Black	2.52 (64.00)	1.26 (32.00)	1.26 (32.00)	0.03 (14.00)
C76773	1" F2159	Black	3.05 (77.50)	1.53 (38.75)	1.53 (38.75)	0.06 (25.90)

F2159 Specified Dimensions	ID - in (mm)	OD - in (mm)
1/2" End Connection	.37(9.30)	.47(11.98)
3/4" End Connection	.55(13.85)	.67(16.96)
1" End Connection	.72(18.22)	.86(21.74)